



16 Gilderdale, Luton, LU4 9NB

Available to rent is this well presented one bedroom cluster home situated in the popular Gilderdale area of Luton.

The property is offered in good condition throughout and benefits from a spacious lounge, providing a comfortable living space ideal for relaxing and entertaining. The fitted kitchen is well maintained and offers practical storage and workspace.

To the first floor, the property comprises a generous double bedroom and a modern bathroom suite. The accommodation is bright, well-proportioned, and ideally suited to a single professional or couple.

Further benefits include allocated parking and a convenient location close to local amenities, transport links including Luton Leagrave Train Station.

Early viewing is highly recommended.

£1,050 Per month

- Nova Estate Agents
- Cluster House
- Good Condition Throughout
- Allocated Parking
- Close To Transport links
- Press Play Button For 360° Walkaround Tour

Approx Gross Internal Area
40 sq m / 430 sq ft

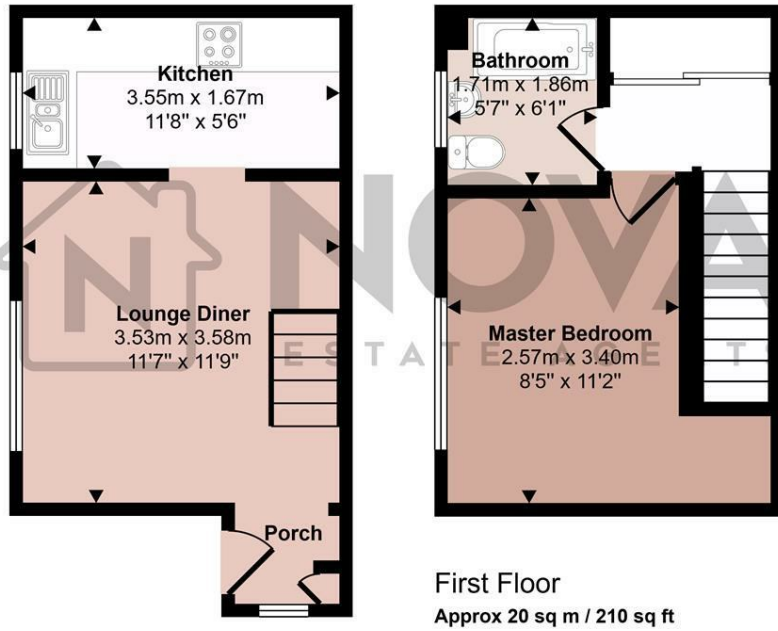

Ground Floor
Approx 20 sq m / 220 sq ft

First Floor
Approx 20 sq m / 210 sq ft

This floorplan is only for illustrative purposes and is not to scale. Measurements of rooms, doors, windows, and any items are approximate and no responsibility is taken for any error, omission or mis-statement. Icons of items such as bathroom suites are representations only and may not look like the real items. Made with Made Snappy 360.

Energy Efficiency Rating		Current	Potential
Very energy efficient - lower running costs			
(92 plus) A			96
(81-91) B			
(69-80) C		69	
(55-68) D			
(39-54) E			
(21-38) F			
(1-20) G			
Not energy efficient - higher running costs			
England & Wales		EU Directive 2002/91/EC	