



HOMES BY VICTORIA  
ESTATE AGENCY

## Counting House Way, Stoke Heath, Bromsgrove, B60 3QD

Offers Over £350,000



This well presented three-bedroom detached family home is ideally situated within the highly sought-after area of Bromsgrove, offering generous living space and a well-balanced layout, perfect for modern family life

[homesbyvictoria.co.uk](https://www.homesbyvictoria.co.uk)

[victoria@homesbyvictoria](mailto:victoria@homesbyvictoria) | 07833 136521

FOR M HOMES MIDLANDS LIMITED trading as Homes By Victoria Company Number: 13688840 VAT no: 470190115



HOMES BY VICTORIA  
ESTATE AGENCY



## Key Features

- LOCATED IN THE POPULAR AREA OF BROMSGROVE
- OFFERED TO THE MARKET CHAIN FREE
- LOUNGE THROUGH DINER
- DOWNSTAIRS WC
- FAMILY BATHROOM
- DETACHED FAMILY HOME
- KITCHEN AND SEPERATE UTILITY SPACE
- CONSERVATORY
- THREE BEDROOMS
- OFF ROAD PARKING AND SINGLE GARAGE

Approx Gross Internal Area  
103 sq m / 1107 sq ft

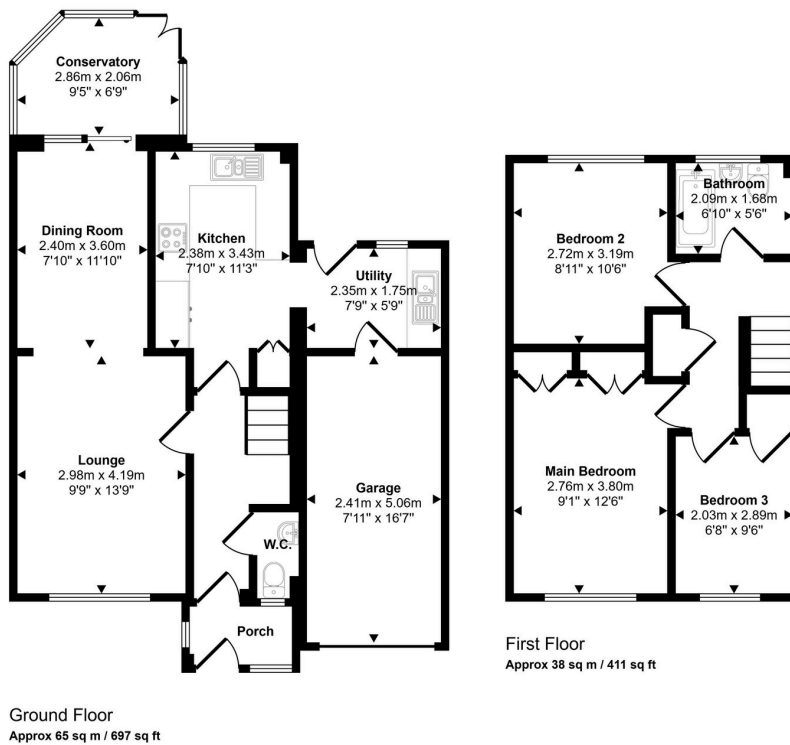

This floorplan is only for illustrative purposes and is not to scale. Measurements of rooms, doors, windows, and any items are approximate and no responsibility is taken for any error, omission or mis-statement. Icons of items such as bathroom suites are representations only and may not look like the real items. Made with Made Snappy 360.