

GROUND FLOOR  
363 sq.ft. (33.7 sq.m.) approx.

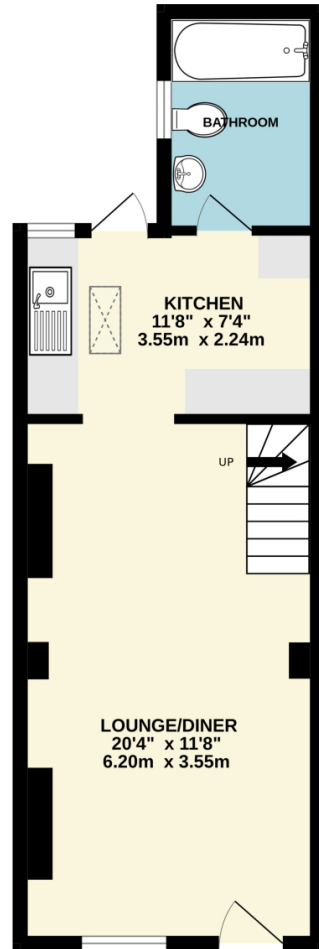

1ST FLOOR  
237 sq.ft. (22.0 sq.m.) approx.

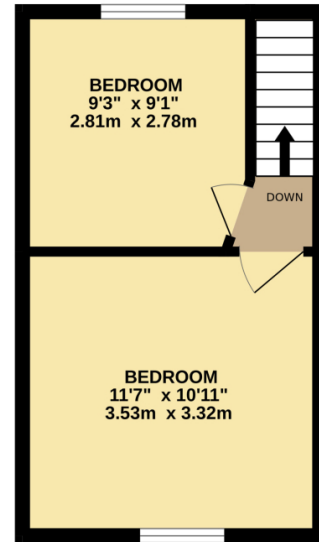

NO PHOTO



## Great Queen Street, Dartford, DA1

Ideally located for Dartford Station and town centre is this two bedroom terraced house that would make an ideal first home or investment property. The property requires some TLC and has a through lounge with a fitted kitchen. There is a ground floor bathroom and to the first floor there are two bedrooms. To the rear is a good size garden with a paved area that offers a great deal of potential to someone with green fingers. Offered chain free and keenly priced this property should be viewed at your first opportunity.

TOTAL FLOOR AREA : 600 sq.ft. (55.7 sq.m.) approx.  
Whilst every attempt has been made to ensure the accuracy of the floorplan contained here, measurements of doors, windows, rooms and any other items are approximate and no responsibility is taken for any error, omission or mis-statement. This plan is for illustrative purposes only and should be used as such by any prospective purchaser. The services, systems and appliances shown have not been tested and no guarantee as to their operability or efficiency can be given.  
Made with Metropix ©2026

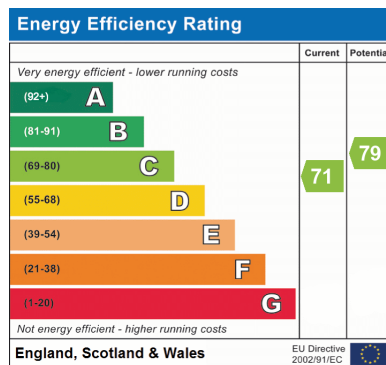

Address: Dartford, DA1

**Guide price £250,000**



AJR Property  
2 Bellegrove Road, Welling DA16 3PR  
T: +442083040666 | E: hello@ajrproperty.com  
<http://www.ajrproperty.com/>

AJR Property  
2 Bellegrove Road, Welling DA16 3PR  
T: +442083040666 | E: hello@ajrproperty.com  
<http://www.ajrproperty.com/>



## Features

- Two bed terrace house
- CHAIN FREE
- Good size lounge
- Two double bedrooms
- Good sized rear garden
- Close to Dartford station
- Close to Dartford town centre
- Close to local school and Grammar school
- EPC C71