



## 667 Lower Rainham Road

, ME8 7TY

Offers in excess of £600,000



Set along the ever-popular Lower Rainham Road, this characterful detached home offers an impressive blend of space, history and modern comfort. Once the foreman's house for the local Cement works, and later home to an engineer with a passion for steam engines, it carries a unique story that adds real charm to its already generous footprint.

The property welcomes you with a large driveway and a double garage, giving excellent parking and storage options. Inside, the layout flows beautifully, offering a choice of reception spaces that suit both busy family life and quieter moments. Natural light fills the rooms, creating a warm and inviting atmosphere throughout, while the flexible arrangement of four bedrooms one with an adjoining loft room provides plenty of room for growing families, home working or guest accommodation.

The stunning kitchen sits at the heart of the home, opening onto the garden and offering a sociable space for cooking and gathering. Additional reception rooms, including a family room and playroom, give everyone their own corner to enjoy.

The rear garden is a standout feature. Thoughtfully landscaped and well maintained, it offers a peaceful retreat with established planting, a generous lawn and a smart seating area perfect for outdoor dining or simply unwinding at the end of the day.

Homes of this scale and character are rarely available in this part of Rainham. With its rich heritage, spacious interior and beautifully kept garden, this is a property that truly offers something special for those seeking a long-term family home in a well-connected and desirable location. Offered with NO ONWARD CHAIN.



### Door to

### Hallway

### WC

4'5 x 3'2 (1.35m x 0.97m)

### Office/Playroom

9'4 x 9'4 (2.84m x 2.84m)

### Family Room/Bedroom

12'4 x 10'2 (3.76m x 3.10m)

### Snug

12'8 x 9,9 max (3.86m x 2.74m,2.74m max)

### Lounge

14'2 x 11'1 (4.32m x 3.38m)

### Kitchen/Diner

25'5 x 8'9 min (7.75m x 2.67m min)

### Utility Room

9'2 x 5'4 (2.79m x 1.63m)

### Stairs From Hallway

### Landing

### Bedroom 1

13'0 x 11'8 min (3.96m x 3.56m min)

### Ensuite

9'1 x 4'8 (2.77m x 1.42m)

### Walk in Wardrobe

### Bedroom 2

10'6 x 8'5 min (3.20m x 2.57m min)

### Loft Room

10'9 x 8'2 (3.28m x 2.49m)

### Bedroom 3

9'2 x 8'4 (2.79m x 2.54m)

### Bedroom 4

8'9 x 7'1 max (2.67m x 2.16m max)

### Bathroom

9'1 x 5'8 max (2.77m x 1.73m max)

### Garden

52 x 52 apx (15.85m x 15.85m apx)

### Double Garage

18'8 x 18'6 (5.69m x 5.64m)

### Driveway for Multiple Cars

### Important Notice -

Pollard Estates, their clients and any joint agents state that these particulars are for guidance only and do not form part of any offer or contract.

No representation or warranty is given, and no employee has authority to do so.

Measurements, photographs and plans are approximate and for illustrative purposes only.

It should not be assumed that the property has all necessary planning, building regulation or other consents.

Services, appliances and systems have not been tested. Buyers must satisfy themselves by inspection or other means.

Tenure, ground rent, service charges and other leasehold details are provided by the seller and must be verified by a solicitor.

Any changes to charges or terms should be confirmed independently.

Purchasers will be required to provide identification under current Money Laundering Regulations before an offer can be accepted.

Personal data supplied during the enquiry or offer process will be handled in accordance with our privacy policy.

## Area Map



## Floor Plans

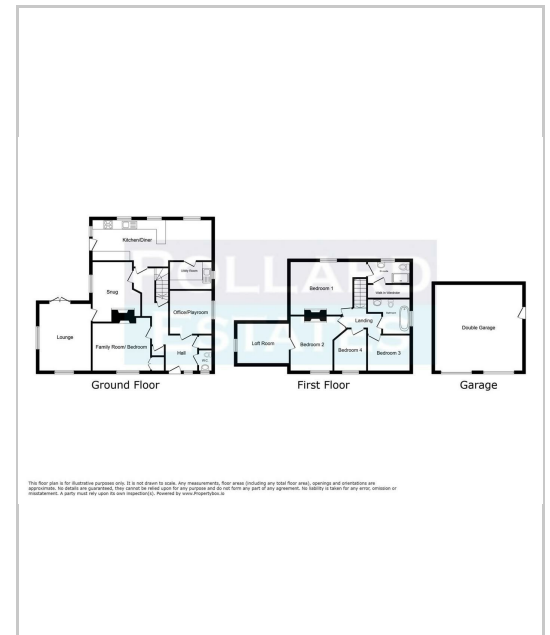

## Energy Efficiency Graph

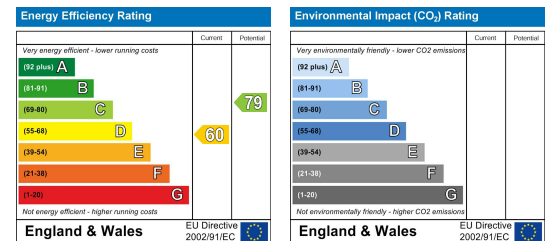

These particulars, whilst believed to be accurate are set out as a general outline only for guidance and do not constitute any part of an offer or contract. Intending purchasers should not rely on them as statements of representation of fact, but must satisfy themselves by inspection or otherwise as to their accuracy. No person in this firm's employment has the authority to make or give any representation or warranty in respect of the property.