



£190,000

Braemar Road, Forest Town,  
Mansfield,



Welcome to **BuckleyBrown**, where every home is carefully presented, so you can explore with clarity and confidence.

**BuckleyBrown**  
ESTATE AGENTS

"A standout three-bedroom semi on an exceptional plot, featuring a stunning kitchen diner, spacious family room, separate lounge and three generous bedrooms. The perfect family home with space inside and out."

Jasmine, Valuer



## AN ADDRESS TO IMPRESS

*Situated in the popular village of Forest Town, this beautifully presented three-bedroom semi-detached home offers the ideal blend of modern family living and generous outdoor space*

Occupying an exceptional plot, the property boasts spacious and versatile accommodation throughout, complemented by a range of sheltered outdoor areas that offer fantastic flexibility for use as a home gym, workshop, storage, entertaining space or hobby area. Conveniently located close to local amenities, schools and transport links, this is a superb family home that provides both practicality and lifestyle appeal.



## THE FINER DETAILS

***Situated in the popular village of Forest Town, this impressive three-bedroom semi-detached home occupies an exceptional plot and offers spacious, versatile accommodation ideal for modern family living***

Conveniently located close to local amenities, well-regarded schools and transport links, the property combines a fantastic location with generous indoor and outdoor space.

The ground floor welcomes you with an entrance hall leading into a comfortable living room, while the stunning kitchen/dining room provides the perfect heart of the home for everyday living and entertaining. A spacious family room/conservatory offers additional reception space overlooking the garden, complemented by a practical utility room. Externally, two sheltered outdoor areas provide excellent versatility, with one currently set up as a home gym and the other ideal for storage, a workshop or further recreational use.

To the first floor are three well-proportioned bedrooms, all served by a modern family bathroom, creating comfortable accommodation for families, couples or those needing additional home office space.

Outside, the property continues to impress with a large, beautifully maintained lawned garden and a generous patio seating area, providing the perfect setting for outdoor dining, entertaining or simply relaxing while enjoying the surrounding space.





**BuckleyBrown**  
ESTATE AGENTS







## LIFE IN FOREST TOWN

***Forest Town is a popular and well-established village on the outskirts of Mansfield, offering the perfect balance of peaceful surroundings and everyday convenience.***

With a welcoming community atmosphere, it's an ideal location for families, professionals and retirees alike.

The village benefits from a wide range of local amenities, including supermarkets, independent shops, cafés, schools and healthcare facilities, ensuring everything you need is close to home. Mansfield town centre is just a short drive away, providing an even greater choice of shopping, dining and leisure facilities.

For those who enjoy the outdoors, Forest Town is surrounded by green spaces, woodland walks and nearby parks, with excellent access to the wider countryside. The area also boasts convenient transport links to Mansfield, Nottingham and surrounding towns, making it an excellent choice for commuters while still offering a relaxed village lifestyle.



Ground Floor  
88sq.m/949.64sq.ft  
Approx



First Floor  
42sq.m/456.17sq.ft  
Approx

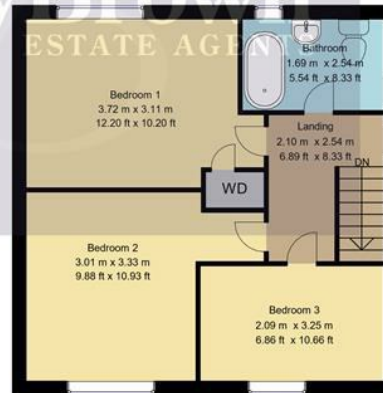

Whilst every attempt has been made to ensure the accuracy of the floor plan contained here, no responsibility is taken for incorrect measurements of doors, windows, appliances and room or any error, omission or misstatement. Exterior and interior walls are drawn to scale based on interior measurements. Any figure given is for initial guidance only and should not be relied on as basis of valuation. These plans are for marketing purposes only and should be used as such by any prospective purchase. Specially no guarantee is should not be relied on as a basis of valuation. These plans are for marketing purposes only and should be used as such by any prospective purchase. Specifically no guarantee is given on the total square footage of the property if quoted on this plan.

## Key Features

Three-bedroom semi-detached family home

---

Beautifully presented throughout

---

Stunning kitchen/dining room

---

Separate family room/conservatory

---

Two sheltered outdoor areas with versatile uses

---

Three generous first-floor bedrooms

---

Large, well-maintained rear garden

---

Patio seating area perfect for entertaining

---

---

---



These particulars are intended as a guide only and do not form part of any offer or contract. All descriptions, measurements, images and plans are provided for illustration purposes and should not be relied upon as statements of fact. Prospective purchasers should satisfy themselves as to the accuracy of the information. Buckley Brown Estate Agents accept no liability for any loss arising from reliance on these details.

© Buckley Brown Estate Agents 2026. All rights reserved.

Exceptional homes deserve  
exceptional representation.

Let's Chat.

01623 633633

[mansfield@buckleybrown.co.uk](mailto:mansfield@buckleybrown.co.uk)

[buckleybrown.co.uk](http://buckleybrown.co.uk)

**BuckleyBrown**  
ESTATE AGENTS