

LEASEHOLD



Apartment (EPC Rating: C)

**BEKEN COURT, FIRST AVENUE,
WATFORD, WD25 9PG**

£132,500

2 Bedroom Apartment located in Watford

Immaculate, chain-free two-bedroom apartment in the ever-popular Beken Court, fully modernised with fresh décor and a high-spec brand-new kitchen and bathroom. Ready to move straight into, with generous residents and visitors parking and excellent on-site facilities.

Guide Price: £132,500

Two-bedroom second-floor apartment for the over 60s

This beautifully refurbished apartment is set within the highly sought-after Beken Court, a friendly and well-managed development for the over 60s. The property has been upgraded throughout to an exceptional standard, featuring a brand-new kitchen with integrated white goods and a luxurious new bathroom with a top-spec walk-in shower and glass partition.

The apartment enjoys a south-facing aspect overlooking the landscaped gardens, with no direct neighbours either side - ideal for those seeking peace and quiet. Residents benefit from on-site parking, generous visitor spaces, a warden service and Careline access for added reassurance.

Beken Court is renowned for its vibrant community spirit, offering regular activities and social events, including a popular garden club, weekly yoga sessions and day trips. The welcoming residents' lounge and beautifully maintained communal gardens create a wonderful environment to relax and connect.

A perfect choice for buyers seeking a tranquil, modern home in a thriving community.



WATFORD SALES | 12 MARKET STREET, WATFORD, HERTFORDSHIRE, WD18 0PD

SECOND FLOOR
598 sq.ft. (55.5 sq.m.) approx.

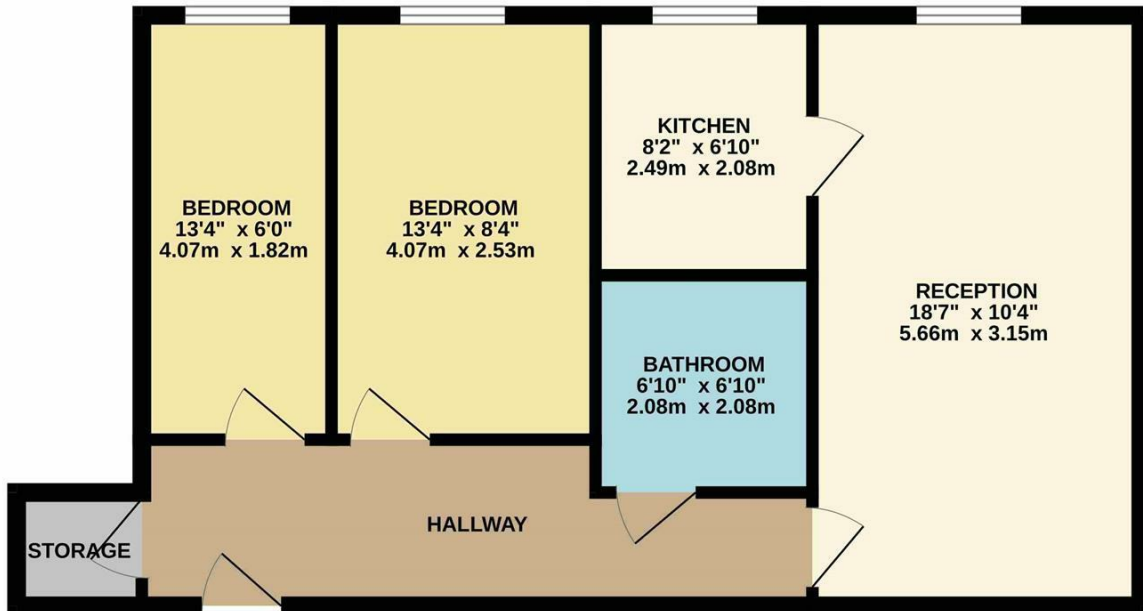

Council Tax Band

C

Energy Performance Graph

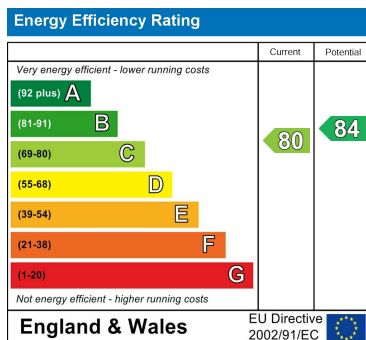

Call us on

01923 220012

sales@warrenanthony.co.uk

<https://www.warrenanthony.co.uk>

Agents Note: Whilst every care has been taken to prepare these particulars, they are for guidance purposes only. All measurements are approximate and are for general guidance purposes only and whilst every care has been taken to ensure their accuracy, they should not be relied upon and potential buyers are advised to recheck the