



Borland Road, SE15

£350,000

Set within a modern and well maintained development, this beautifully presented, spacious one bedroom apartment offers generous open-plan living with large south-west facing windows and a sunny private balcony overlooking one of three quiet communal gardens, and views over the leafy allotments beyond.

Alpha House is located in a relaxed yet buzzing corner of London. Peckham Rye Park and the magnificent Nunhead Cemetery are on your doorstep, along with the famed community owned Ivy House pub. It's a short walk through the park to the cafes, restaurants, bars and shops of Peckham and East Dulwich.

There are excellent transport links with Nunhead Station a 12 minute walk away running direct services to Victoria (16 minutes), Blackfriars (17 minutes), St Pancras (27 minutes) and beyond. The apartment also benefits from a secure allocated parking space.

Features

- One Bedroom Apartment
- Private Balcony
- Beautifully Presented
- Allocated Parking Space
- Share Of Freehold
- Great Location

Borland Road, London, SE15

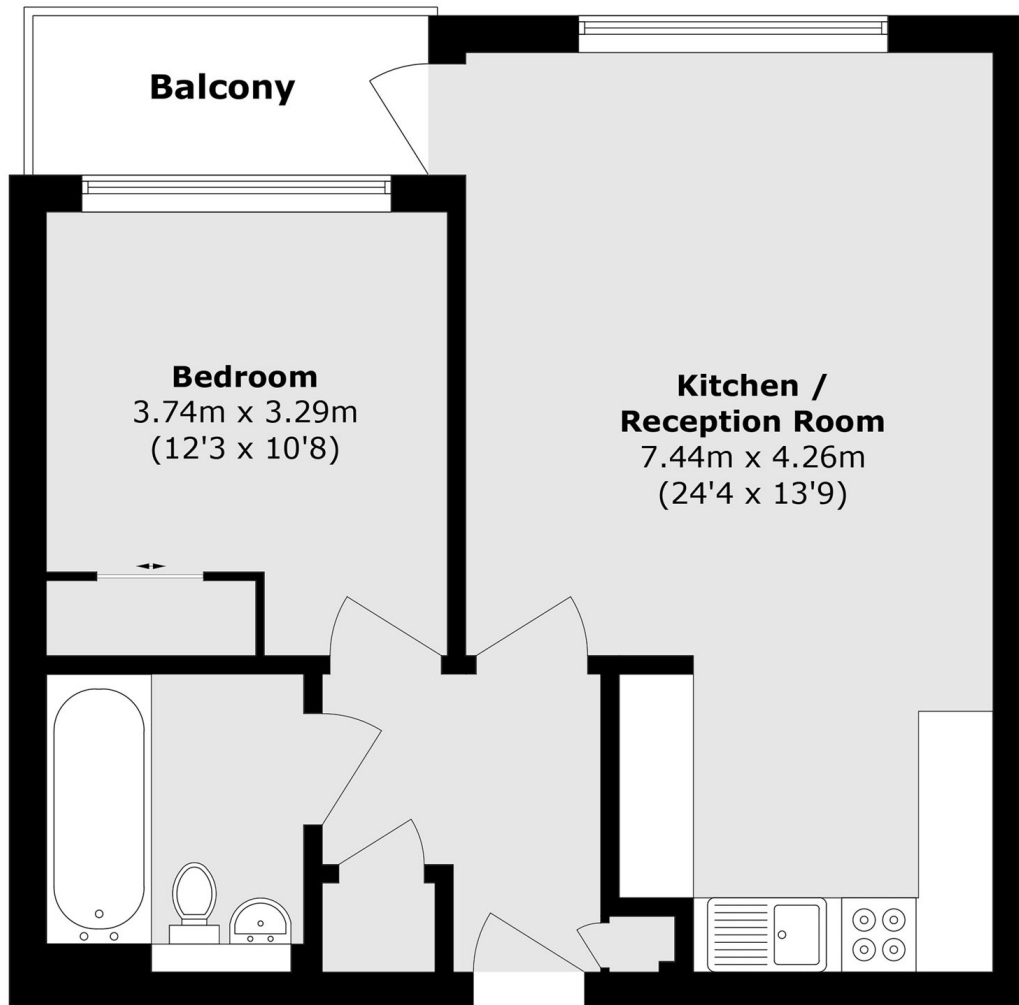

Total area (approx.): 52.5 sq. m (565.1 sq. ft)

Balcony area (approx.): 4.1 sq. m (44.1 sq. ft)