



## Sheldon Square, W2

£484 Per week

A recently refurbished one bedroom new build apartment with wooden floors and views towards the canals of Little Venice. The property has a tiled bathroom, lift access, porter and additional storage.

Found between the shops, bars and restaurants of Paddington Basin, the closest Station is Paddington and the property is near to the A40 for motorists.

### Features

- One Bedroom
- New Build
- Recently Refurbished
- Wooden Floors
- Open Plan
- Modern Bathroom

# Sheldon Square, London, W2

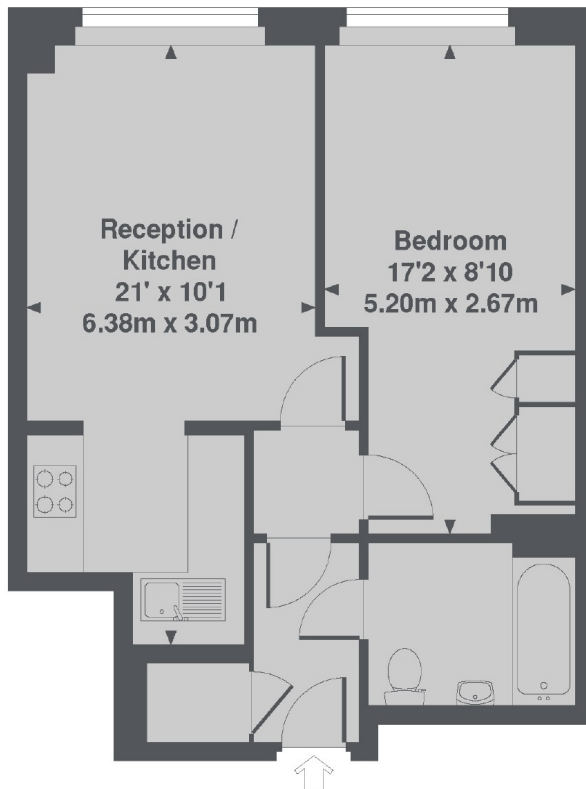

2nd Floor

Sheldon Square, W2

Total Approx. Floor area 433 Sq. Ft. (40.2 Sq. M.)