



**Mr D Ginger – 5\***

Would thoroughly recommend! Chad and the team have kept us well informed all the way through the process, even during the difficult lockdown period and have made all parts of the journey as stress free as possible.

**Mr M Muggeridge – 5\***

I was extremely happy with the service I received from the beginning; with Louis and Chad who looked after the negotiation and sale of the property, right through to the completion of the sale with Nicola. Nicola was incredibly efficient with all the paperwork which needed completing and continued to keep me updated and in the loop throughout the process. She was helpful and offered exceptional customer service. I would not hesitate to recommend this

**Mr D Tomlinson – 5\***

The staff at SJ Smith were great and made the moving process go as smoothly as possible. A big thank you.

**Mr K Ziolkowski – 5\***

Hello everyone. I just sold my property with S.J. Smith and I'm really happy with my decision. They are very professional. Special thanks to Mr Robert who has done professional valuation of the property, professional photos and professional advice. Special thanks for Mr Chad who has been with me through whole process of selling. He always been available (even when days off), very active in communication with other involved parties. I can honestly recommend SJ Smith as a really professional team.

**Mrs W Teverson – 5\***

We originally signed up with Purple Bricks (purely cost saving) but Chad tempted us to give S J Smith an opportunity – and I admit it is a different service to that of an online agency, you get what you pay for and they provided a professional service all the way through, we were delighted and would highly recommend this local agency to anyone buying or selling in the area.

**Mr J O'Shea – 5\***

Very good professional service. Very responsive and pro-active in getting the purchase completed. Would recommend their services.

**Mr S Dymo – 5\***

Chad at smiths was very very good. Great communication. Very helpful, would like to thank Chad and Nicola for all their help. Done a great job. Would definitely recommend smiths.

**Mr J – 5\***

There is a reason why you see so many SJ Smith sale boards around Sunbury, Ashford and Staines compared to the other companies! As first time buyers we had no idea what to expect but from start to finish the service we received from them was exceptional. Louis showed us around the property and was very professional. No hard sale and let us take our time also very knowledgeable answering my questions about the property and surrounding area. He and Chad helped secure the sale through negotiating and agreeing a price. Nicola was an absolute god send during the process and helped keep us sane throughout. Quick to respond to our queries and persistent with keeping things moving. We are now settled in our new home and forever grateful to SJ Smith for their efforts in making it happen!

**Mrs A J Tyler – 5\***

Great service from start to finish. Lovely friendly service from Louis and Rob and exceptional after sales service from Nicola. Highly recommended.



**Flat 14 Maple House, Gatehouse Close, Ashford, TW15 1HY**  
**£350,000 - Leasehold**

A well presented two bedroom, two bathroom apartment located in the popular Maple House development in Ashford. This modern flat offers comfortable and practical living, ideal for professionals, couples, or small families. The property features a bright and spacious open plan living and dining area, providing an excellent space for relaxing or entertaining. The modern kitchen is neatly integrated, offering ample storage and worktop space. There are two well proportioned bedrooms, including a master bedroom with an en suite shower room, alongside a contemporary main bathroom finished to a good standard. The property has a covered parking area and electrical charging ports for residents. Situated in a quiet residential close, the flat benefits from excellent access to Ashford town centre, local shops, green spaces, and transport links, including Ashford Station.



6 Station Approach  
Ashford  
Middlesex  
TW15 2QN

t: 01784 243333  
e: ashford@sjsmithestateagents.co.uk  
www.sjsmithestateagents.co.uk

- TWO DOUBLE BEDROOMS
- HIGH SPECIFICATION FINISH
- 996 YEAR LEASE
- TWO BATHROOMS
- ALLOCATED PARKING SPACE
- CLOSE TO LOCAL AMENITIES
- EXCELLENT TRANSPORT LINKS
- EPC RATING BAND

Approximate Gross Internal Area  
67.96 sq m / 732 sq ft

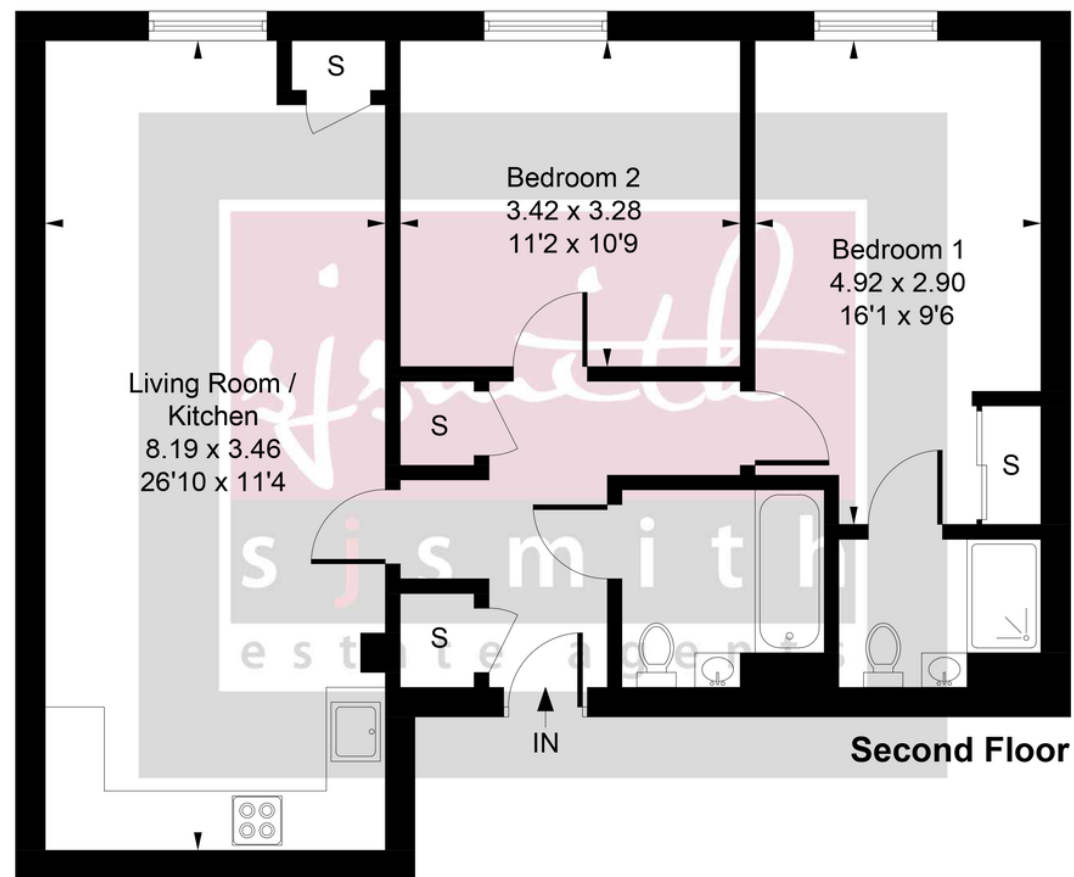

Whilst every attempt has been made to ensure the accuracy of the floor plan contained here, measurements of doors, windows, rooms and any other items are approximate and no responsibility is taken for any error, omission, or mis-statement. This plan is for illustrative purposes only and should be used as such by any prospective purchase.



### Council Tax

Spelthorne Borough Council, Tax Band D being £2,412.78 for 2025/26 Council tax bands can be reassessed by local authorities at any point, the council tax band is only taken at point of listing and should not be relied on as current banding

### Lease and service charge information, all to be confirmed via solicitors;

Tenure: Leasehold 996 year remaining on the lease

Service Charge: £2,000 pa

Ground rent: £0

**Agent note** Under Consumer Protection Regulations we have endeavoured to make these details as reliable and as accurate as possible. The accuracy is not guaranteed and does not form part of any contract as the details are prepared as a general guide. We have not carried out a detailed survey or tested any appliances, specific fittings, or services (gas/electric). Room sizes should not be relied upon for carpets or furnishing nor should internal photos as these are intended as a guide only and may have changed since. It should not be assumed that any furniture/fittings are included. Lease, ground rent, maintenance or any other charges have been provided by the vendor and their accuracy cannot be guaranteed. We always advise a buyer should obtain verification on points via a solicitor.