



DUCKMAN TOWER, E14

£370,000

A bright 1 bedroom apartment located on a high floor of the popular Lincoln Plaza development with a private East-facing balcony. Comprising of an open-plan kitchen with engineered wooden flooring throughout the hallway and spacious kitchen/lounge. The bedroom is also spacious with modern interior.

- 24h Concierge
- Service Charge: £3951
- Winter garden/Roof Terrace
- Ground Rent: £500



ABOUT THE HOME

0.3 Miles to South Quay DLR station with excellent transport links to Canary Wharf and the City.





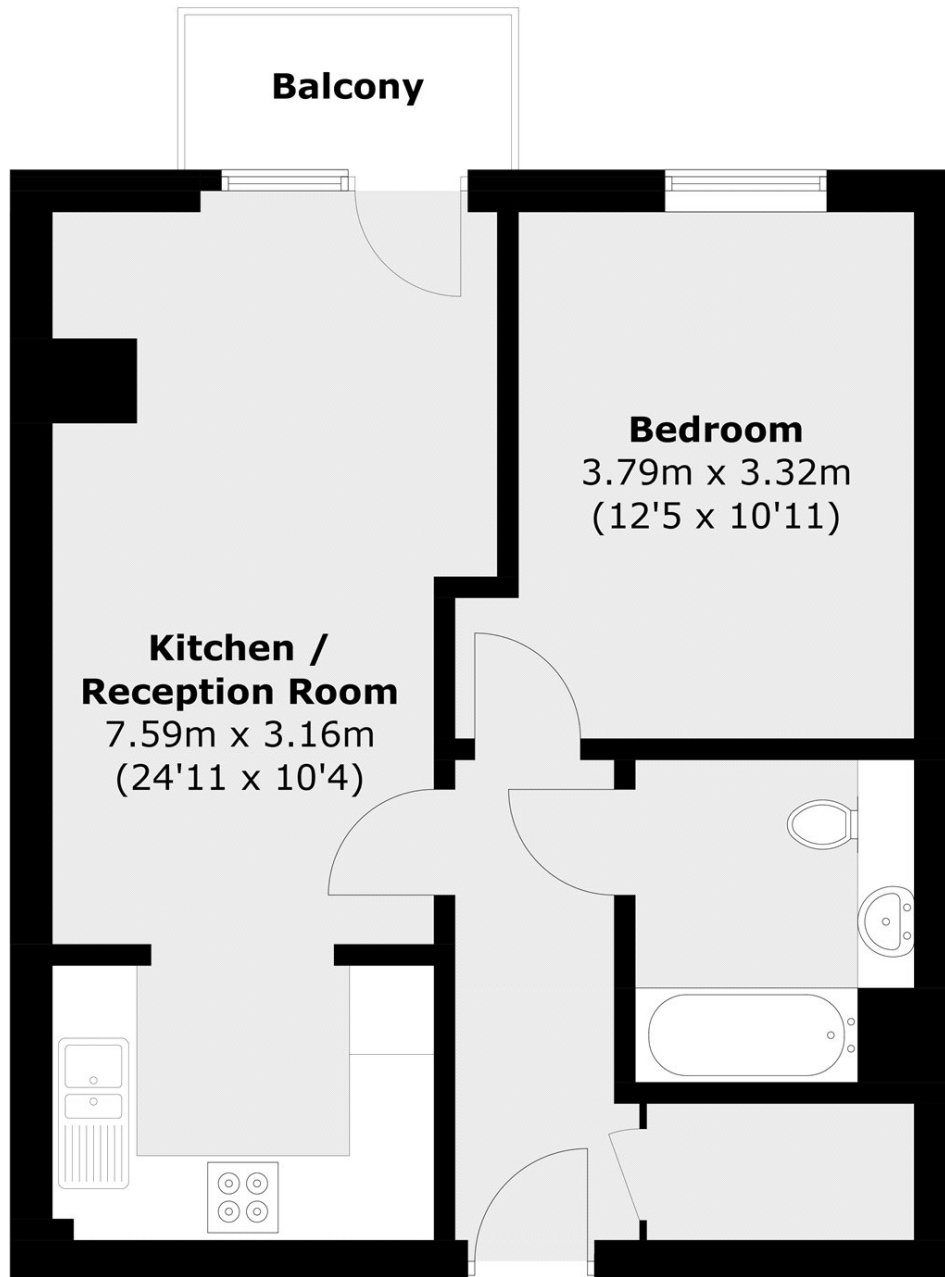

Total area (approx.): 45.1 sq. m (485.4 sq. ft)
Balcony: 2.5 sq. m (26.9 sq. ft)

LiFE RESIDENTIAL

36 Millharbour, London, E14

9JS

Sales: 020 3668 1033

Lettings: 020 3668 1030

Energy Rating: B. We aim to make our particulars both accurate and reliable. However they are not guaranteed; nor do they form part of an offer or contract. If you require clarification on any points then please contact us, especially if you're traveling some distance to view. Please note that appliances and heating systems have not been tested and therefore no warranties can be given as to their good working order.