



Luscombe Maye

Since 1873

# Elmwood Park, Loddiswell, Kingsbridge, TQ7 4SD

£285,000

🛏️ 2 🚿 1 🚺 2



- Two Double Bedrooms
- Sun Room/Conservatory
- Utility Room
- Garden Area
- Open-Plan Living
- Driveway Parking
- Village Location



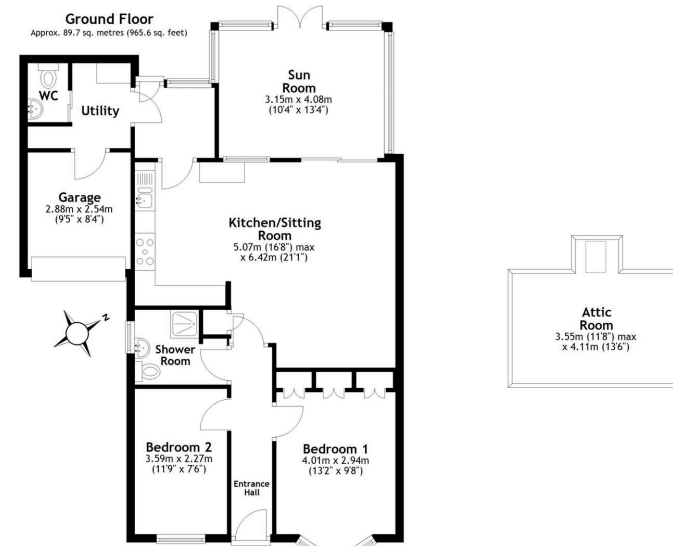

Total area: approx. 89.7 sq. metres (965.6 sq. feet)  
78 Elmwood Park, Loddiswell

A well-presented two bedroom bungalow offering bright and spacious open-plan living, countryside views, driveway parking and a practical layout, set within a popular village location.

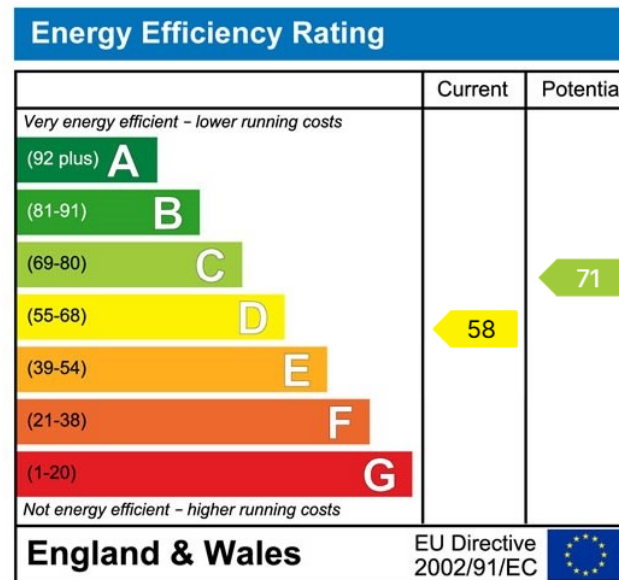

Important Notice: Luscombe Maye gives notice that: 1. These particulars do not constitute an offer or contract or part thereof. 2. All descriptions, photographs and plans are for guidance only and should not be relied upon as statements or representations of fact. All measurements are approximate and not necessarily to scale. Any prospective purchaser must satisfy themselves of the correctness of the information within the particulars by inspection or otherwise. 3. Luscombe Maye does not have any authority to give any representations or warranties whatsoever in relation to this property (including but not limited to planning/building regulations), nor can it enter into any contract on behalf of the Vendor.