



SERVING
BEACONSFIELD
SINCE
1998
EXCELLENCE IN
ESTATE AGENCY

Flat 1, The Courtyard Grove Road, Beaconsfield

Guide Price £875,000

Ashington Page

This beautifully presented two-bedroom, town centre apartment offers contemporary living in a highly sought-after development, combining style, comfort, and practicality throughout. The property is offered vacant and with no onward chain, making it an ideal choice for buyers seeking a swift and uncomplicated move within easy reach of local amenities, shopping, and excellent transport links.

- Approx Sq Feet: 1,514 sqft
- Property Age Bracket: 2010s
- Council Tax Band: F
- Tenure: Share of Freehold
- Lease Expiry: 01/12/3010
- Service Charge: £3,600.00 per year

These particulars are for guidance only. They are prepared and issued in good faith and are intended to give a fair summary of the property. Any description should not be relied on as a statement or representation of fact or that the property, or its services, are in good condition. The photographs show only certain parts of the property at the time they were taken. Any areas, measurements or distance given are approximate only. Any reference to alterations to, or use of, any part of the property is not a statement that any necessary planning, building regulations or other consent has been obtained. These matters must be verified by an intending purchaser. All statements contained in these particulars in relation to the property are made without responsibility of Ashington Page or its clients. Neither Ashington Page (nor any joint agents) nor any of their employees has any authority to make or give any representation or warranty whatsoever in relation to the property

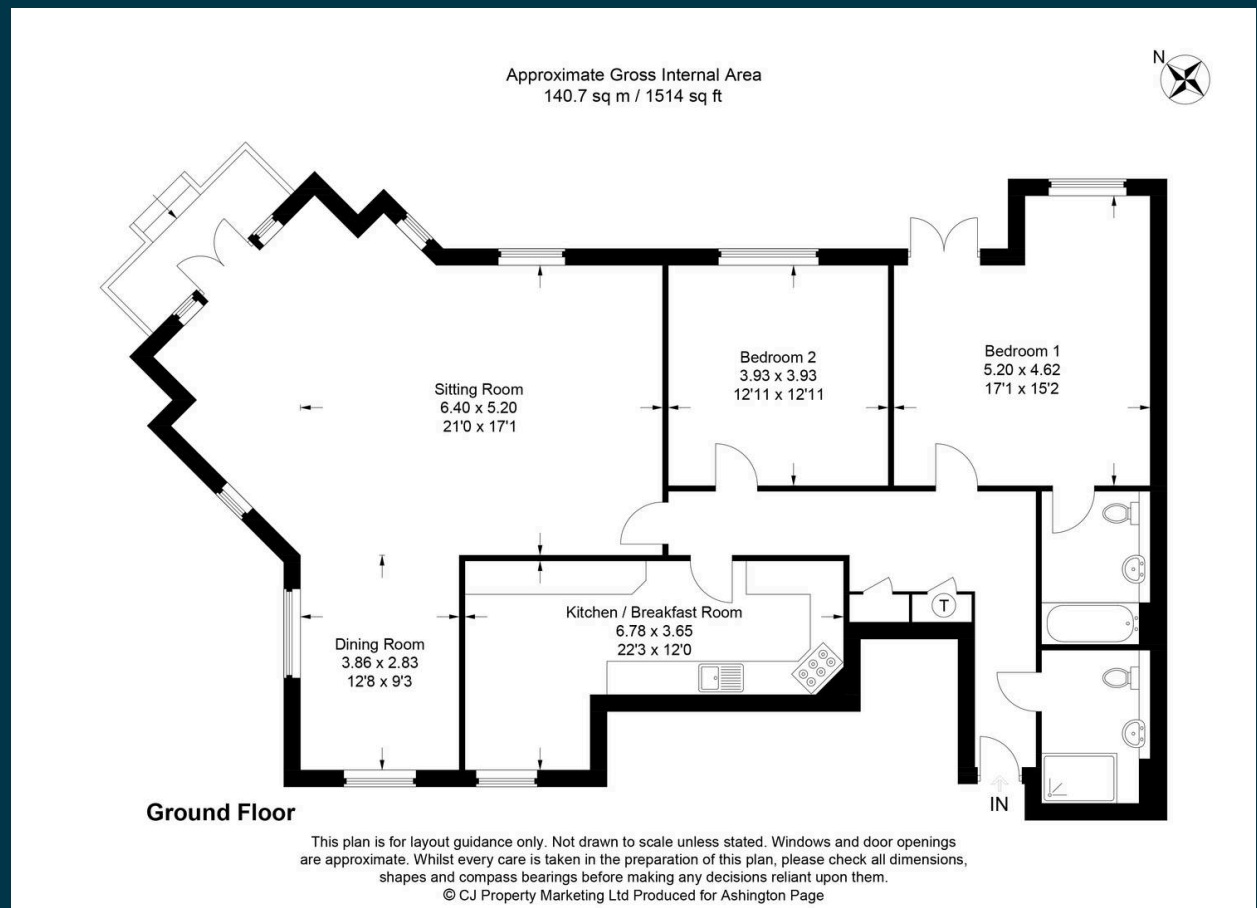

01494 680018
info@ashingtonpage.co.uk
www.AshingtonPage.co.uk

