



# Broadway Court

Crouch End Hill, N8

£3,100 per month  
(£715.38 per week)

Presenting an 800 sq. ft. three-bedroom apartment offering spacious and well-proportioned accommodation throughout.

The property comprises three good-sized bedrooms, a bright and spacious main reception room, an additional reception room, a separate

**CHESTERTONS**



# Broadway Court

## Crouch End Hill, N8

- Three Bedroom First Floor Apartment
- Bright Reception Room
- Separate Kitchen
- Furnished or Unfurnished
- Two Family Bathrooms
- Excellent Location



Presenting an 800 sq. ft. three-bedroom apartment offering spacious and well-proportioned accommodation throughout.

The property comprises three good-sized bedrooms, a bright and spacious main reception room, an additional reception room, a separate fitted kitchen and two bathrooms.

Further benefits include excellent natural light, generous storage and the flexibility to be offered either furnished or unfurnished.

**Minimum Term:** 12 months  
**Deposit Required:** £3,576.92  
**Local Authority:** Haringey  
**Council Tax Band:**  
**EPC Rating:** D  
**Part Furnished**

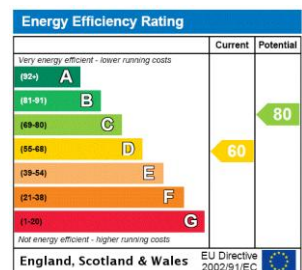

### Chestertons Kentish Town Lettings

225 Kentish Town Road  
 London  
 NW5 2JU  
 kentishtownlettingsusers@chestertons.co.uk  
 02072671010  
 chestertons.co.uk

Additional tenant charges apply (fees apply to non-AST tenancies only)  
 Tenancy Agreement Fee: £300  
 References per Tenant/Guarantor: £60  
 Inventory check (approx. £100 – £250 inc. VAT)  
 chestertons.co.uk/property-to-rent/applicable-fees

# Broadway Court

Approximate Gross Internal Area = 800 sq ft / 74.3 sq m

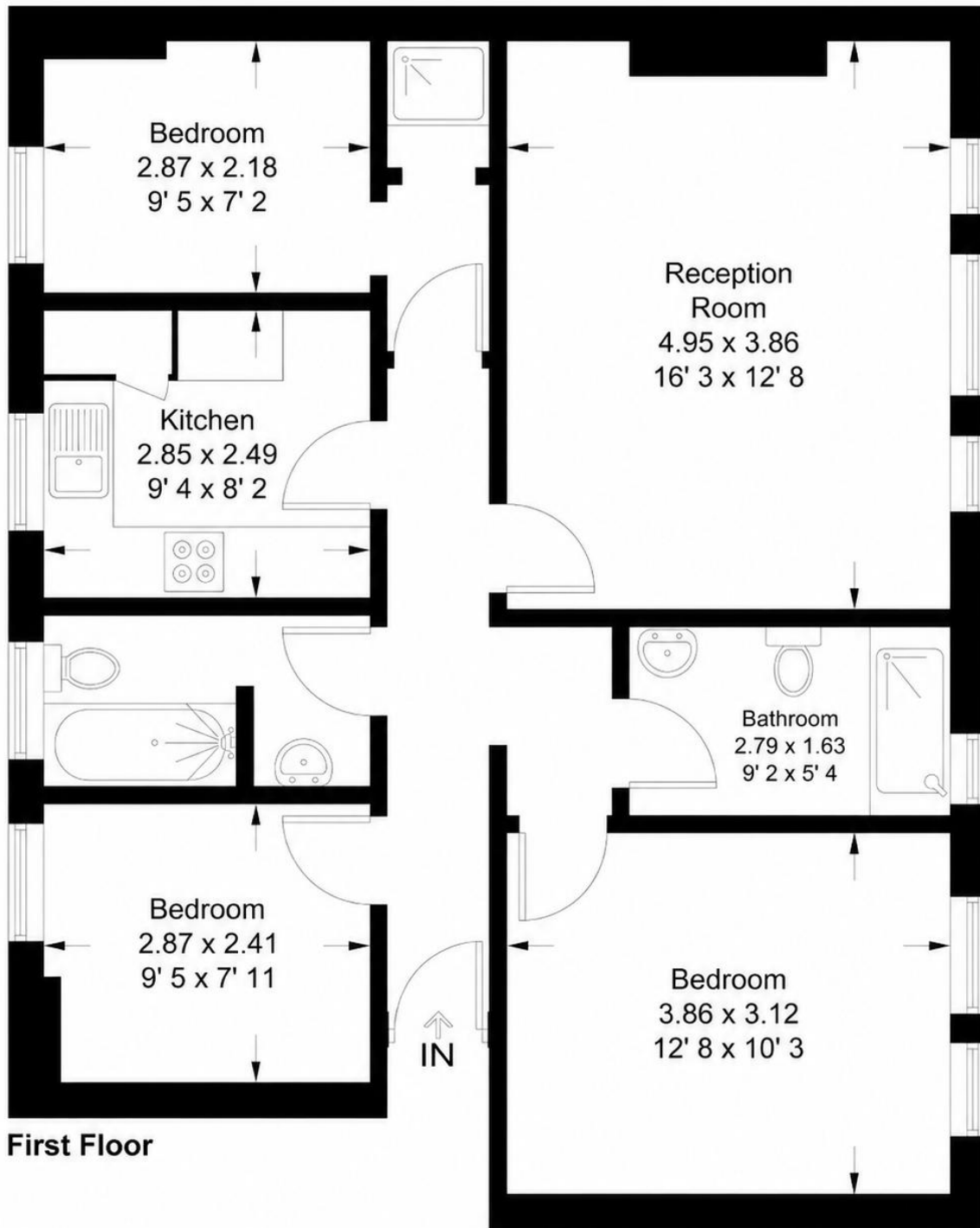

**First Floor**

This plan is not to scale and must be used as layout guidance only. All measurements and areas are approximate and should not be relied upon to provide accurate information. This plan must not be relied upon when making property valuations, design considerations or any other such relevant decisions. We accept no responsibility or liability (whether in contract, tort or otherwise) in relation to any loss whatsoever arising from or in connection with any use of this plan or the adequacy, accuracy or completeness of it or any information within it.