



Tilgate Gardens, Coulsdon, CR5 1EX

£620,000

- SEMI - DETACHED FAMILY HOUSE
- TWO BATHROOMS
- AIR SOURCE HEAT PUMP
- LANDSCAPED GARDEN
- EPC - C
- THREE DOUBLE BEDROOMS
- MODERN FITTED KITCHEN
- UNDERFLOOR HEATING
- OFF STREET PARKING
- COUNCIL TAX BAND - F

Bedrooms: 3 | Bathrooms: 2 | Receptions: 1

Property Type: Semi Detached House

Approximate Gross Internal Area 1288 sq ft - 119 sq m

Ground Floor Area 651 sq ft – 60 sq m

First Floor Area 637 sq ft – 59 sq m

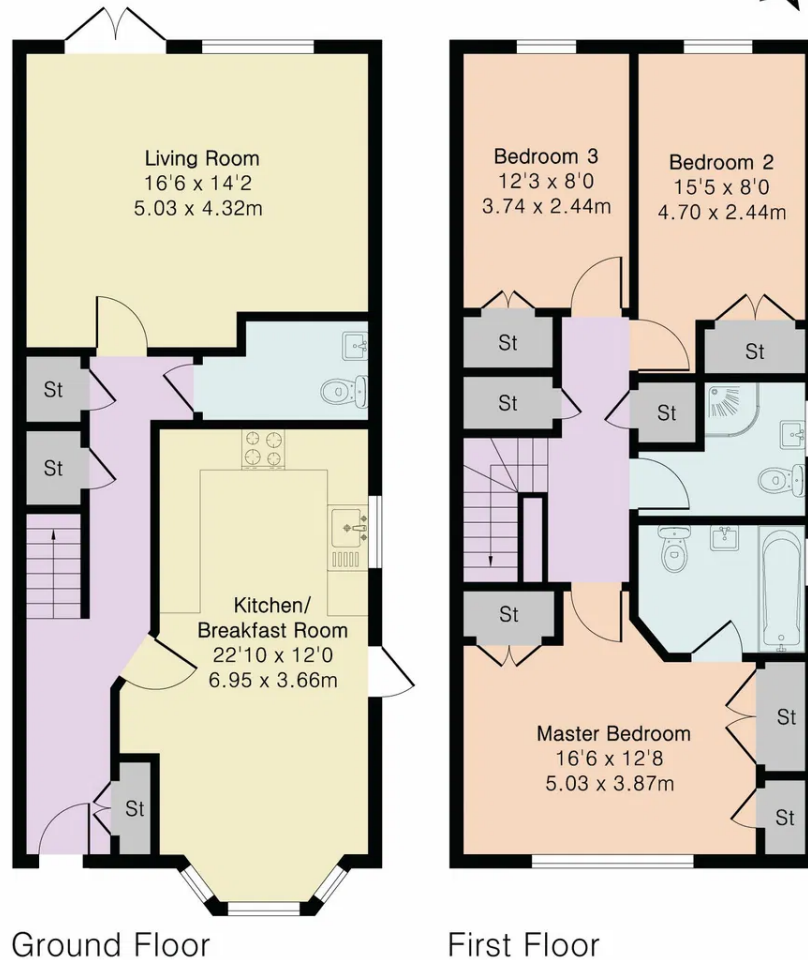

Floor plan produced in accordance with RICS Property Measurement 2nd Edition. Although Pink Plan Ltd ensures the highest level of accuracy, measurements of doors, windows and rooms are approximate and no responsibility is taken for error, omission or misstatement. These plans are for representation purposes only and no guarantee is given on the total square footage of the property within this plan. The figure icon is for initial guidance only and should not be relied on as a basis of valuation.



John Brown & Mark Youll - Sales

105 Coulsdon Road, Old Coulsdon, Surrey CR5 1EH

01737 551111 | hello@johnbrownmarkyoull.co.uk | <https://www.johnbrownmarkyoull.co.uk/>