



Willowmead, HERTFORD, SG14 2AU

Welcome to Willowmead, HERTFORD

Situated in a popular residential area and a 20-minute walk to Hertford town centre and a 15-minute walk to Hertford North railway line, and the scenic Panshanger Park, this beautifully presented two-bedroom terraced home offers both comfort and convenience. The ground floor features a bright and airy living/dining room, ideal for relaxing or entertaining, with direct access to a modern, well-proportioned kitchen. The kitchen is fitted with contemporary units, built-in appliances and opens out to a private, secluded west facing rear garden designed for low maintenance enjoyment. Upstairs, the first-floor hosts two generous double bedrooms and a stylish, modern family bathroom. Additional benefits include double glazing throughout, gas central heating, and a garage en bloc, providing ample storage or parking options. This charming home is perfect for first-time buyers, downsizers, or investors alike-early viewing is highly recommended.



-Accommodation Overview-

Entrance Hall:

Door leading to lounge.

Lounge Diner:

18' 9" x 12' 3" (5.71m x 3.73m)

Double glazed window to front aspect, stairs leading to first floor, laminate flooring, radiator.

Kitchen:

12' 4" x 8' 2" (3.76m x 2.49m)

Fitted wall and floor units with work surface over, stainless steel sink unit with mixer tap over, gas hob with electric oven beneath and extractor canopy over, space for washing machine, integrated dishwasher, space for fridge freezer, boiler installed in 2025, tiled floor, double glazed window and patio door leading to rear garden.

-First Floor Landing-

loft access - boarded and insulated.

Bedroom One:

12' 5" max x 10' 5" max (3.78m max x 3.17m max)

Double glazed window to front aspect, radiator.

Bedroom Two:

12' 6" excluding storage cupboard x 8' 2" max (3.81m excluding storage cupboard x 2.49m max)

Double glazed window to rear aspect, storage cupboard, radiator.

Bathroom:

Three-piece suite comprising of panel enclosed bath with shower over, wash hand basin with mixer taps over, WC, tiled walls, tiled floor, spot lighting.

-Exterior-

Rear Garden:

A sunny low maintenance west facing rear garden with patio great for seating with lawn area, fence boundary walls.

Front Garden:

Path leading to front, shingled front, pots and plants.

Garage - En - Bloc

16' 2" x 8' 2" (4.93m x 2.49m)



Check out more properties at williamhbrown.co.uk

welcome to Willowmead, Hertford

- A Well Presented Two Double Bedroom Mid-Terrace House
- Garage-En-Bloc
- 15 Min Walk To Hertford North Train Station & 20 Min Walk To Hertford Town Centre
- Sunny & Secluded Low Maintenance Rear Garden
- Bright & Airy Living / Dining Room

Tenure: Freehold EPC Rating: C
Council Tax Band: D

Guide price
£400,000

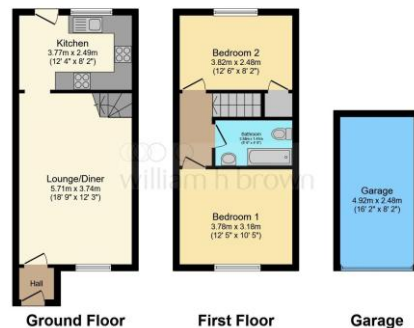

This floor plan is for illustrative purposes only. It is not drawn to scale. Any measurements, floor areas (including any total floor area), openings and orientation are approximate. No details are guaranteed, they cannot be relied upon for any purpose and they do not form part of any agreement. No liability is taken for any error, omission or measurement. A party must rely upon its own inspection(s). Powered by www.houseagent.com



check out more properties at williamhbrown.co.uk



Property Ref:
HFD107853 - 0001

1. MONEY LAUNDERING REGULATIONS Intending purchasers will be asked to produce identification documentation at a later stage and we would ask for your co-operation in order that there is no delay in agreeing the sale. 2. These particulars do not constitute part or all of an offer or contract. 3. The measurements indicated are supplied for guidance only and as such must be considered incorrect. Potential buyers are advised to recheck measurements before committing to any expense. 4. We have not tested any apparatus, equipment, fixtures or services and it is in the buyers interest to check the working condition of any appliances. 5. Where an EPC, or a Home Report (Scotland only) is held for this property, it is available for inspection at the branch by appointment. If you require a printed version of a Home Report, you will need to pay a reasonable production charge reflecting printing and other costs. 6. We are not able to offer an opinion either written or verbal on the content of these reports and this must be obtained from your legal representative. 7. Whilst we take care in preparing these reports, a buyer should ensure that his/her legal representative confirms as soon as possible all matters relating to title including the extent and boundaries of the property and other important matters before exchange of contracts.

William H Brown is a trading name of Sequence (UK) Limited which is registered in England and Wales under company number 4268443, Registered Office is Cumbria House, 16-20 Hockliffe Street, Leighton Buzzard, Bedfordshire, LU7 1GN. VAT Registration Number is 500 2481 05.



Please note the marker reflects the postcode not the actual property

william h brown



01992 586501



Hertford@williamhbrown.co.uk



21 Castle Street, HERTFORD, Hertfordshire,
SG14 1ER



williamhbrown.co.uk