



DALES & PEAKS



66 Hackney Road

Hackney, Matlock, DE4 2PX

£475,000



3



1



nul



C

66 Hackney Road

Hackney, Matlock, DE4 2PX

Located in the most beautiful setting on an elevated plot, enjoying breathtaking views overlooking Derbyshire countryside, is this spacious 3 bedroom detached bungalow. Benefitting from 1033 sqft of bright and spacious living accommodation, decking area, tiered gardens and off street parking.

The property briefly comprises; Entrance hallway, front aspect living room with doors onto the decking area, dual aspect dining kitchen with solid wood worktops, cloak room and WC. Three double bedrooms and main bathroom.

Dales and Peaks ForwardMove
- Please read



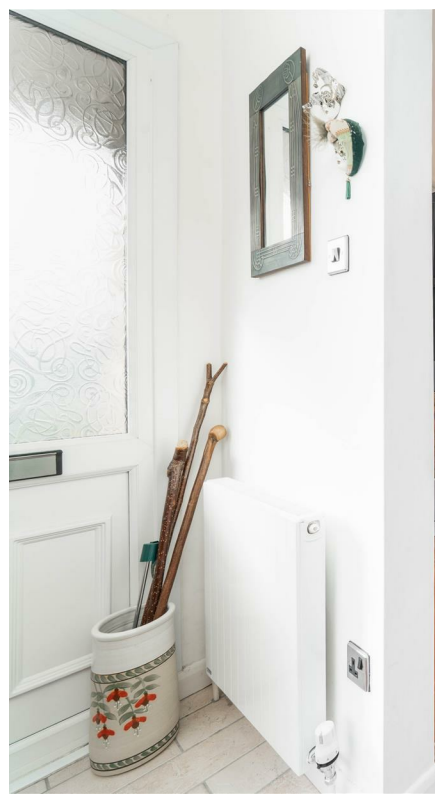

Floor Plan

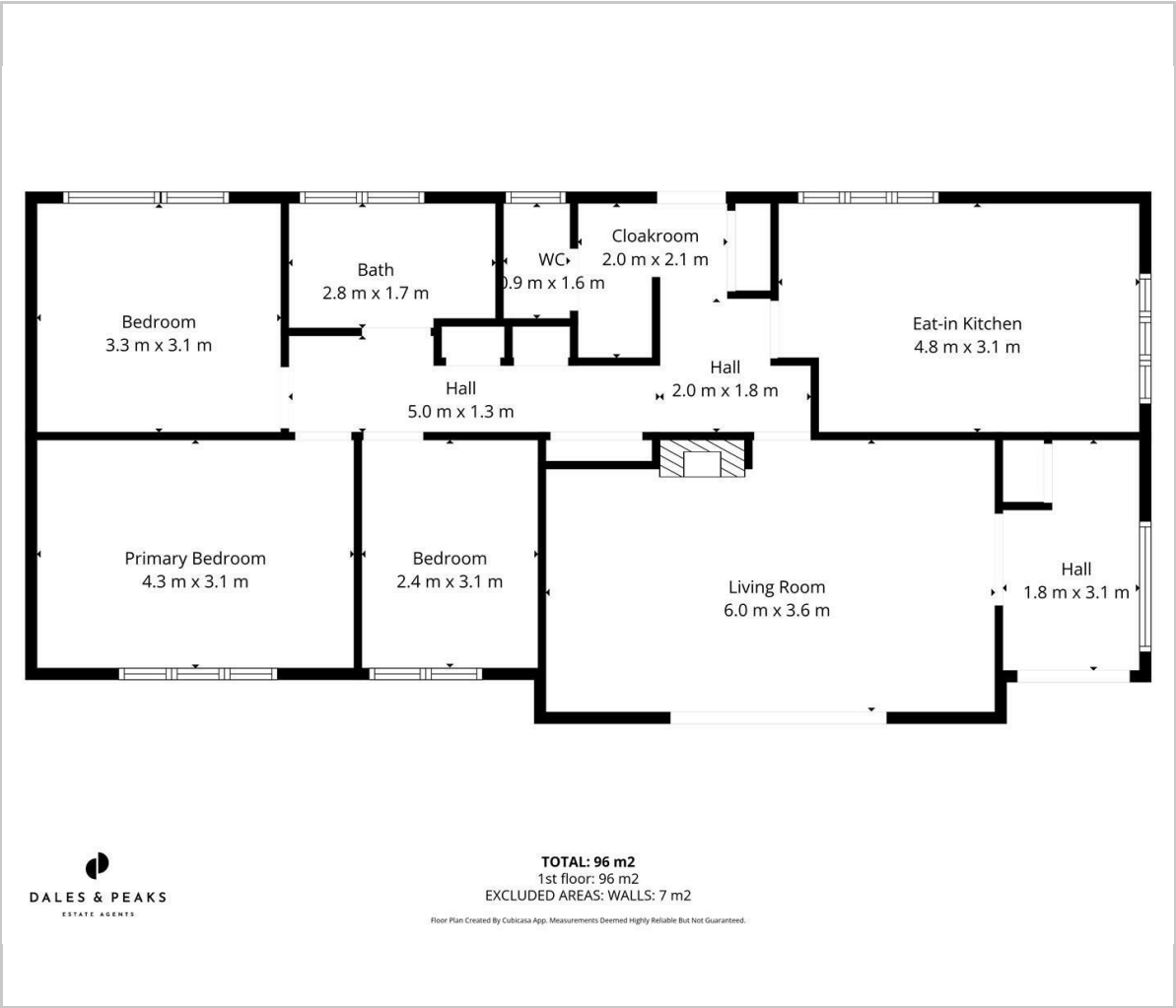

Viewing

Please contact our Chesterfield Office on 01246 567540 if you wish to arrange a viewing appointment for this property or require further information.

These particulars, whilst believed to be accurate are set out as a general outline only for guidance and do not constitute any part of an offer or contract. Intending purchasers should not rely on them as statements of representation of fact, but must satisfy themselves by inspection or otherwise as to their accuracy. No person in this firms employment has the authority to make or give any representation or warranty in respect of the property.

Area Map



Energy Efficiency Graph

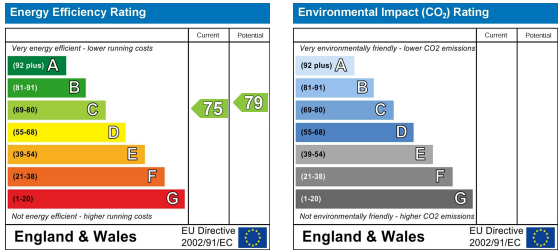

131 Chatsworth Road, Chesterfield, Derbyshire, S40 2AP
T: 01246 567540



E: info@dalesandpeaks.co.uk
www.dalesandpeaks.co.uk