

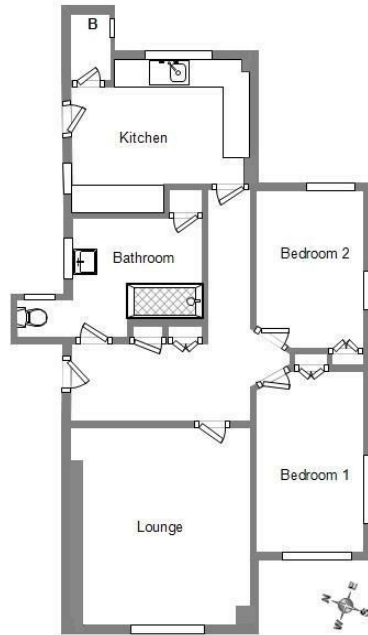

A10 Kenilworth Court, Hagley Road, Edgbaston,

£845 PCM

- Mansion styled development
- Well maintained communal gardens
- Secure gated development
- Short distance to city centre



Bedroom 1 - 2.77m x 4.10m Fourth Floor Front Right
 Bedroom 2 - 2.79m x 3.77m Fourth Floor Rear Right
 Bathroom - 4.08m x 2.70m Fourth Floor Middle Left
 Kitchen - 4.28m x 3.63m Fourth Floor Rear Left
 Lounge - 4.07m x 4.62m Fourth Floor Front Left

A10 Kenilworth Court Hagley Road Edgbaston B16 9NS

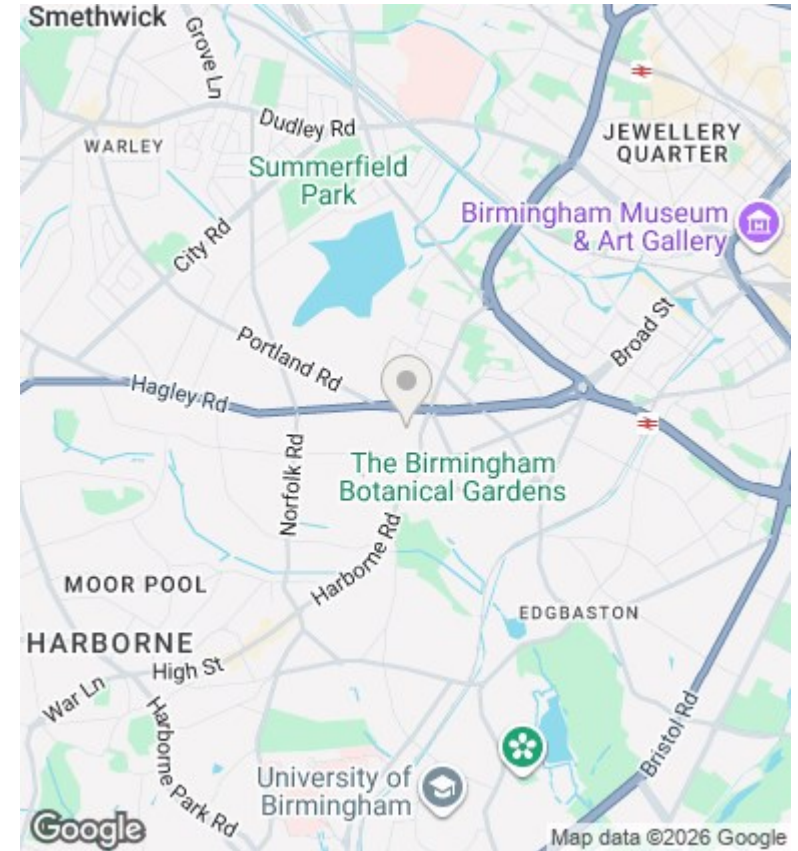

Directions

Viewings

Viewings by arrangement only.
 Call 01905 796 111 to make an appointment.

Council Tax Band

D

EPC Rating:

D

Energy Efficiency Rating		Current	Potential
<i>Very energy efficient - lower running costs</i>			
(92 plus)	A		
(81-91)	B		
(69-80)	C		
(55-68)	D	55	64
(39-54)	E		
(21-38)	F		
(1-20)	G		
<i>Not energy efficient - higher running costs</i>			
England & Wales		EU Directive 2002/91/EC	