

whiteley helyar



530 ft²



bedroom



bathroom



resident's
permit
parking

Guide Price £250,000

Flat 1, 34 Belvedere, Bath, BA1 5HR

A first floor apartment in this Grade 2 listed Georgian townhouse, located a short walk from the city centre and offered with no onward chain. The flat boasts some lovely period features, such as the expected large windows and shutters, whilst the bedroom has lovely views over the city towards Bathampton.

ACCOMMODATION

Sitting/dining room with fireplace and two multipaned windows with shutters
Galley kitchen with integrated oven and hob
Double bedroom with lovely views
Modern bathroom

LOCATION

Belvedere is most conveniently located in a fine residential position on the select lower slopes of Lansdown, less than 5 minutes walk from many of the shops and amenities in the city centre, and adjacent to the historic green space of Hedgemoad Park. Bath Spa Railway Station is within walking distance, and this location also offers swift access to the M4 without having to cross Bath.







Energy Efficiency Rating	
Current	Potential
Very energy efficient - lower running costs	
(92+)	A
(81-91)	B
(69-80)	C
(55-68)	D
(39-54)	E
(21-38)	F
(1-20)	G
Not energy efficient - higher running costs	
England & Wales	EU Directive 2002/91/EC

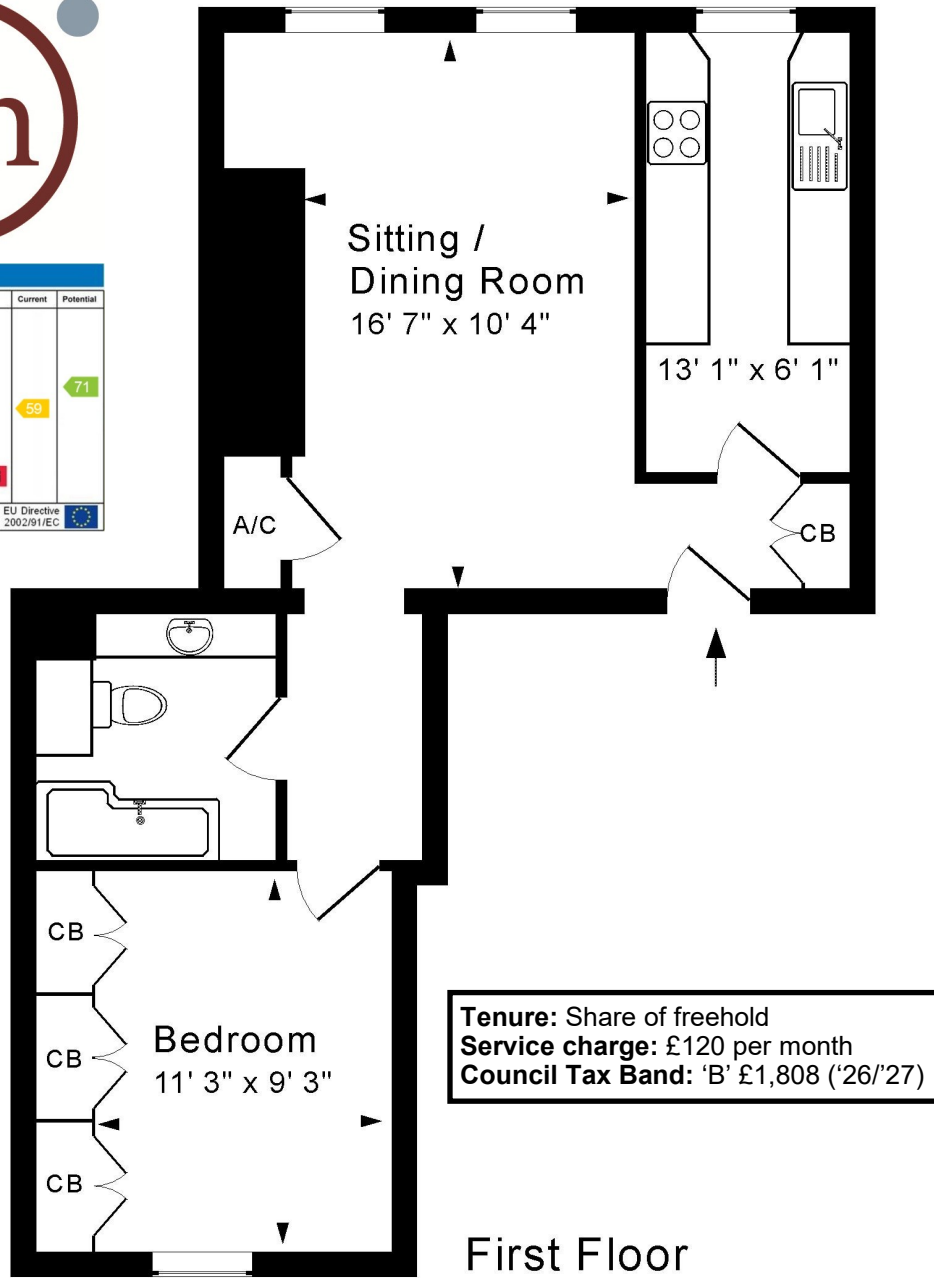

First Floor

Approx. Gross Internal Floor Area 530 Sq. Ft. / 49 Sq. M
Includes Conservatories. Excludes Garages, Porches etc. unless stated
For identification purposes only. Not to scale. Copyright Jemesis Ltd 2026
Drawing Number: 172-0898
Flat 1, 34 Belvedere, Bath, BA1 5HR.

