



Hayes Walk, Elton Peterborough  
**£325,000 Freehold**

**Sharman  
Quinney**

# Key Features



- Sought after village location
- Large rear garden
- Large garden studio with power
- Well-proportioned three bedrooms
- Open plan lounge/diner

This beautifully presented three-bedroom semi-detached home is located in a highly sought-after area on a peaceful dead-end road, offering a quiet setting with no passing traffic and immediate access to fantastic countryside walks. The property is in very good condition throughout and features an open-plan lounge and dining area that provides a bright, sociable living space. The recently redecorated kitchen benefits from a pantry and enjoys lovely views across the large rear garden and the open fields behind the property, capturing the beauty of the Northamptonshire countryside. Upstairs, there are three good-sized bedrooms along with the family bathroom, all well laid out for comfortable everyday living. The generous rear garden is a standout feature, offering extensive outdoor space, useful outbuildings, and a versatile art studio that could suit a variety of alternative



uses. The surrounding area enhances the appeal even further, with two highly respected local pubs, a popular garden centre, primary school and exceptional rural walking routes all within easy reach, making this an ideal home for those seeking a peaceful lifestyle in a truly desirable location.



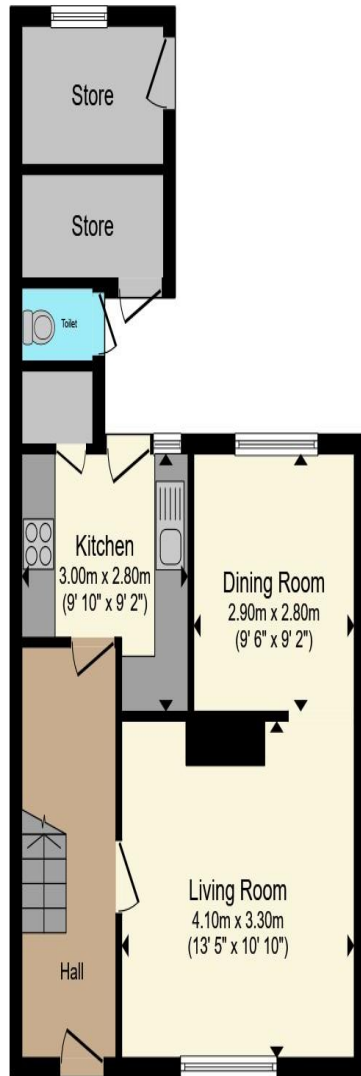

**Ground Floor**

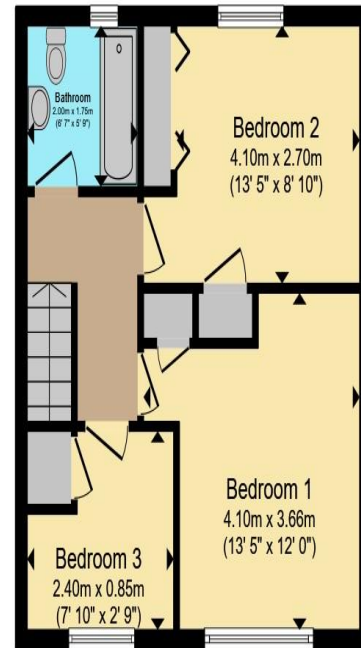

**First Floor**

Total floor area 88.2 m<sup>2</sup> (950 sq.ft.) approx

This floor plan is for illustrative purposes only. It is not drawn to scale. Any measurements, floor areas (including any total floor area), openings and orientation are approximate. No details are guaranteed, they cannot be relied upon for any purpose and they do not form part of any agreement. No liability is taken for any error, omission or misstatement. A party must rely upon its own inspection(s). Powered by [www.propertybox.io](http://www.propertybox.io)

**Sharman  
Quinney**

To view this property call Sharman Quinney on:  
**01832 274567**

# Selling your property?

Contact us to arrange a **FREE** home valuation.

 01832 274567

 The Old Town Hall Market Place, Oundle, Peterborough, Cambridgeshire, PE8 4BQ

 [oundle@sharmanquinney.co.uk](mailto:oundle@sharmanquinney.co.uk)

 [www.sharmanquinney.co.uk](http://www.sharmanquinney.co.uk)



 SCAN ME



Sharman Quinney Holdings Limited is registered in England and Wales under company number 4174227, Registered Office is Cumbria House, 16-20 Hockliffe Street, Leighton Buzzard, Bedfordshire, LU7 1GN. VAT Registration Number is 500 2481 05.

1: These particulars do not constitute part or all of an offer or contract. 2: The measurements indicated are supplied for guidance only and as such must be considered incorrect. 3: Potential buyers are advised to recheck the measurements before committing to any expense. 4: Sharman Quinney has not tested any apparatus, equipment, fixtures, fittings or services and it is the buyers interests to check the working condition of any appliances. 5: Sharman Quinney has not sought to verify the legal title of the property and buyers must obtain verification from their legal representative. 6: Intending purchasers will be asked to produce identification documentation at a later stage and we would ask your co-operation in order that there will be no delay in agreeing the sale. Ref: OUN202889 - 0001

