



Austell Gardens, Mill Hill, NW7

£1,750,000

STUNNING 5 BEDROOM 5 BATHROOM DETACHED FAMILY HOME - SOUGHT AFTER LOCATION

Cosway Estates are delighted to present a stunning five bedroom family home located in a sought after turning off Tretawn Gardens. The property consists of two large reception rooms, office, large kitchen-diner, utility room and guest W/C.

The first floor comprises of three excellent sized double bedrooms, all with en-suites and a further master bedroom with fabulous ensuite bathroom. Located on the second floor is a large double bedroom with a separate landing/games area perfect for guests or Au-pair.

The rear of the property boasts a beautiful west-facing garden with decking and the front of the property benefits from a large driveway for at least 8 cars. Austell Gardens is located in a quiet cul de sac, a short walk from Mill Hill Broadway and within multiple sought-after school catchment areas. Viewings highly advised.

Viewing

Please contact our Mill Hill Office on 02089590011 if you wish to arrange a viewing appointment for this property or require further information.

- 2825 Sq Ft
- Stunning five-bed detached home
- Two spacious receptions plus dedicated office
- Large kitchen-diner with utility
- West facing garden
- Off-street parking for 8 cars
- Prime Mill Hill
- Walking distance to the High Street and Thames Link Station
- Five Bathrooms



Floor Plan

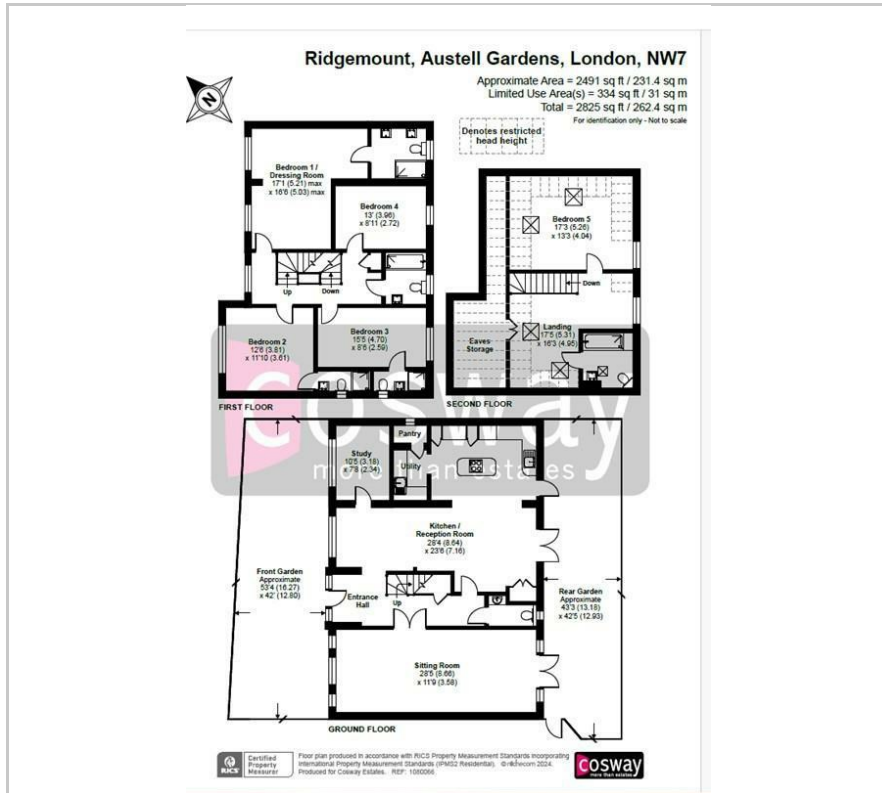

Area Map



Energy Efficiency Graph

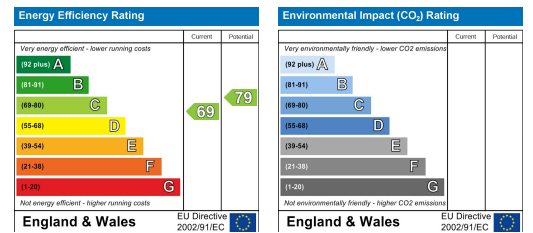

These particulars, whilst believed to be accurate are set out as a general outline only for guidance and do not constitute any part of an offer or contract. Intending purchasers should not rely on them as statements of representation of fact, but must satisfy themselves by inspection or otherwise as to their accuracy. No person in this firm's employment has the authority to make or give any representation or warranty in respect of the property.