

£259,995

BUTTERFLY DRIVE, PAULSGROVE, PO6 4DL



- Three Bedrooms (originally constructed as two double bedrooms)
- Entrance Lobby
- Lounge/Diner
- Fitted Kitchen
- Modern First Floor Bathroom
- Gas Central Heating
- Double Glazed Windows
- Allocated Parking Space
- Enclosed Rear Garden
- Cul-De-Sac Location

Portchester Office

92 West Street Portchester Hampshire PO16 9UQ

Tel: 02392 327 070 | E: tiffany.porchester@fenwicks-estates.co.uk

www.fenwicks-estates.co.uk

Property Reference: P2897

Council Tax Band: B

Score	Energy rating	Current	Potential
92+	A		
81-91	B		91 B
69-80	C	77 C	
55-68	D		
39-54	E		
21-38	F		
1-20	G		

Floor Plans (For illustrative purposes and not drawn exactly to scale)

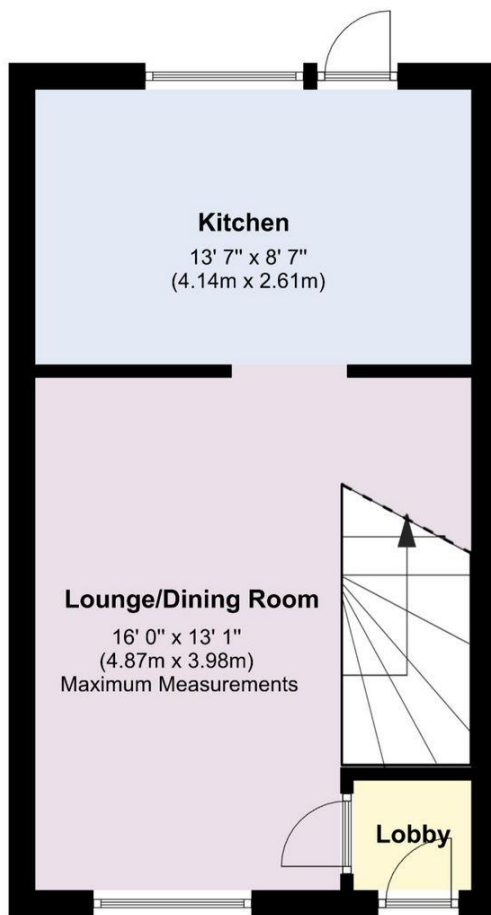

Ground Floor

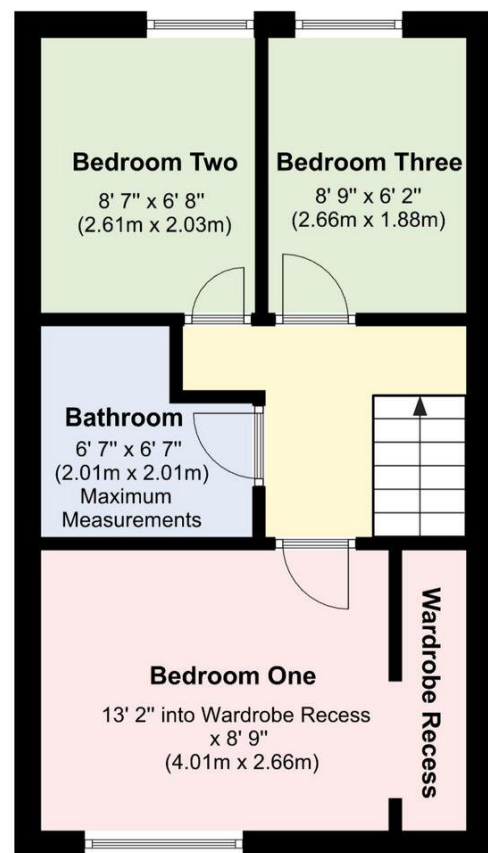

First Floor

Portchester Office

92 West Street Portchester Hampshire PO16 9UQ

Tel: 02392 327 070 | E: tiffany.porchester@fenwicks-estates.co.uk

www.fenwicks-estates.co.uk



The Accommodation Comprises:-

UPVC part double glazed front door with matching side panel leading to:

Entrance Lobby:-

Built-in storage cupboard housing the smart meters, wood effect laminate flooring, textured ceiling. Part glazed internal door to:

Lounge/Dining Room:-

16' 0" x 13' 1" (4.87m x 3.98m) Maximum Measurements

UPVC double glazed window to the front elevation, radiator, return stairs leading to the first floor, TV aerial point, space for a table and chairs if required, wood effect laminate flooring, flat ceiling. Walkway to:



Kitchen:-

13' 7" x 8' 7" (4.14m x 2.61m)

UPVC double glazed window to the rear elevation overlooking the garden, the kitchen is fitted with a range of matching base, eye and larder style storage cupboards with underlighting to the eye level units, roll top work surfaces, one and a half bowl single drainer sink unit inset with extendable mixer tap and part tiled walls, range style cooker to remain with extractor canopy above, recess for American style fridge/freezer, space and plumbing for washing machine and dishwasher, wall mounted gas central heating boiler, textured ceiling. UPVC part double glazed door leading to the garden.



Portchester Office

92 West Street Portchester Hampshire PO16 9UQ

Tel: 02392 327 070 | E: tiffany.porchester@fenwicks-estates.co.uk

www.fenwicks-estates.co.uk

First Floor Landing:-

Textured ceiling with LED spotlights inset. Doors to:

Bedroom One:-

13' 2" into Wardrobe Recess x 8' 9" (4.01m x 2.66m)

UPVC double glazed window to the front elevation, radiator, wardrobe recess with hanging/shelving and textured ceiling with LED spotlights inset.



Bedroom Three:-

8' 9" x 6' 2" (2.66m x 1.88m)

UPVC double glazed window to the rear elevation, radiator and flat ceiling with LED spotlights inset.



Modern Bathroom:-

6' 7" x 6' 7" (2.01m x 2.01m) Maximum Measurements

Modern white suite comprising panelled bath with mixer tap, Mira mains shower and screen, close coupled WC, wash hand basin with mixer tap and vanity storage below, waterproof panelling to the walls, chrome heated towel rail and flat ceiling with extractor.

Bedroom Two:-

8' 7" x 6' 8" (2.61m x 2.03m)

UPVC double glazed window to the rear elevation, radiator, wood effect laminate flooring and flat ceiling with LED spotlights inset.

Portchester Office

92 West Street Portchester Hampshire PO16 9UQ

Tel: 02392 327 070 | E: tiffany.porchester@fenwicks-estates.co.uk

www.fenwicks-estates.co.uk



Outside:-

To the front of the property there is an open plan garden laid to lawn with shrub borders.



Rear Garden:-

Rear pedestrian access and a secure wooden gate leads to the enclosed low maintenance paved rear garden ideal for entertaining purposes with a water tap and storage shed to remain.

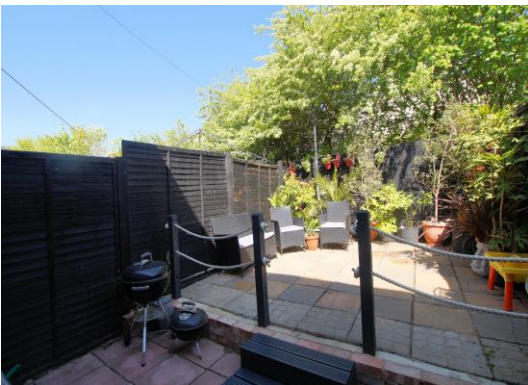

Disclaimer: These particulars are set out as a general outline in accordance with the Consumer Protection from Unfair Trading Regulations 2008 (CPR's) and Business Protection from Misleading Marketing Regulations 2008 (BPR's) only for the guidance of intending purchasers or lessees, and do not constitute any part of an offer or contract. Details are given without any responsibility, and any intending purchasers, lessees or third parties should not rely on them as statements or representations of fact, but must satisfy themselves by inspection or otherwise as to the correctness of each of them.

We have not carried out a structural survey and the services, appliances and specific fittings have not been tested. All photographs, measurements, floor plans and distances referred to are given as a guide only and should not be relied upon for the purchase of carpets or any other fixtures or fittings. Gardens, roof terraces, balconies and communal gardens as well as tenure and lease details cannot have their accuracy guaranteed for intending purchasers. Lease details, service ground rent (where applicable) are given as a guide only and should be checked and confirmed by your solicitor prior to exchange of contracts.

No person in the employment of Fenwicks Estates Ltd has any authority to make any representation or warranty whatever in relation to this property. Purchase prices, rents or other prices quoted are correct at the date of publication and, unless otherwise stated, exclusive of VAT.

Data Protection: We retain the copyright in all advertising material used to market this Property.

Money Laundering Regulations 2017: Intending purchasers will be required to produce identification documentation once an offer is accepted

Your home is at risk if you do not keep up repayments on mortgage or other secured loans.

Portchester Office

92 West Street Portchester Hampshire PO16 9UQ

Tel: 02392 327 070 | E: tiffany.porchester@fenwicks-estates.co.uk

www.fenwicks-estates.co.uk

