



81 Liverpool Road, Bickerstaffe

Ormskirk

£2,350 pcm

# 81 Liverpool Road

Bickerstaffe, Ormskirk

An exceptional detached family home in a sought-after semi-rural Bickerstaffe location, combining countryside surroundings with modern family living. The property offers a welcoming entrance hall, elegant lounge with log-burning stove, and a versatile snug. At its heart is a stylish open-plan kitchen and dining area with premium finishes, central island, and bi-fold doors opening onto the rear garden, creating seamless indoor-outdoor living.

The ground floor also includes a utility room, home office, and flexible fourth bedroom/playroom. Upstairs are three well-proportioned bedrooms, including a principal suite with walk-in wardrobe and countryside views, plus a contemporary family bathroom with freestanding bath.

Externally, the home benefits from a detached garage, ample driveway parking, and an expansive rear garden with patio and lawn, ideal for entertaining and family life.

Council Tax band: E

Tenure: Freehold

- Four Bedroom Detached family residence
- Sought-after semi-rural location
- Grand entrance hallway
- Stunning main lounge
- Impressive open-plan kitchen/diner
- Separate dedicated office space
- Principal suite with dressing room
- Expansive landscaped rear garden
- Detached garage and driveway





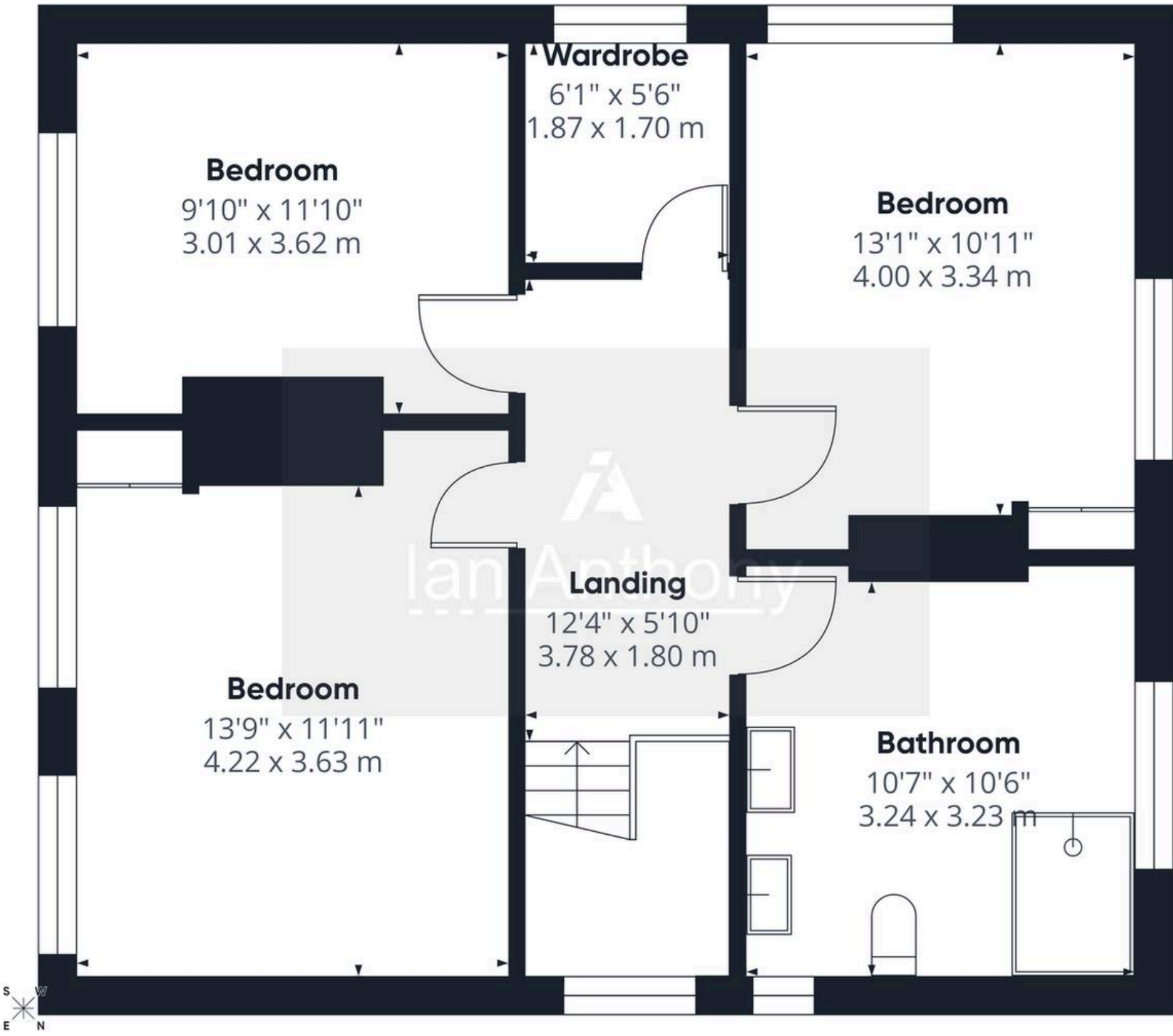

Approximate total area<sup>(1)</sup>

653 ft<sup>2</sup>  
60.8 m<sup>2</sup>

(1) Excluding balconies and terraces

Calculations reference the RICS IPMS 3C standard. Measurements are approximate and not to scale. This floor plan is intended for illustration only.

Floor 1 Building 1



## IAN ANTHONY

5 Burscough Street, Ormskirk - L39 2EG

01695580888

[enquiries@iananthonyestates.co.uk](mailto:enquiries@iananthonyestates.co.uk)

[iananthonyestates.co.uk/](http://iananthonyestates.co.uk/)

