



Central Hill, SE19 | £340,000

020 8702 9333

crystalpalace@pedderproperty.com

pedder
We live local



In General

- Two bedrooms
- Convenient location
- Blank canvas
- Ideal first time or investment purchase
- Communal rear garden

In Detail

A light and bright two bedroom third floor apartment conveniently located nearby the Crystal Palace Triangle.

This neutrally decorated property could make an ideal first time or investment purchase and is ready for a new owner to put their own stamp on. Highlights include large double windows which allow for plenty of light and fresh air, a separate kitchen, and a communal rear garden.

This is certainly a recommended viewing for those seeking a great position, with easy access to a variety of shopping and leisure offerings at the Triangle, and primarily served by both Gipsy Hill and Crystal Palace rail links.

EPC: C | Council Tax Band: B | Lease 102 years remaining | SC: £1,700 | GR: £250 | BI: TBC

1

2

3

4

5

6

7

8

9

10

11

12



Floorplan

Central Hill, SE19

Approximate Gross Internal Area
50.0 sq m / 538 sq ft

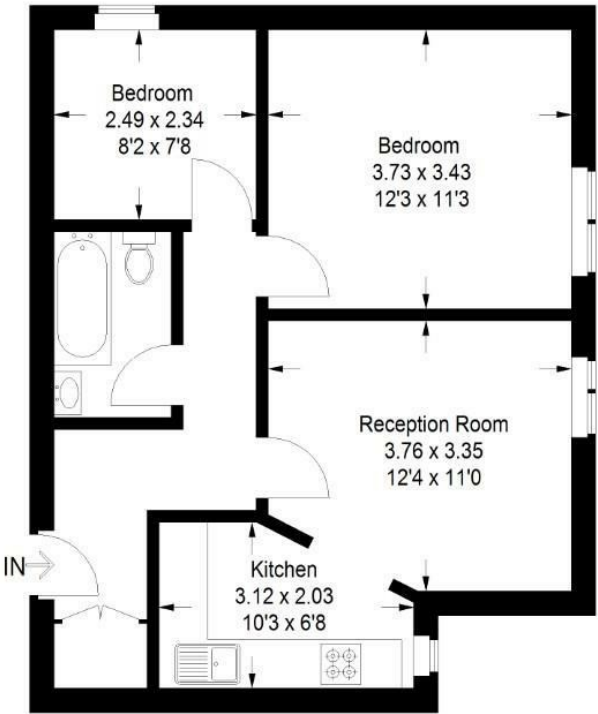

Third Floor

Copyright www.pedderproperty.com © 2025

These plans are for representation purposes only as defined by RICS - Code of Measuring Practice. Not drawn to Scale. Windows and door openings are approximate. Please check all dimensions, shapes and compass bearings before making any decisions reliant upon them.

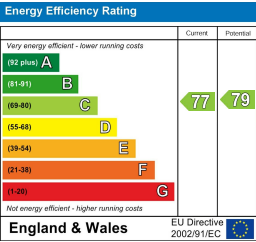

Pedder Property Ltd trading as Pedder for themselves and for the vendor/landlord of this property whose agents they are, give notice that (1) these particulars do not constitute any part of an offer or contract, (2) all statements contained within these particulars are made without responsibility on the part of Pedder or the vendor/landlord, (3) whilst made in good faith, none of the statements contained within these particulars are to be relied upon as a statement of representation or fact, (4) any intending purchaser/tenant must satisfy him/herself by inspection or otherwise as to the correctness of each of the statements contained within these particulars, (5) the vendor/landlord does not make or give either Pedder or any person in their employment any authority to make or give representation or warranty whatsoever in relation to this property.