

# Frank Harris & Co.



**Furnival Street, City of London, EC4A**

**£475,000**

This bright one bedroom flat is located in a small building close to Chancery Lane tube station. With sash windows, an open plan kitchen with integrated appliances, a double bedroom and a shower room. The location benefits from a vibrant choice of restaurants, bars, and cultural venues making this an excellent home for people seeking both connectivity and lifestyle.



The surrounding area offers one of London's most prestigious and historic settings, with St.Pauls Cathedral, Paternoster Square, Dr. Jonhson's House, Ye Olde Cheshire Cheese, One of London's oldest pubs, rebuilt in 1667 after the Great Fire, and the Royal Courts of Justice all within close proximity. Residents benefit from scenic walking routes along the nearby Thames Embankment.

A short walk west is the open space of Lincoln's Inn Fields and the site of the London School of economics. The area is particular noted for its links to the legal profession.

Within walking distance of both the City and the West End. A perfect location, a short walk from Blackfriars station with trains to Gatwick airport, Chancery Lane underground, and Farringdon Station for access to the Elizabeth line.

- One Bedroom Flat • Fifth Floor • Lift Access •
- Quiet Location • No Onward Chain • Close to Chancery Lane •



# Frank Harris & Co.

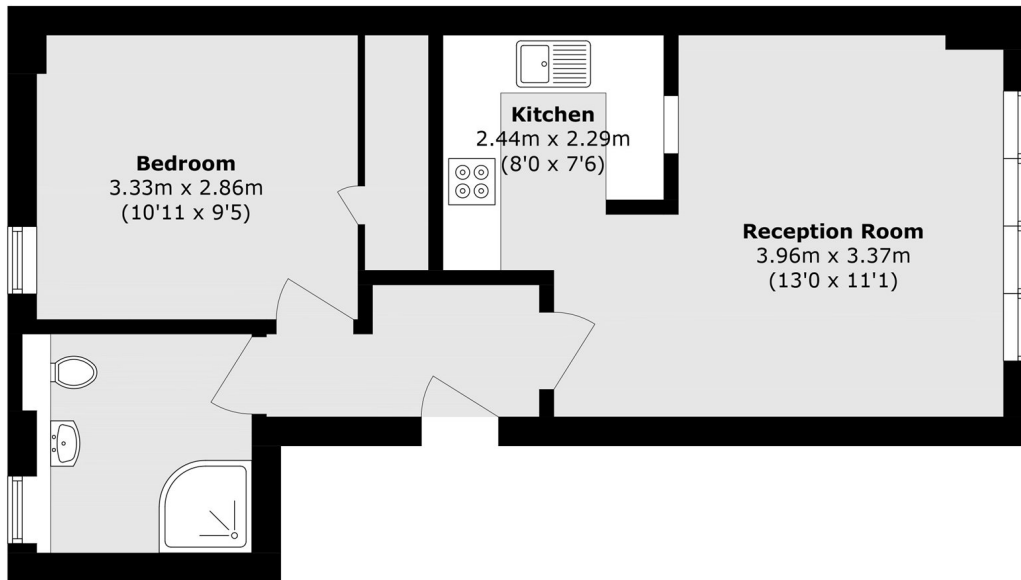

Total area (approx.): 42.6 sq. m (458.5 sq. ft)

Frank Harris & Co. Barbican and City  
87 Long Lane, London,  
EC1A 9ET  
020 7600 7000  
citysales@frankharris.co.uk

Energy Rating: D. We aim to make our particulars both accurate and reliable. However they are not guaranteed; nor do they form part of an offer or contract. If you require clarification on any points then please contact us, especially if you're traveling some distance to view. Please note that appliances and heating systems have not been tested and therefore no warranties can be given as to their good working order.

