



## TIDESIDE COURT, SE18

£1,450 per month

A one bedroom top floor apartment situated within a purpose built development.

Top Floor Apartment  
One Bedroom  
Purpose Built Development

Living/Dining Room  
Kitchen  
Off Road Parking

# STEP INSIDE TIDESIDE COURT

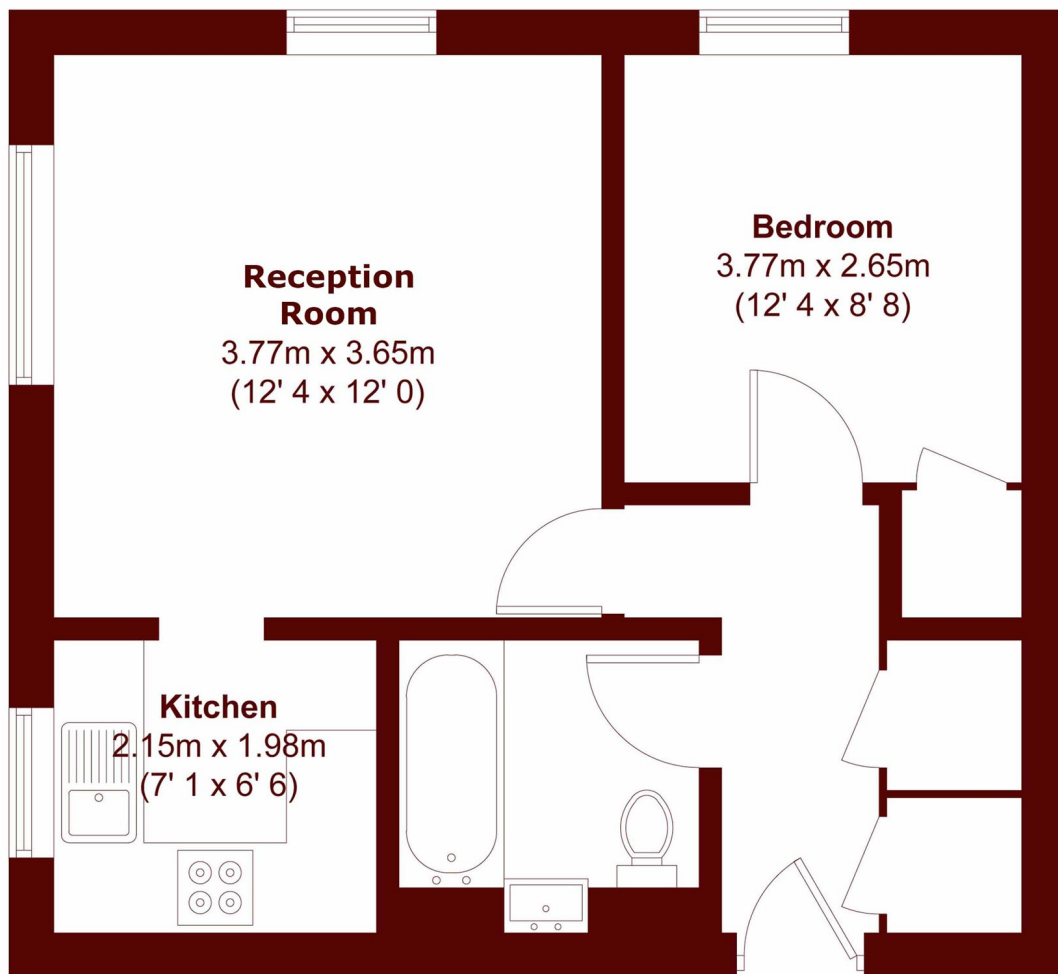

APPROX. GROSS INTERNAL FLOOR AREA  
408 SQFT / 37.9 SQM

Charlton  
020 8296 1628

Energy Rating: B We aim to make our particulars both accurate and reliable. However, they are not guaranteed; nor do they form part of an offer or contract. If you require clarification on any points then please contact us, especially if you're traveling some distance to view. Please note that appliances and heating systems have not been tested and therefore no warranties can be given as to their good working order

MARSH &  
PARSONS