



Hester Terrace, TW9

£995,000

This beautifully presented 1,266 sq ft home offers spacious, well-balanced accommodation over three floors, finished to a high standard and ideal for modern family living. Quietly positioned within a mews development, it combines a peaceful setting with easy access to local amenities, schools, and transport links.

Hester Terrace is ideally positioned near Richmond Park and Royal Botanic Gardens, Kew, offering outstanding access to green space. Commuters benefit from nearby Richmond Station, Kew Gardens Station and North Sheen Station, plus excellent bus links to Central London. The area is also close to well-regarded schools in Richmond Hill and Kew.

Features

- Three Double Bedrooms
- Two Bathrooms
- Modern Kitchen
- Large Private Garden
- Two Allocated Parking Spaces
- No Onward Chain



Hester Terrace, TW9

The ground floor accommodation comprises a welcoming entrance hall, a large modern separate kitchen, and a large rear reception room with sliding doors opening directly onto the rear garden.

On the first floor, the landing provides access to a spacious double bedroom with built-in wardrobes, a second smaller double bedroom, and a contemporary family bathroom. The second floor is dedicated to the principal bedroom suite, featuring built-in wardrobes, Velux windows, and a generous bathroom.

Externally, the property boasts a generous private rear garden, predominantly laid to lawn and complemented by a patio area, perfect for outdoor dining, entertaining, or simply unwinding. To the front, the property benefits from two allocated parking spaces. Additionally, the home features a recently replaced roof, offering added peace of mind for prospective buyers.



Hester Terrace, Kew, TW9

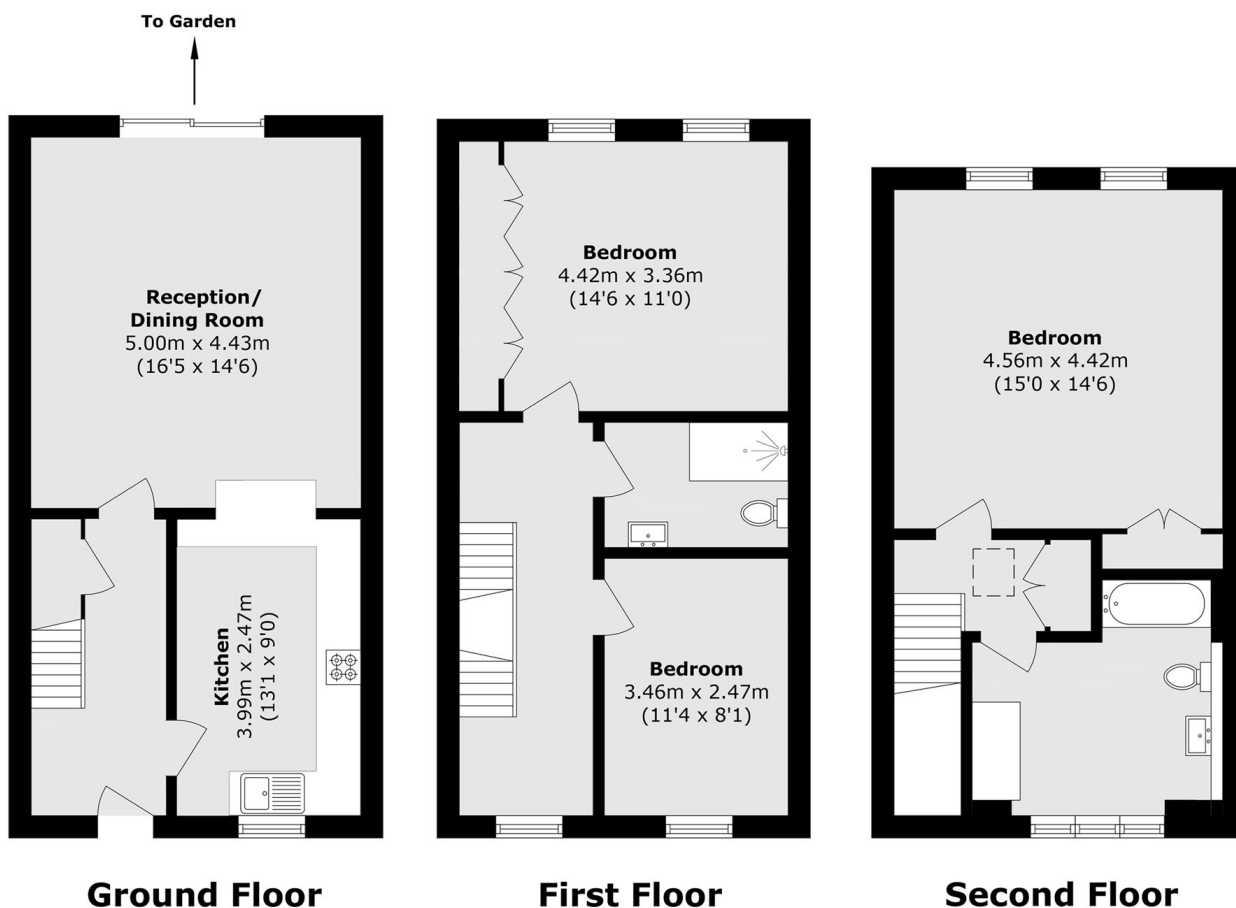

Total area (approx.): 117.7 sq. m (1266.9 sq. ft)