



**Taylor's**

# WALL HEATH VILLAGE, 32 Lynwood Avenue

£375,000

🛏️ 3 🚿 1 🚗 2



The property includes GAS CENTRAL HEATING, UPVC DOUBLE GLAZING and comprises: entrance porch, through reception hall with understairs storage and guests cloakroom/ WC off, generous full depth lounge with 'bay' window and french doors to the rear garden. The kitchen extension includes built in appliances has a utility room and BREAKFAST/ DINING ROOM off. To the first floor are THREE DOUBLE BEDROOMS and a REFITTED FAMILY BATHROOM with separate shower cubicle. The property is set back and further enhanced by the FULL WIDTH DRIVEWAY, which provides ample off road parking and an approach to the GARAGE, which has a rear hall to the garden. The GENEROUS REAR GARDEN, enjoys a sunny and open rear aspect and comprises of a paved patio, extensive lawn and garden 'pergola'. Tenure: FREEHOLD. Construction: standard brick walls and tiled roof. Services: All main services are connected. Broadband/Mobile coverage: Visit: [checker.ofcom.org.uk/en-gb/broadband-coverage](http://checker.ofcom.org.uk/en-gb/broadband-coverage). Flood Risk Assessment: Very Low. Council Tax Band C. EPC B . KINGSWINFORD OFFICE.



Entrance Porch - 2.34m x 0.97m (7'8" x 3'2")

Reception Hall -

WC -

Full Depth Lounge - 8.1m x 3.51m (26'7" x 11'6")

Dining/ Breakfast Room - 3.73m x 2.79m (12'3" x 9'2")

Kitchen - 4.57m x 2.21m (15'0" x 7'3")

Utility Room - 2.18m x 1.32m (7'2" x 4'4")

Bedroom 1 - 4.14m x 3.51m (13'7" x 11'6")

Bedroom 2 - 3.66m x 3.51m (12'0" x 11'6")

Bedroom 3 - 2.79m x 2.64m (9'2" x 8'8")

Bathroom - 2.82m x 1.7m (9'3" x 5'7")

Garage - 4.37m x 3.45m (14'4" x 11'4")





- LARGE TRADITIONAL SEMI DETACHED FAMILY HOME
- EXTENDED
- THREE GENEROUS BEDROOMS
- GROUND FLOOR WC
- FULL DEPTH LOUNGE WITH LOG BURNER
- UTILITY
- REFITTED FAMILY BATHROOM
- FULL WIDTH DRIVEWAY
- GARAGE
- LARGE REAR GARDEN

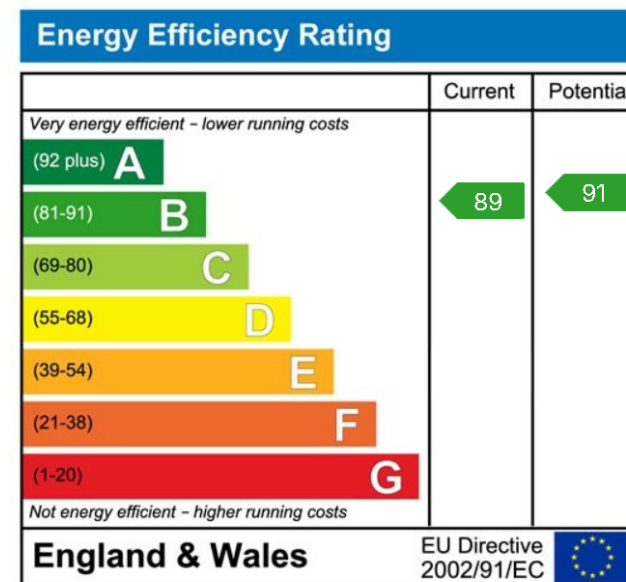
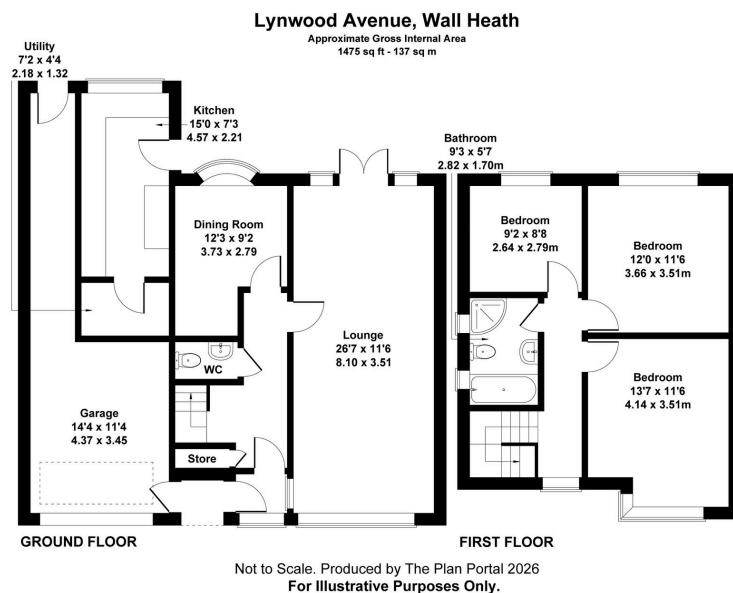

**MISREPRESENTATION ACT 1967:** These particulars do not constitute any part of an offer or a contract. Whilst every care is taken to ensure accuracy, no responsibility for errors or misdescription is accepted. Any intending purchaser must satisfy themselves by inspection or otherwise as to the correctness of each of the statements in these particulars. The vendor does not make nor give, and neither Taylors nor any person in their employment has any authority to make or give any representation or warranty whatsoever about this property. As the seller's estate agents, we are not surveyors or conveyancing experts, and we cannot comment on the property's condition or issues relating to the title or other legal issues that may affect this property unless we have been made aware of such matters. Interested parties should employ professionals to make such enquiries before making transactional decisions. **EPC:** can be supplied free of charge. **CONSUMER PROTECTION REGULATIONS (2008):** These particulars have been prepared with care and approved by the vendors (where possible) but are intended as a guide only, with measurements being approximate and usually the maximum size, which may include alcoves, recesses or otherwise as described, and you must NOT rely on them for any other purpose. The appearance of an item in any photograph does not mean that it forms part of the property or sale price. **FIXTURES AND FITTINGS:** Only those items specifically mentioned in these sales particulars are included in the sale price. Taylors have NOT tested any apparatus, equipment, fixture or fitting and cannot verify they are in working order or fit for their purpose. **PLANNING PERMISSION / BUILDING REGULATIONS:** Any reference to the property being extended, altered or converted in any way does not infer that planning permission or building regulations have been granted or applied for, nor do Taylors accept any responsibility for such not having been obtained. **FLOOR PLAN:** This plan is for illustrative purposes only. The services, systems and appliances shown have not been tested and no guarantee as to their operability or efficiency can be given.