



Mallory Drive, Yaxley Peterborough
£180,000 Freehold

**Sharman
Quinney**

Key Features



- Mid Terraced House
- Two Double Bedrooms
- Lounge/Diner
- Downstairs Cloakroom
- Enclosed Rear Garden

Vacant Mid Terraced Home being sold with No Upward Chain, it would be a Great Investment or a First Time Home, with- in walking distance to the local shops, has easy access to the A1, in brief the accommodation comprises of, Entrance Hall with stairs to the first floor landing and doors to, two piece Downstairs Cloakroom, Kitchen which has a range of base and eye level units, worktop space, single drainer sink unit, built-in gas hob, electric oven, plumbing for washing machine, built-in dishwasher, space for fridge/freezer, Lounge/Diner with French Doors opening out onto the rear garden, First Floor Landing has doors giving access to the Two Double Bedrooms, Bedroom 1 has two built-in double wardrobes, Family Bathroom has a three piece suite, Outside frontage is open plan, Rear Garden is enclosed, non-overlooked, is laid mainly to lawn with a wooden decking providing a



patio seating area, rear gated access to the allocated parking space.

Entrance Hall - 10'9"max x 3'1"max

Downstairs Cloakroom - 6'7" x 3'1"

Fitted Kitchen - 10'1" x 7'5"

Lounge/Diner - 15'5"max x 14'5"max (including understairs recess)

First Floor Landing - 10'1" x 2'8" (excluding stairs)

Bedroom 1 - 14'6"max x 9'max (including wardrobe space)

Bedroom 2 - 14'6"max x 9'4" (l/shaped room)

Family Bathroom - 6'9"max x 7'7"max



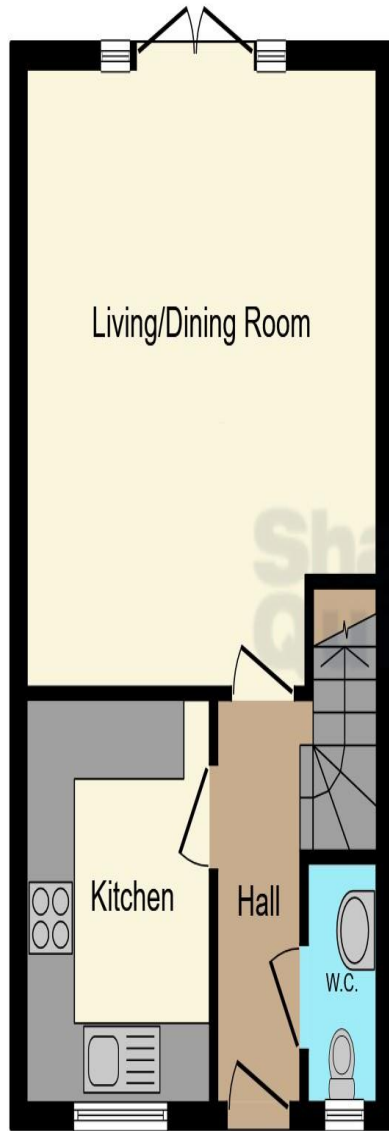

Ground Floor

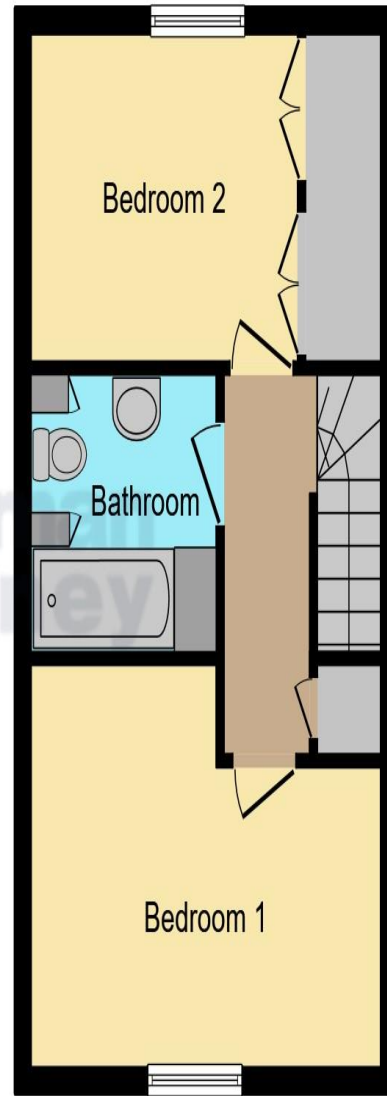

First Floor

This floor plan is for illustrative purposes only. It is not drawn to scale. Any measurements, floor areas (including any total floor area), openings and orientation are approximate. No details are guaranteed, they cannot be relied upon for any purpose and they do not form part of any agreement. No liability is taken for any error, omission or misstatement. A party must rely upon its own inspection(s). Powered by www.focalagent.com

To view this property call Sharman Quinney on:
01733 245400

Selling your property?

Contact us to arrange a **FREE** home valuation.

 01733 245400

 Unit 19 Maltings Square, Broadway Shopping Centre, Yaxley, PE7 3EW

 yaxley@sharmanquinney.co.uk

 www.sharmanquinney.co.uk



 SCAN ME



Sharman Quinney Holdings Limited is registered in England and Wales under company number 4174227, Registered Office is Cumbria House, 16-20 Hockliffe Street, Leighton Buzzard, Bedfordshire, LU7 1GN. VAT Registration Number is 500 2481 05.

1: These particulars do not constitute part or all of an offer or contract. 2: The measurements indicated are supplied for guidance only and as such must be considered incorrect. 3: Potential buyers are advised to recheck the measurements before committing to any expense. 4: Sharman Quinney has not tested any apparatus, equipment, fixtures, fittings or services and it is the buyers interests to check the working condition of any appliances. 5: Sharman Quinney has not sought to verify the legal title of the property and buyers must obtain verification from their legal representative. 6: Intending purchasers will be asked to produce identification documentation at a later stage and we would ask your co-operation in order that there will be no delay in agreeing the sale. Ref: YAX203150 - 0003

