

Alma Street, Gosport,  
Hampshire, PO12 3HS

£200,000



Middle Terraced House

Two Bedrooms

Double Glazing Conservatory

PVCu Double Glazing

An Ideal First Time Purchase Or  
Investment Property

Renovated & Improved

Open Plan Living Area

First Floor Bathroom

Gas Central Heating

**023 9258 5588**

6 Stokesway, Stoke Road, Gosport, Hants, PO12 1PE

Email: [office@dimon-estate-agents.co.uk](mailto:office@dimon-estate-agents.co.uk)

To view all our properties visit:

[www.GosportProperty.com](http://www.GosportProperty.com)

### Ground Floor

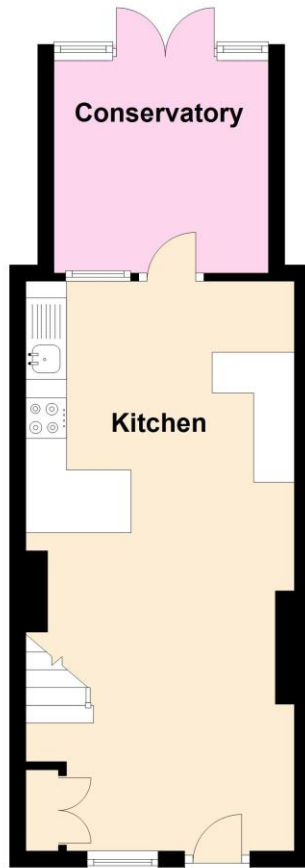

### First Floor

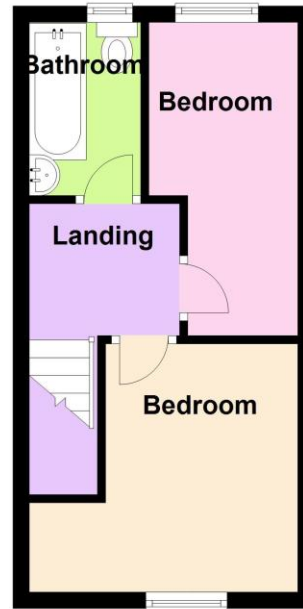

**SELLING YOUR OWN PROPERTY IN GOSPORT?  
WE ARE A FAMILY RUN BUSINESS SELLING HOMES IN GOSPORT FOR 55 YEARS  
AND WOULD WELCOME THE OPPORTUNITY TO BE CHOSEN AS YOUR ESTATE AGENT**

Open Plan Living Area

22'8" (6.91m) x 10'10" (3.3m) PVCu double glazed window, glazed timber door, stairs to first floor, laminate flooring, part exposed brick feature.

Kitchen Area

Fitted with a range of wall and base units, single drainer stainless steel sink, built in oven and ceramic hob with extractor canopy over, plumbing for washing machine, recess for fridge/freezer, tiled splashbacks, PVCu double glazed door to:

Conservatory

8'11" (2.72m) x 8'5" (2.57m) PVCu double glazed French doors and windows, polycarbonate roof, tiled floor, electric panel heater.

## ON THE 1ST FLOOR

Landing

Access to loft space.

Bedroom 1

10'4" (3.15m) x 8'2" (2.49m) PVCu double glazed window, radiator.

Bedroom 2

12'2" (3.71m) x 6'0" (1.83m) Max PVCu double glazed window, radiator.

Bathroom

White suite of panelled bath with mixer tap and shower attachment, vanity hand basin, low level W.C., PVCu double glazed window, radiator, tiled walls, part exposed brick feature.

## OUTSIDE

Rear Garden

Laid to artificial grass, borders and section laid to gravel.

Services

We understand that this property is connected to mains gas, electric, water and sewage.

Tenure

Freehold.

Council Tax

Band B.

Property Information

For information on broadband speed and mobile phone coverage for this property visit: <https://checker.ofcom.org.uk>



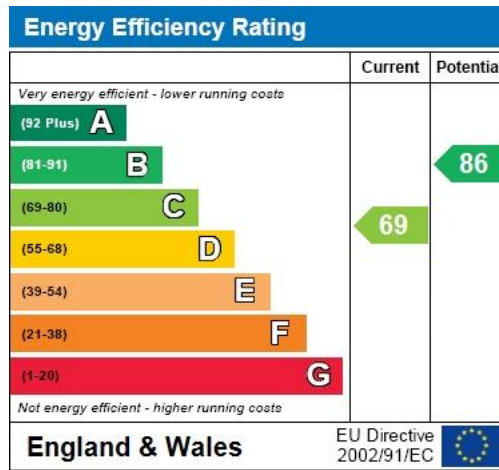

Full Energy Performance Certificate  
available upon request

### Appointment

Date:

Time:

Person Meeting:

### Viewing Notes

These particulars, whilst believed to be accurate, are set out as a general outline for guidance and do not constitute any part of an offer or contract. Please note we have not tested any apparatus, fixtures, fittings, or services. Interested parties must undertake their own investigation into the working order of these items.

All measurements are approximate. Floor Plans are obtained from a third party and may contain inaccuracies. Photographs are for guidance only and may change over the course of marketing. Information provided on lease terms, maintenance and ground rent have been provided by the vendor and you should ask your legal representative to confirm this information before exchanging contracts.