



**4 Buttermere Close, Melton Mowbray,
Leicestershire, LE13 0LT**

£120,000

Shouler & Son
Land & Estate Agents, Valuers & Auctioneers

**4 Buttermere Close
Melton Mowbray
Leicestershire
LE13 0LT**

A chain-free first-floor apartment on the fringes of Melton Mowbray.

Features include spacious open-plan living, two bedrooms (master with EN-SUITE), and allocated parking. A great opportunity for first-time buyers or investors. Must be viewed!



Living Room



Kitchen



Bedroom



En-suite

Description

Welcome to this two-bedroom first-floor apartment, a fantastic opportunity for a first-time buyer or investor. Offered with no onward chain, this property provides a smooth and stress-free buying process. Located on the fringes of Melton Mowbray, the apartment is perfectly positioned for those who value easy access to local amenities while benefiting from a quieter, more residential setting.

The heart of this home is the spacious living room, which flows seamlessly into the modern kitchen, creating a bright and sociable open-plan area. The kitchen is well-appointed with a range of wall and base units and space for appliances, making it a practical and functional space.

The apartment offers two good-sized bedrooms. The principal bedroom is a genuine highlight, featuring the convenience of its own private en-suite shower room. A separate family bathroom with a full-size bath serves the second bedroom and guests. The property benefits from an electric heating system and double-glazed windows throughout, ensuring a comfortable and energy-efficient living environment.

Outside, residents can enjoy the well-kept communal gardens, which provide a pleasant outdoor space. The property also comes with an allocated parking space and additional visitor parking, a significant advantage in this sought-after area.

This apartment is an excellent opportunity to acquire a well-presented, chain-free property in a highly desirable and connected location.

AGENTS NOTE

There are additional costs associated with this property by way of an annual ground rent of £298.62 payable to Estates and Management and a monthly service charge of £182.28 payable to Premier Estates. The lease is 155 years from 01/07/2004.

Ground Floor

Approx. 63.7 sq. metres (685.6 sq. feet)

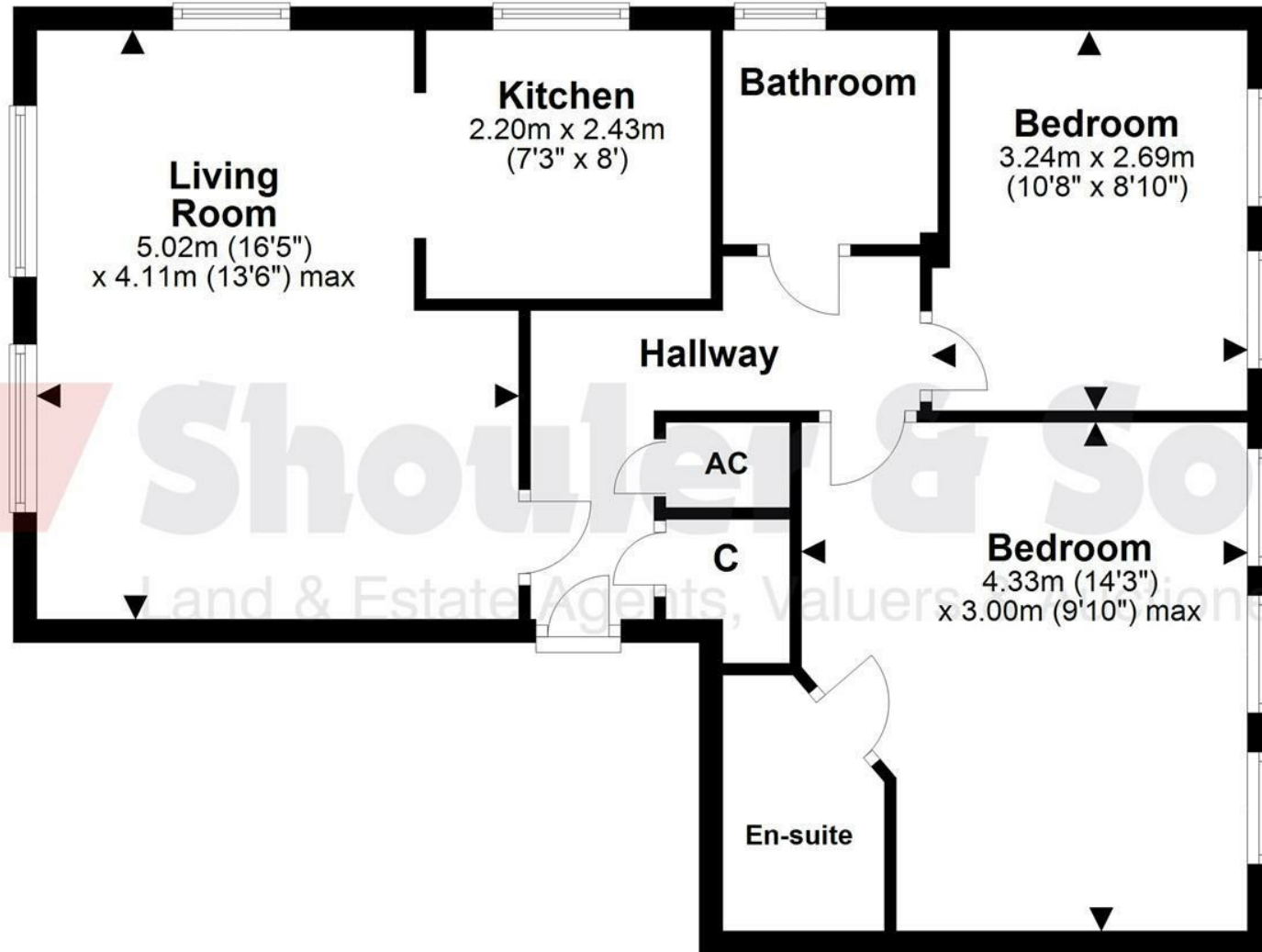

DISCLAIMER: Please note that this floorplan is for marketing purposes and this is to be used as a guide only.
Plan produced using PlanUp.

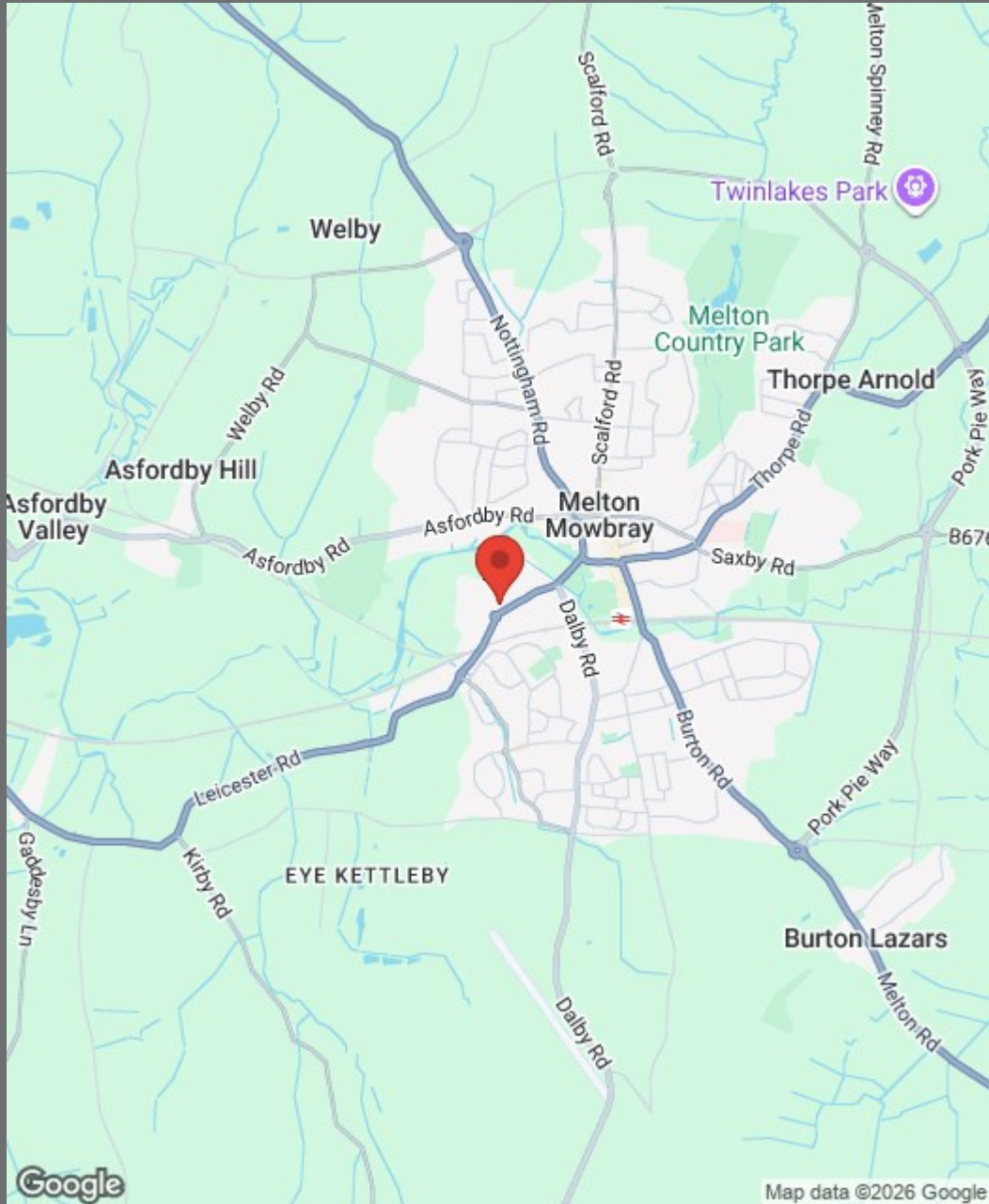

- No Onward Chain
- First-floor apartment
- Spacious open-plan living room
- Two bedrooms, master with en-suite
- Electric heating system
- Double glazed windows
- Allocated parking space
- Communal gardens
- Close to local amenities on the town's fringes
- Ideal for first-time buyers or investors



trend.simple.reap



County Chambers, Kings Road,
Melton Mowbray, Leicestershire LE13 1QF

www.shoulers.co.uk
salesenquiries@shoulers.co.uk

Tel: 01664 560181

Land & Estate Agents, Valuers & Auctioneers

We produce property particulars in good faith and believe them to be correct. We generally rely on what we are told without obtaining proof. You should verify for yourself such information before entering into a contract to take this property. Neither Shouler & Son nor their clients guarantee accuracy of the particulars, and they are not intended to form any part of a contract. No person in the employment of Shouler & Son has authority to give any representation or warranty in respect of this property.