



**POOLE  
TOWNSEND**

# Woodhouse Lane, Heversham, LA7 7EW

Offers In Region Of £385,000

🛏️ 2 🚿 1 🚗 1



- Semi Detached Bungalow
- 2 Bedrooms
- Low Maintenance Gardens
- Popular Residential Area
- Tenure: Freehold
- Light & Airy Accommodation
- Integral Garage & Off Road Parking
- No Chain
- Village Amenities
- Council Tax Band: D



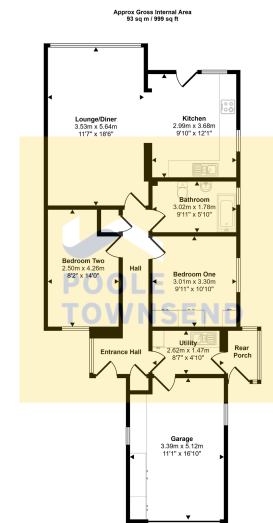

Floorplan  
This blueprint is only for illustrative purposes and is not to scale. Measurements of rooms, doors, windows, and any items are approximate and no responsibility is taken for any errors, omissions or mis-statements. Sizes of beds shown in bedrooms unless otherwise stated are approximate only and may not look like the real items. Made with Make Shippy 360.

Enjoying a peaceful position alongside open fields, this superb true bungalow offers spacious, light-filled accommodation throughout. Thoughtfully arranged on a single level, the centrally heated property comprises a generous lounge/diner with views over the main garden and fields, that flows seamlessly into a well-equipped kitchen, which features glazed doors opening out to a patio and the garden. There are two well-proportioned bedrooms, a modern fully tiled bathroom, and a handy utility room with access to the integral garage and side porch. Externally, the bungalow offers off-road parking for two to three cars, as well as low-maintenance patio gardens surrounding the property. This is an ideal home for couples, families, or those looking to downsize without compromising on space. No chain.

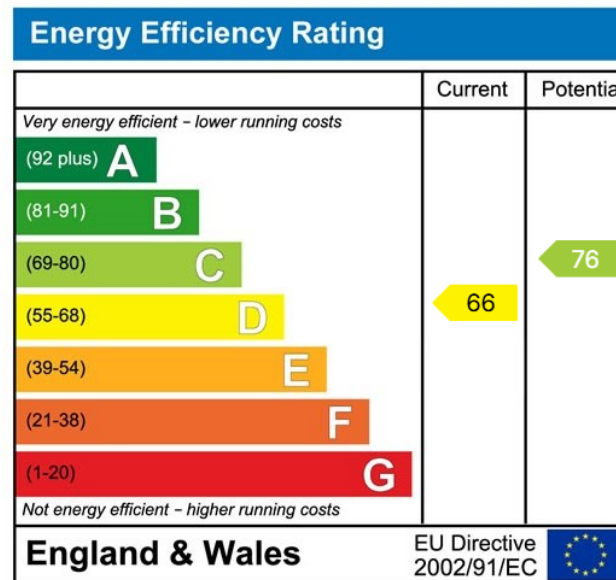

Visit us at  
[www.pooletownsend.co.uk](http://www.pooletownsend.co.uk)  
[enquiries@pooletownsend.co.uk](mailto:enquiries@pooletownsend.co.uk)

We are open  
 Monday – Friday 9.00 – 5.00  
 Saturday 9.00 – 1.00

Barrow 01229 811811  
 Ulverston 01229 588111  
 Grange 015395 33316  
 Kendal 01539 734455  
 Milnthorpe 015395 62044