



South Road,

£260,000

FOR SALE



- Over 55s complex
- Two double bedrooms
- Allocated parking space
- Private South facing garden
- Guest room available
- Gym/Hydro Pool room

THE PROPERTY

This small complex of luxurious style properties are marketed towards those 55 and over. Offering a unique twist to age restricted estates, there is a lot on offer.

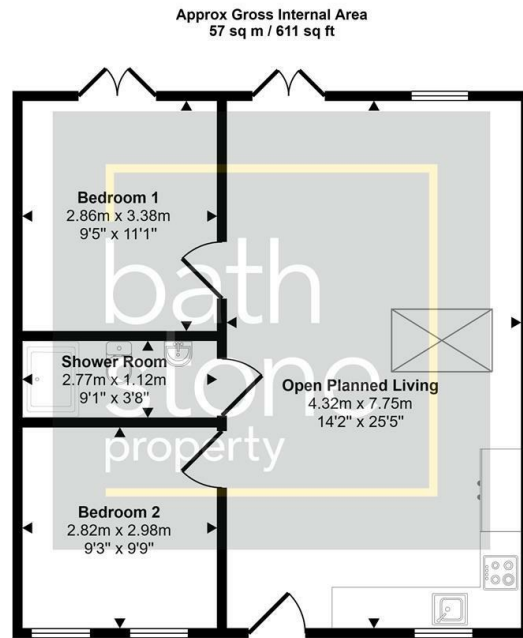

Floorplan

This floorplan is only for illustrative purposes and is not to scale. Measurements of rooms, doors, windows, and any items are approximate and no responsibility is taken for any error, omission or mis-statement. Icons of items such as bathroom suites are representations only and may not look like the real items. Made with Made Snappy 360.



Energy Efficiency Rating		Current	Potential
Very energy efficient - lower running costs			
(92 plus) A			
(81-91) B			
(69-80) C			
(55-68) D			
(39-54) E		46	46
(21-38) F			
(1-20) G			
Not energy efficient - higher running costs			
England & Wales		EU Directive 2002/91/EC	