



CROFTS ESTATE AGENTS

PASSIONATE ABOUT PROPERTY

CLEETHORPES
01472 200666

IMMINGHAM
01469 564294

LOUTH
01507 601550

SALES LETTINGS NEW HOME SALES LAND PROPERTY MANAGEMENT AUCTIONS FINANCIAL ADVICE AND MORTGAGES ENERGY PERFORMANCE PROVIDER



Parklands Avenue

Humberston
DN36 4FY

Offers in the Region Of £269,950

CLEETHORPES: 62 St Peters Avenue, Cleethorpes, DN35 8HP

IMMINGHAM: 21 Kennedy Way, Immingham, DN40 2AB

LOUTH: 3 Market Place, Louth, LN11 9NR

Email: Cleethorpes:

Email: Immingham :

Email: Louth :

info@croftsestateagents.co.uk

immingham@croftsestateagents.co.uk

louth@croftsestateagents.co.uk

www.croftsestateagents.co.uk



Property Introduction

Crofts Estate Agents are thrilled to present this impressive four-bedroom detached family home, occupying a generous plot with open green views to the front. Stylishly presented in neutral tones, the property offers a warm and welcoming feel throughout, complete with gas central heating and uPVC double glazing. Step inside to a spacious entrance hallway leading to a versatile office/study, a bright and comfortable lounge, a modern open-plan dining kitchen, handy utility room, and a cloakroom. Upstairs, a light-filled landing gives access to four well-proportioned bedrooms, including a main bedroom with en-suite shower room, plus a contemporary family bathroom. Outside, the home enjoys an open-plan frontage with uninterrupted views across the green, while the rear boasts a superb enclosed garden – perfect for entertaining or soaking up the sunshine with its desirable southerly aspect. A private driveway and detached garage complete this fantastic package. This is a wonderful opportunity to secure a beautifully balanced family home in a sought-after setting – early viewing is highly recommended!

Entrance Hallway

Offering composite entry door to the front elevation. Central heating radiator. Staircase to the first floor. LVT flooring.

Office/Study

9' 10" x 10' 8" (2.992m x 3.256m)

A versatile space with uPVC double glazed window to the front elevation. Central heating radiator.

Lounge

13' 3" x 10' 9" (4.048m x 3.273m)

Neutrally decorated and having uPVC double glazed window to the front elevation. Central heating radiator.

Kitchen/Diner

9' 5" x 20' 1" (2.876m x 6.130m)

A well proportioned kitchen diner which has a uPVC double glazed window to the rear elevation and uPVC double glazed French doors to the rear. Fitted with a range of wall and base units with complementary work surfacing over with inset one and a half sink and drainer. Integrated oven and four ring gas hob with chimney extractor over. Plumbing for a dishwasher. Space for a larger fridge freezer. Central heating radiator. Down lighting to the ceiling. Ample space to accommodate a dining table and chairs.

Utility

6' 1" x 5' 3" (1.866m x 1.589m)

Offering composite entry door to the rear elevation, the utility has wall and base units with complementary work surfacing with space beneath for a washer and dryer. Wall mounted gas boiler. Fitted extractor fan.

Cloakroom

3' 0" x 5' 3" (0.910m x 1.612m)

uPVC double glazed window to the side elevation. Fitted with a w.c and wash hand basin. Splashback tiling. Central heating radiator.

First Floor Landing

uPVC double glazed window to the side elevation. Loft access to the ceiling. Storage cupboard.

Family Bathroom

6' 6" x 8' 2" (1.985m x 2.487m)

Offering uPVC double glazed window to the rear elevation, the family bathroom is equipped with a pedestal wash hand basin, close coupled w.c and a panelled bath with shower and screen over. Splashback tiling. Central heating towel radiator.

Bedroom One

11' 5" x 10' 10" (3.488m x 3.301m)

uPVC double glazed window to the rear elevation and having central heating radiator.

Ensuite

6' 5" into shower x 6' 1" (1.967m x 1.866m)

uPVC double glazed window to the rear elevation. Fitted with a pedestal wash hand basin, close coupled w.c and a shower cubicle. Fitted extractor fan. Central heating towel radiator.

Bedroom Two

11' 7" x 8' 1" min (3.519m x 2.468m)

Neutrally decorated and having uPVC double glazed window. Central heating radiator.

Bedroom Three

9' 10" x 9' 2" (3.003m x 2.790m)

uPVC double glazed window to the front elevation. Central heating radiator.

Bedroom Four

8' 3" x 7' 11" (2.507m x 2.407m)

uPVC double glazed window to the front elevation. Central heating radiator.

Outside

Set upon this good sized plot with open frontage facing the green, this lovely home is ideal for the family market. The rear garden

enjoys a sunny facing aspect and has a good sized expanse of lawn along with a small patio area. Gated access out to the front. To the rear of the property there is also off road parking and a detached garage.

Garage

Detached garage located to the rear of the property with up and over door.

Tenure

Believed to be Freehold, awaiting solicitors' formal confirmation. All interested parties are advised to make their own enquiries.

Services

All mains services are understood to be connected, however Crofts have not inspected or tested any of the services or service installations & purchasers should rely on their own survey.



GROUND FLOOR
53.5 sq.m. (576 sq.ft.) approx.

1ST FLOOR
53.5 sq.m. (576 sq.ft.) approx.

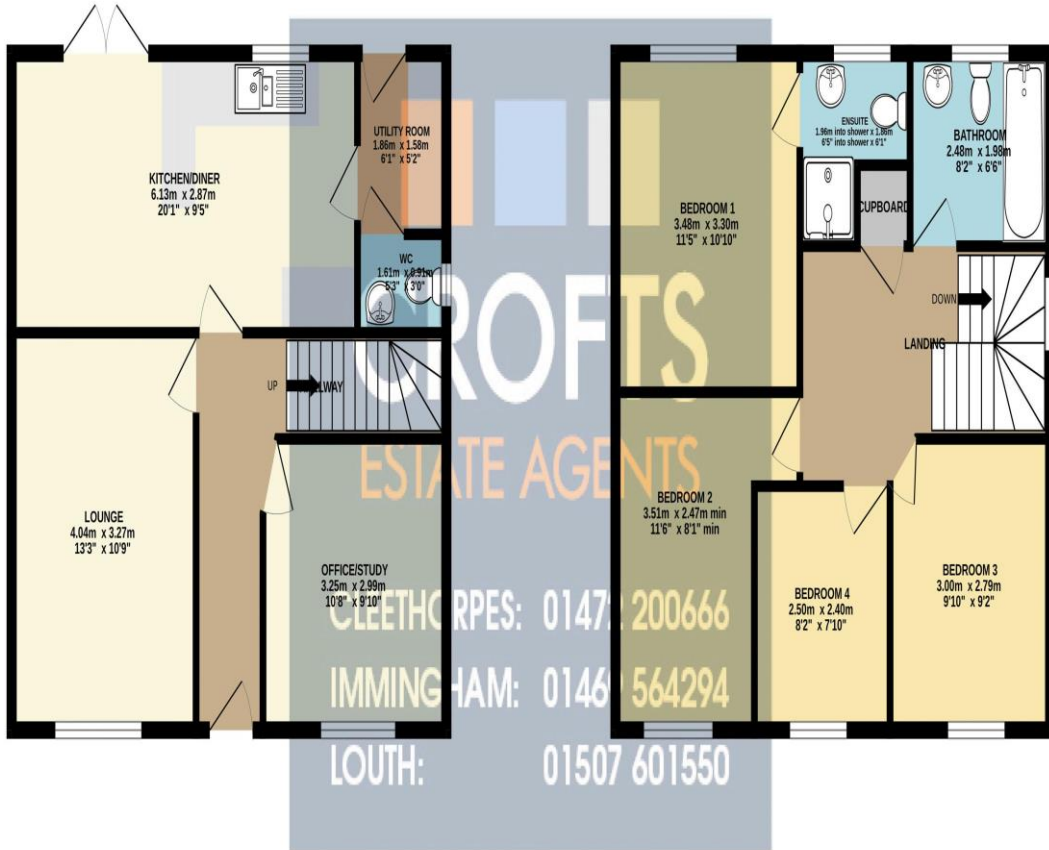

TOTAL FLOOR AREA: 107.1 sq.m. (1153 sq.ft.) approx.

Whilst every attempt has been made to ensure the accuracy of the floorplan contained here, measurements of doors, windows, rooms and any other items are approximate and no responsibility is taken for any error, omission or mis-statement. This plan is for illustrative purposes only and should be used as such by any prospective purchaser. The services, systems and appliances shown have not been tested and no guarantee as to their operability or efficiency can be given.
 Made with Metropix ©2025

Score	Energy rating	Current	Potential
92+	A		93 A
81-91	B	83 B	
69-80	C		
55-68	D		
39-54	E		
21-38	F		
1-20	G		

DISCLAIMER - IMPORTANT NOTICE REGARDING SALES PARTICULARS Although we have taken great care to insure the accuracy of the information contained in these particulars, we specifically deny liability for any mistakes, omissions or errors and strongly advise that all proposed purchasers should satisfy themselves by inspection or otherwise, as to their correctness, prior to entering into any commitment to purchase. In particular any information provided in respect of tenure, council tax, rateable values etc has been given in good faith and whilst believed to be correct, may be subject to amendment. Any references to the condition, use or appearance of the property are made for guidance only, and no warranties are given or implied by this information. It is not Crofts policy to check the position with regards to any planning permission or building regulation matters and as such all interested parties are advised to make their own enquires, in order to ensure that any necessary consents have been obtained. All measurements are approximate and are for guidance only and cannot be relied upon. Measurements are taken from wall to wall unless otherwise stated, with the metric conversion shown in brackets. Any plans or maps contained are for identification purpose only, and are not for any other use but guidance & illustration. Crofts have not tested any apparatus, equipment, fixtures, fittings or services including central heating systems and cannot therefore verify that they are in working order, or fit for their intended purpose. These details do not form any part of any contract, and unless specifically stated otherwise, furnishings and contents are not included within this sale.