



8 Camp Drive, Houghton Regis, Dunstable, LU5 5HE

This spacious three bedroom family home is available to rent and is ideally located in a quiet cul-de-sac in Houghton Regis, just a short walk from Bedford Square and its range of shops and local amenities.

The property offers generous living accommodation including an entrance hall, a bright lounge/diner, fitted kitchen, and a conservatory overlooking the rear garden. Upstairs, there are three large double bedrooms and a family bathroom, making it perfectly suited for families.

Outside, the home benefits from front and rear gardens, a good sized rear garden ideal for children and outdoor entertaining, as well as a garage for additional storage or parking.

Conveniently located within walking distance of local schools, the library, doctors, dentist, and nearby shops. Excellent transport links are close by, including the Woodside Link Road, Junction

- Nova Estate Agents
- Press Play Button For 360° Walkaround Tour
- 3 Large Bedrooms
- Available Now!
- Walking Distance to Bedford Square
- Conservatory
- Large Rear Garden
- Garage

£1,500 Per month

Approx Gross Internal Area
88 sq m / 951 sq ft

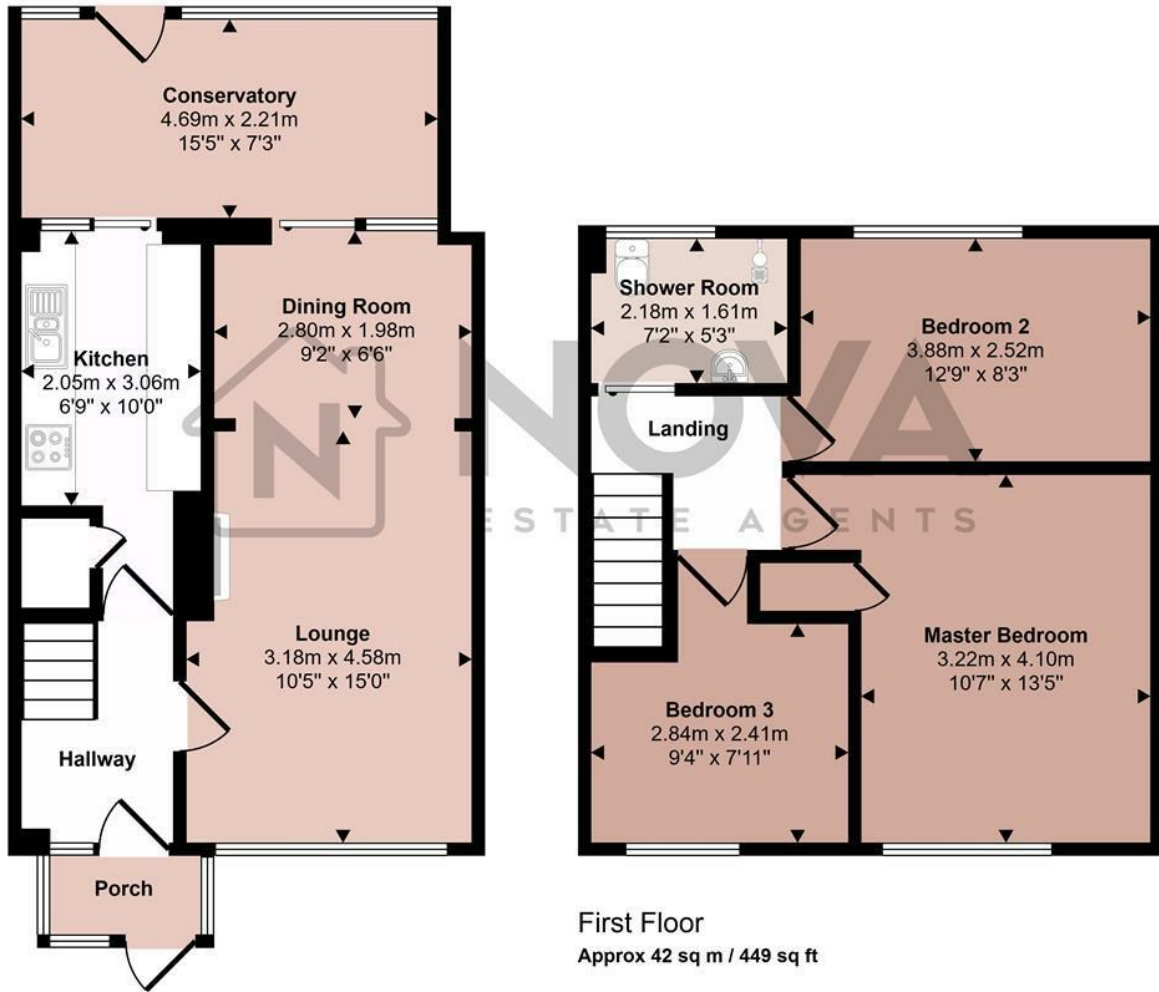

This floorplan is only for illustrative purposes and is not to scale. Measurements of rooms, doors, windows, and any items are approximate and no responsibility is taken for any error, omission or mis-statement. Icons of items such as bathroom suites are representations only and may not look like the real items. Made with Made Snappy 360.

Energy Efficiency Rating		Current	Potential
Very energy efficient - lower running costs			
(92 plus) A			
(81-91) B			
(69-80) C			
(55-68) D			
(39-54) E			
(21-38) F			
(1-20) G			
Not energy efficient - higher running costs			
England & Wales	EU Directive 2002/91/EC	71	85