



## Richmond Road, KT2

£240,000

A great opportunity to purchase this centrally located ground floor studio apartment with the unusual benefit of its own entrance as well as a good sized private West facing rear garden as well as a lovely lawned communal garden beyond. Located on the Richmond Road and just 350 yards to Canbury Gardens and the river Thames, this is a great first time purchase, investment or Pied-a- terre.

The location of this wonderful studio, is perfect to enjoy everything Kingston has to offer being just 350 yards to Canbury Gardens and the river Thames and just over 500 yards to Kingston Town Centre and Mainline Station.

### Features

- Private Entrance
- Large Studio Room
- Private Garden
- No Onward Chain
- Excellent Location
- Additional Communal Garden

# Richmond Road, Kingston Upon Thames, KT2

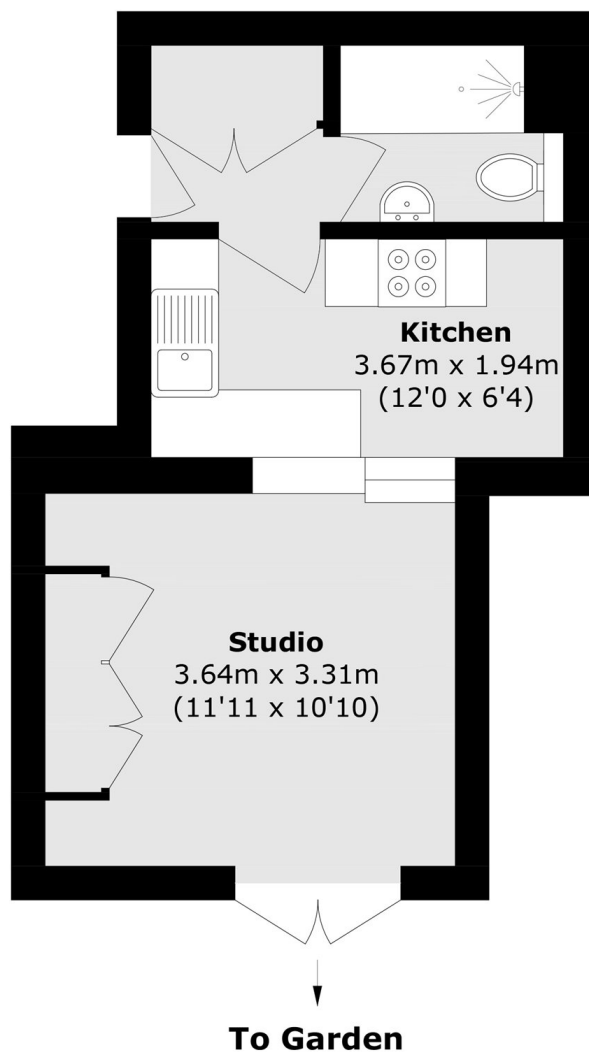

Total area (approx.): 26.6 sq. m (286.3 sq. ft)