



5 Highfield Grove, Corby, NN17 1EW



£200,000

Situated within a quiet and established grove in the popular Lloyds area of Corby, this well-presented end-of-terrace home offers an excellent combination of comfort, style, and convenience. Ideally positioned close to West Glebe Park, along with local shops, amenities, and well-regarded schools, the property is perfectly suited to modern living.

The accommodation is thoughtfully arranged, comprising a welcoming entrance hall, a spacious and versatile living/dining room, a contemporary fitted kitchen, and a stylish ground floor bathroom. To the first floor, there are three well-proportioned bedrooms, all offering comfortable and flexible living space.

Externally, the property benefits from a private driveway providing off-road parking, along with well-maintained gardens that create an attractive outdoor setting. Further advantages include uPVC double glazing and gas central heating, ensuring comfort and efficiency throughout.

This is a superb opportunity to acquire a move-in ready home in a desirable and well-connected location, ideal for first-time buyers, families, or investors alike. Early viewing is highly recommended.



- NO ONWARD CHAIN
- OFF ROAD PARKING FOR MULTIPLE VEHICLES
- LARGE FRONT AND REAR GARDEN.
- CLOSE TO ALL AMENITIES AND SCHOOLING.
- CONTEMPORARY LIVING
- REFURBISHED SHOWER ROOM.
- POPULAR LOCATION

LOUNGE

10'10" x 15'1" (3.32 x 4.62)

KITCHEN

8'0" x 9'5" (2.44 x 2.89)

BEDROOM ONE

8'8" x 15'1" (2.66m x 4.62m)

BEDROOM TWO

10'0" x 7'3" (3.07m x 2.23m)

BEDROOM THREE

7'10" x 7'3" (2.41m x 2.23m)













Ground Floor

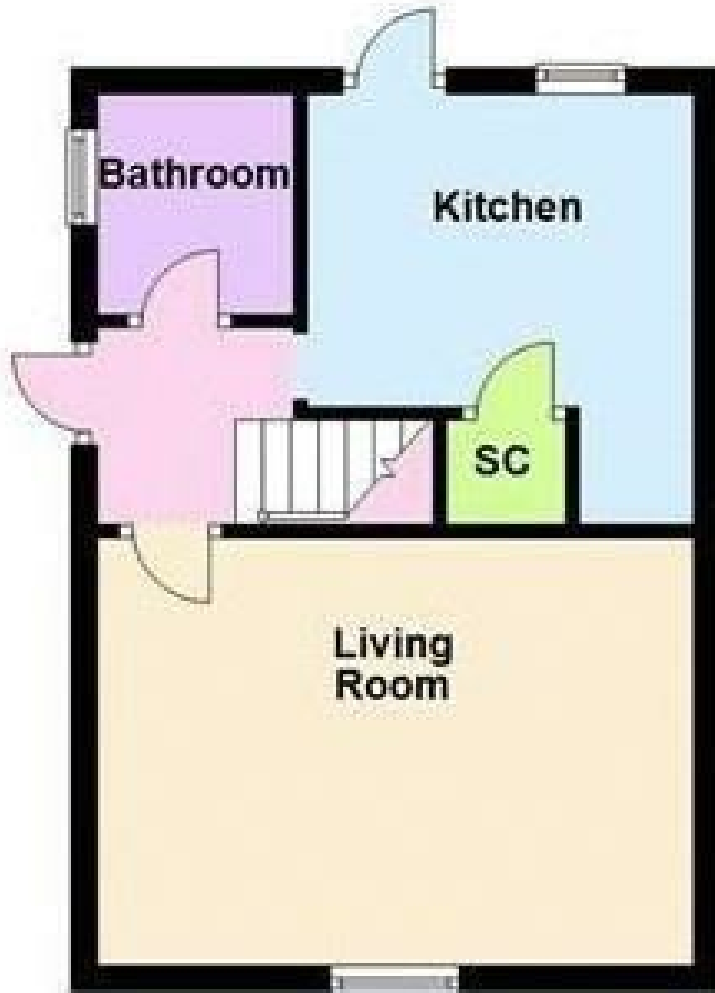

First Floor

