



Mildmay Road, Stevenage, SG1 5RR

Geoffrey Matthew Property Management are delighted to offer for let this one bedroom 1st floor flat situated in Martins Wood close to the The Oval Stevenage. The proper offers fitted kitchen, bathroom with Shower over bath. The bedroom will accommodate a double bed and has a recessed cupboard with hanging rail and shelving. The Lounge is light and spacious.

A holding deposit equivalent to one weeks rent is payable to apply for this property.

£995 Per Calendar Month

Mildmay Road, Stevenage, SG1 5RR

 1

 1

 1

 C

- One Bed Flat
 - Family Bathroom
- Martinswood Area
 - Fitted Kitchen
- Double Bedroom

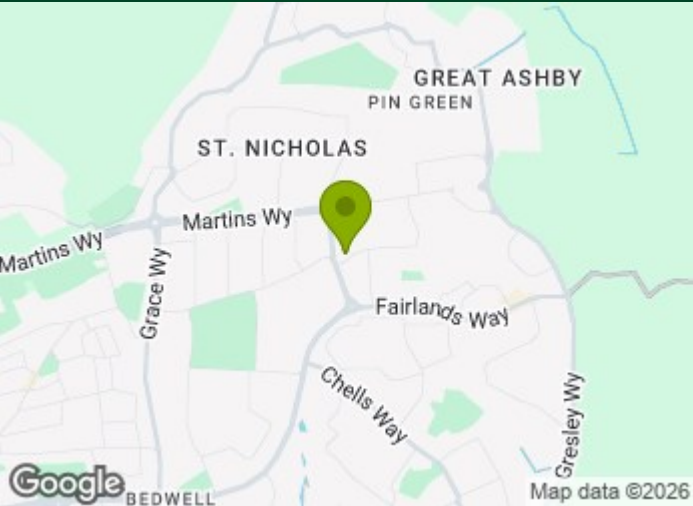

[Directions](#)



Floor Plan

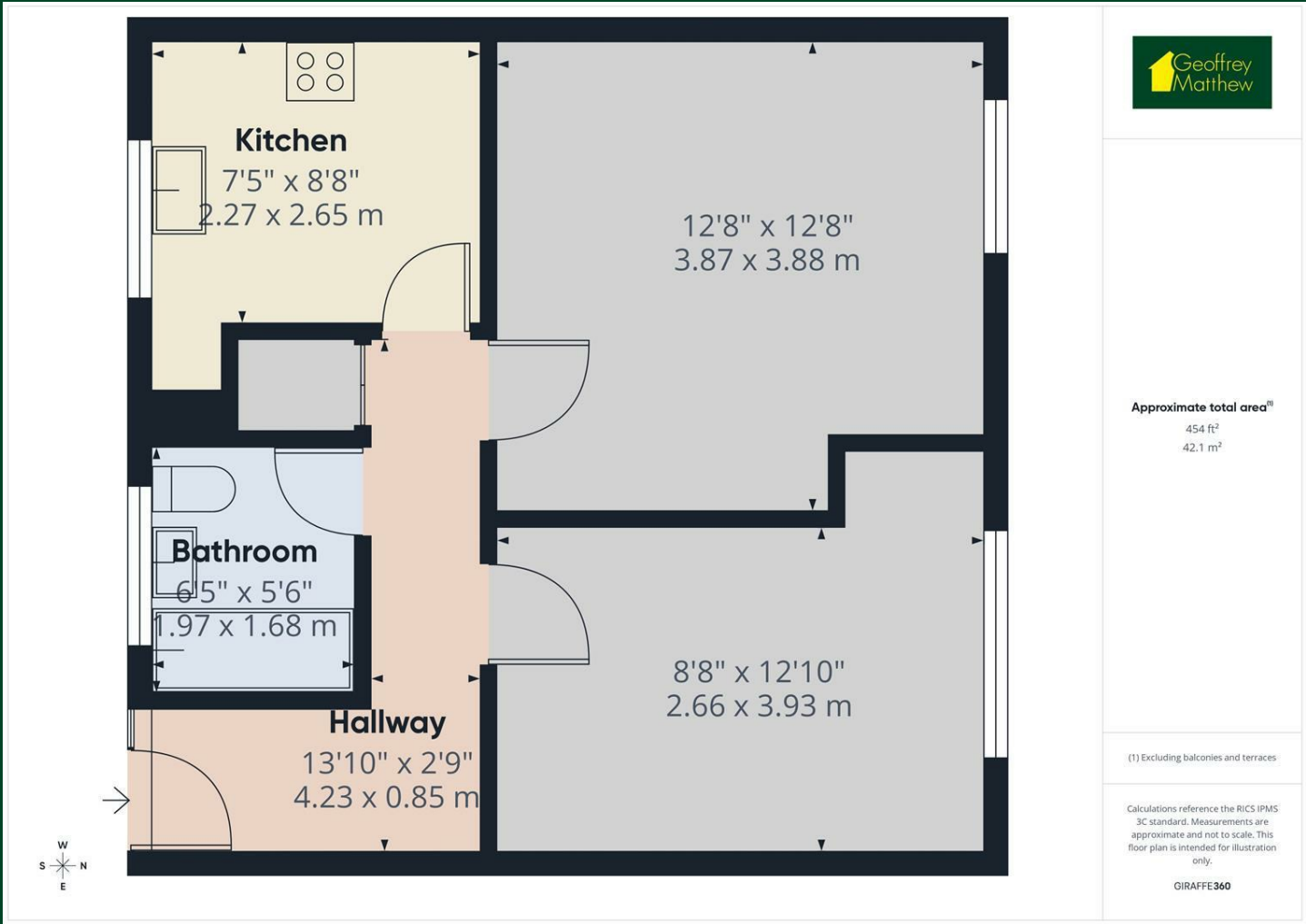

Council Tax Details

Stevenage Borough Council Band

These particulars, whilst believed to be accurate are set out as a general outline only for guidance and do not constitute any part of an offer or contract. Intending purchasers should not rely on them as statements of representation of fact, but must satisfy themselves by inspection or otherwise as to their accuracy. No person in this firms employment has the authority to make or give any representation or warranty in respect of the property.

