



Abbeyfields Close, NW10

£300,000

A ground-floor maisonette offering over 500 sq ft of lateral living space. The property is filled with natural light and features a generously sized double bedroom with built-in storage. There is a separate kitchen and reception room, along with a private terrace overlooking the communal gardens. Additional benefits include off-street parking and the property being offered chain-free. Abbeyfields Close would be an ideal purchase for a first-time buyer or an investor.

Just over half a mile from Hanger Lane (Central line) and Park Royal (Piccadilly line) tube stations. Local bus routes include the 226 and there is access to major trunk roads including the A40 and A406 close by.

Features

- One Double Bedroom
- Fully Refurbished
- Maisonette
- Private Terrace
- Communal Garden
- Allocated Parking Space

Abbeyfields Close,
London, NW10

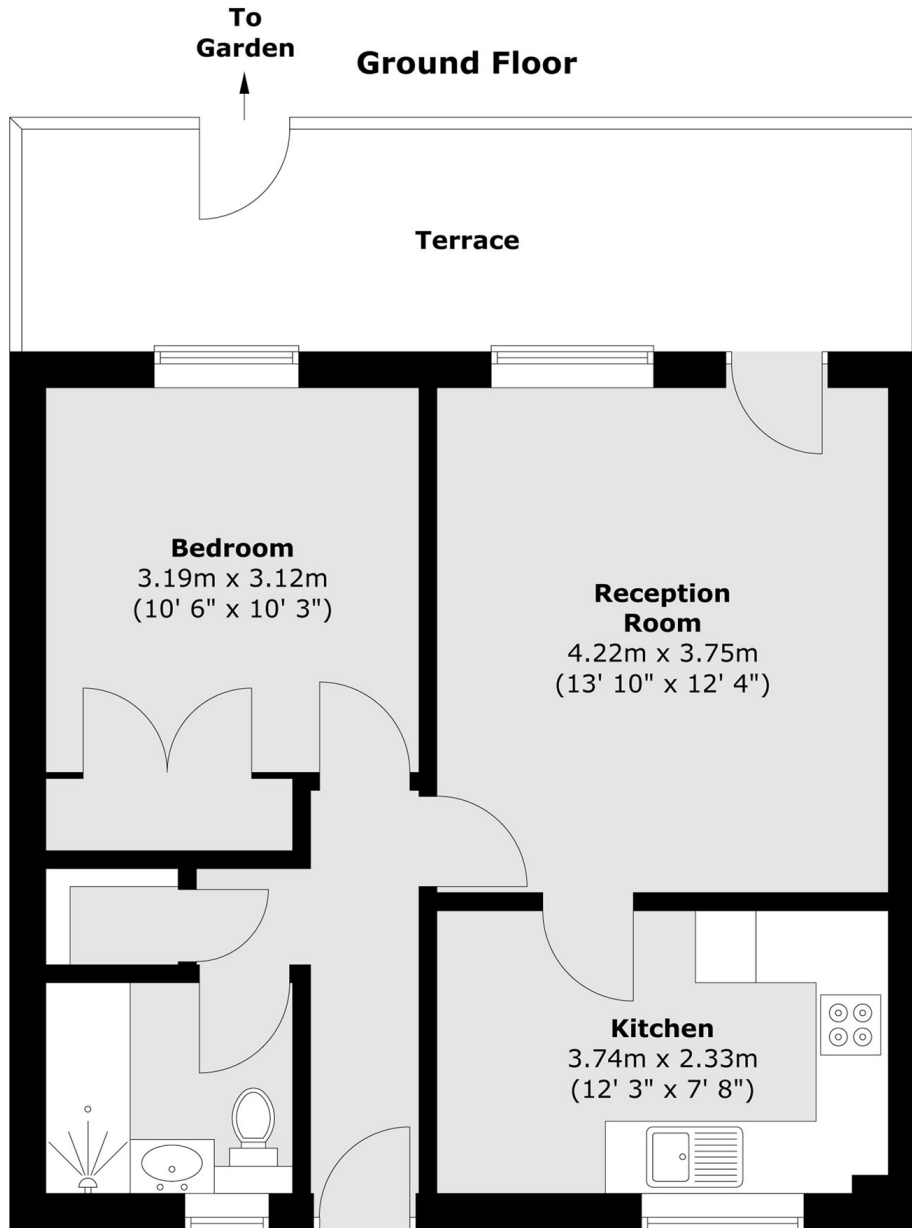

Total area (approx.) : 47.2 sq. m (508 sq. ft)
Total terrace area (approx.) : 14.7 sq. m (158 sq. ft)