



## Russet Way

Peasedown St. John, BA2 8SH

£375,000

Vendors comments - "The house is bright and airy, the garden is a proper suntrap, The double aspect bedroom that was added is a great space. The kitchen and dining room were fabulous for entertaining friends and the conservatory provided even more space. We found the area to be very quiet and friendly."

- No onward sales chain
- Popular location
- Close to Bath
- Ideal proportioned rooms
- Driveway parking
- Single garage

### Viewing

Please contact our Bath Stone Property (MSN) Office on 01761 360144

if you wish to arrange a viewing appointment for this property or require further information.



4



1



4



C

# Floor Plan

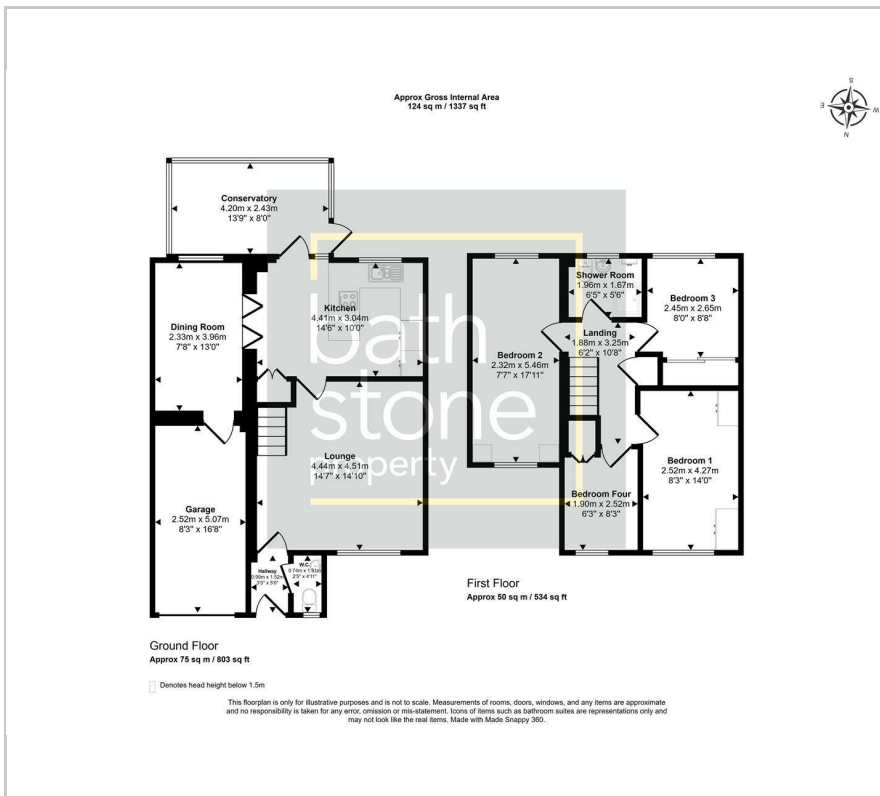

# Energy Efficiency Graph

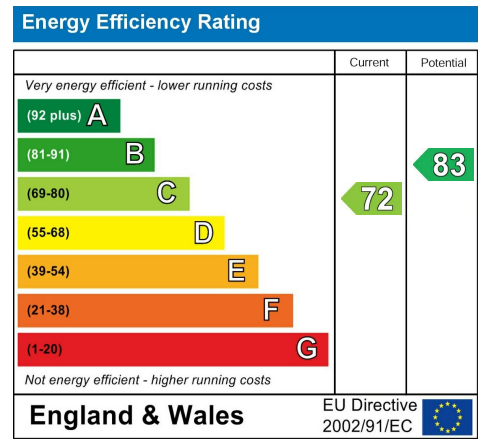

Please give us Feedback



These particulars, whilst believed to be accurate are set out as a general outline only for guidance and do not constitute any part of an offer or contract. Intending purchasers should not rely on them as statements of representation of fact, but must satisfy themselves by inspection or otherwise as to their accuracy. No person in this firm's employment has the authority to make or give any representation or warranty in respect of the property.