



The Downs, Harlow, CM20 3RH
£290,000

2 1 1 C

A set of icons representing property features: a bed icon, a bathtub icon, a sofa icon, and a lightbulb icon. The numbers 2, 1, 1, and C are placed next to the bed, bathtub, sofa, and lightbulb icons respectively.

The Downs, Harlow, CM20 3RH

Offered with NO CHAIN is this two double bedroom family home located in the popular CM20 area, with a west facing rear garden. On the ground floor there is an entrance hallway leading to a large lounge/diner, a kitchen with a range of fitted wall and base units and a utility room, whilst upstairs there are two double bedrooms and a family bathroom with a three piece suite. Outside, the rear garden is mainly laid to lawn with a patio area and a shed. The Downs is ideally located within walking distance of excellent local schools, Harlow Town Centre and open fields.

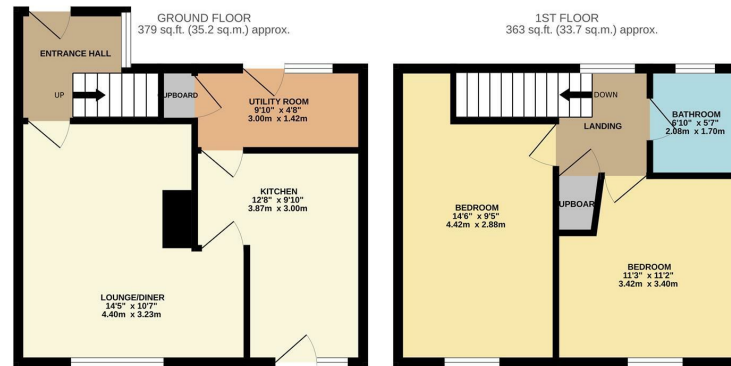

TDIREYLANDJOHNSON
 TOTAL FLOOR AREA: 742 sq.ft. (69.0 sq.m.) approx.
 Whilst every attempt has been made to ensure the accuracy of the floorplan contained here, measurements of doors, windows, rooms and any other items are approximate and no responsibility is taken for any error, omission or mis-statement. This plan is for illustrative purposes only and should be used as such by any prospective purchaser. The services, systems and appliances shown have not been tested and no guarantee as to their operability or efficiency can be given.
 Made with Metropix ©2026



Energy Efficiency Rating		
	Current	Potential
Very energy efficient - lower running costs		
(92 plus) A		
(81-91) B		
(69-80) C		
(55-68) D		
(39-54) E		
(21-38) F		
(1-20) G		
Not energy efficient - higher running costs		
England & Wales	EU Directive 2002/91/EC	EU Directive 2002/91/EC

Environmental Impact (CO ₂) Rating		
	Current	Potential
Very environmentally friendly - lower CO ₂ emissions		
(92 plus) A		
(81-91) B		
(69-80) C		
(55-68) D		
(39-54) E		
(21-38) F		
(1-20) G		
Not environmentally friendly - higher CO ₂ emissions		
England & Wales	EU Directive 2002/91/EC	EU Directive 2002/91/EC

These particulars, whilst believed to be accurate are set out as a general outline only for guidance and do not constitute any part of an offer or contract. Intending purchasers should not rely on them as statements of representation of fact, but must satisfy themselves by inspection or otherwise as to their accuracy. No person in this firm's employment has the authority to make or give any representation or warranty in respect of the property.

T. 01279 216216 E. info@rjestateagents.co.uk

1 Acorn Mews, Harlow, Essex, CM18 6NA www.rjestateagents.co.uk