



SUTHERLAND STREET, SW1V

£480,000

One bedroom
Private garden
Share of freehold
Pimlico grid
Recently renovated
Energy rating: c

@marshandparsons
marshandparsons.co.uk

MARSH &
PARSONS



ABOUT THE PROPERTY

A beautifully presented one bedroom apartment with its own private oasis in the heart of the Pimlico Grid. This immaculate property has been thoughtfully renovated and is ready for the next owner to move straight in.

Featuring a modern open-plan kitchen/living area, a bright double bedroom, and a private, tranquil rear garden. This period-converted home offers luxury finishes, high ceilings, and easy access to Victoria/Sloane Square transport links.

Sutherland Street is exceptionally well-placed, sitting equidistant to Sloane Square (0.8 miles), Victoria Station (0.6 miles), and Pimlico.



STEP INSIDE SUTHERLAND STREET

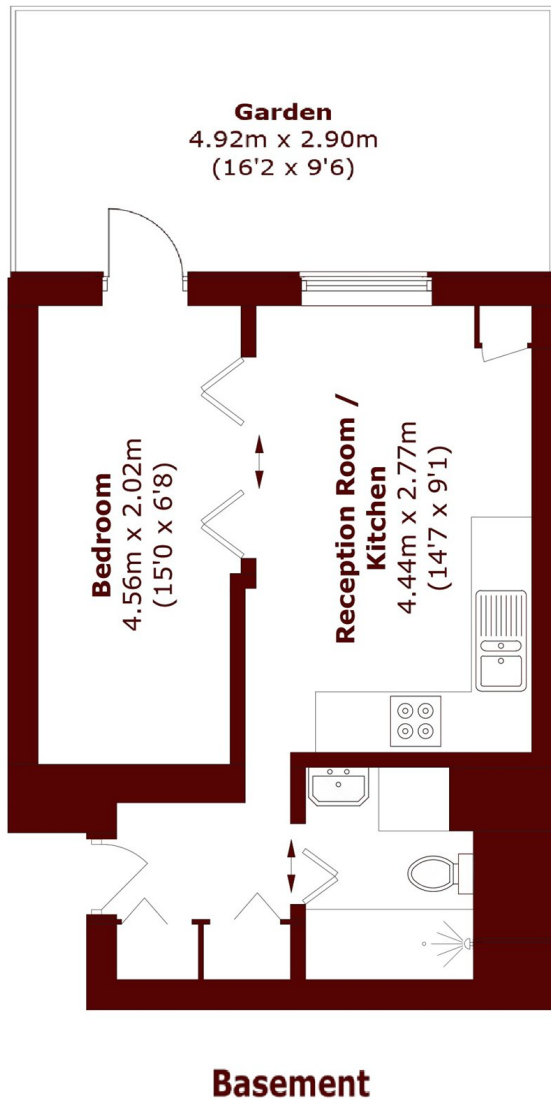

Total area (approx.): 30.1 sq. m (323.9 sq. ft)

Pimlico & Westminster
020 7590 0800

Energy Rating: C We aim to make our particulars both accurate and reliable. However, they are not guaranteed; nor do they form part of an offer or contract. If you require clarification on any points then please contact us, especially if you're traveling some distance to view. Please note that appliances and heating systems have not been tested and therefore no warranties can be given as to their good working order

MARSH &
PARSONS