

APARTMENT 3, 48 BANKS ROAD, SANDBANKS, POOLE, BH13 7QF

OFFERS OVER £675,000



## 48 BANKS ROAD, SANDBANKS, BH13 7QF

OFFERS OVER £675,000

- Chain Free- contemporary 2-bedroom apartment
- Stylish open-plan kitchen and living area with balconies
- Designer Poggen Pohl kitchen with integrated appliances
- Principal bedroom with luxury en-suite
- Underfloor heating and recessed LED lighting
- Secure gated development with allocated parking
- Beautiful family bathroom with bathtub
- Short walk to Sandbanks Beach and Poole Harbour

The apartment is part of a modern development that exudes quality and exclusivity. From the moment you enter, you're greeted by light filled open spaces, clean lines, and high-specification finishes throughout. Floor-to-ceiling windows frame tranquil treetop views, while the open-plan kitchen and living area flow seamlessly onto a private balcony.

Both bedrooms are spacious and beautifully appointed, with the principal suite featuring a luxurious en-suite bathroom and private balcony access. Every detail, from the designer Poggen Pohl kitchen to the contemporary bathroom fittings by Hans Grohe and Antonio Lupi, has been carefully chosen to enhance comfort and style.

Residents benefit from secure gated grounds, allocated parking, and video entry access, ensuring both privacy and peace of mind. The apartment is ideal as a permanent home, a lock-up-and-leave retreat, or an exceptional investment in one of the UK's most sought-after coastal locations.

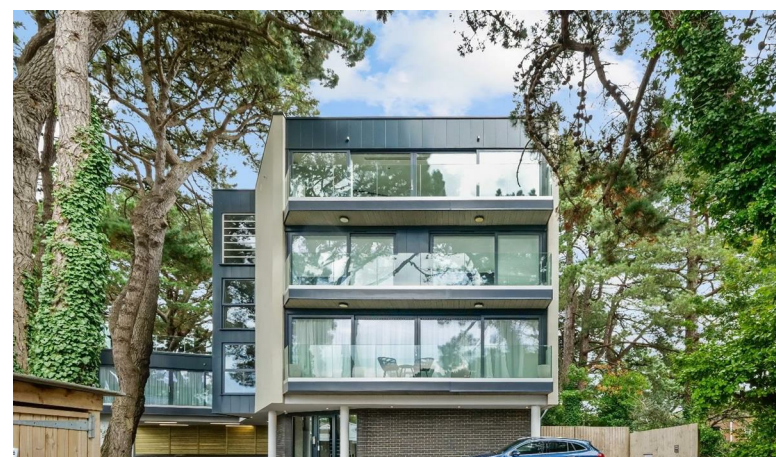

## FLOOR PLANS

### Apt 3, 48 Banks Rd, Sandbanks, Poole, Dorset. Bh13 7QF

Approximate Gross Internal Area  
850 sq ft - 79 sq m

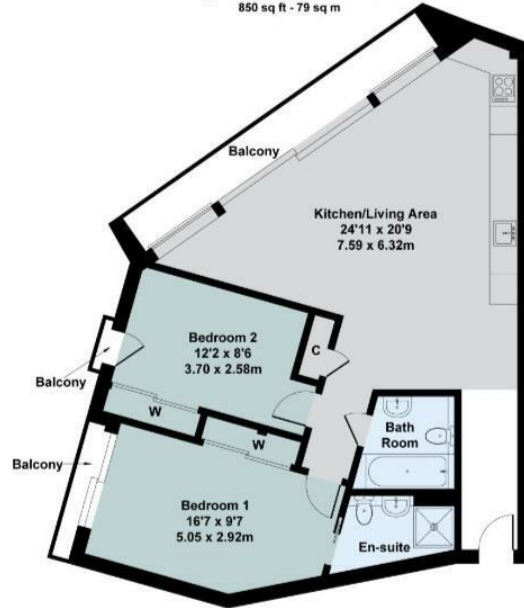

Not to Scale. Produced by The Plan Portal 2025  
For Illustrative Purposes Only.



AGENTS NOTES: EVERY ATTEMPT HAS BEEN MADE TO ENSURE ACCURACY, HOWEVER THESE PROPERTY PARTICULARS ARE APPROXIMATE AND FOR ILLUSTRATIVE PURPOSES ONLY. THEY HAVE BEEN PREPARED IN GOOD FAITH AND THEY ARE NOT INTENDED TO CONSTITUTE PART OF AN OFFER OF CONTRACT. WE HAVE NOT CARRIED OUT A STRUCTURAL SURVEY AND THE SERVICES, APPLIANCES AND SPECIFIC FITTINGS HAVE NOT BEEN TESTED. ALL PHOTOGRAPHS, MEASUREMENTS, FLOOR PLANS AND DISTANCES REFERRED TO ARE GIVEN AS A GUIDE ONLY AND SHOULD NOT BE RELIED UPON FOR THE PURCHASE OF ANY FIXTURE OR FITTINGS. LEASE DETAILS, SERVICE CHARGES AND GROUND RENT (WHERE APPLICABLE) ARE GIVEN AS A GUIDE ONLY AND SHOULD BE CHECKED PRIOR TO AGREEING A SALE. PRINTED 08/04/2025. REGISTERED IN ENGLAND & WALES - COMPANY REG NUMBER: 08974309 REGISTERED ADDRESS: 4 BRACKLEY CLOSE, BOURNEMOUTH INTERNATIONAL AIRPORT, CHRISTCHURCH, DORSET, BH23 6SE. COPYRIGHT © TAILOR MADE ESTATE AGENTS LTD

Energy Efficiency Rating		Current	Potential
100-91	A	83	83
90-81	B		
80-69	C		
55-49	D		
49-41	E		
40-35	F		
35-1	G		

England, Scotland & Wales  
EU Directive 2002/91/EC

## AREA MAP

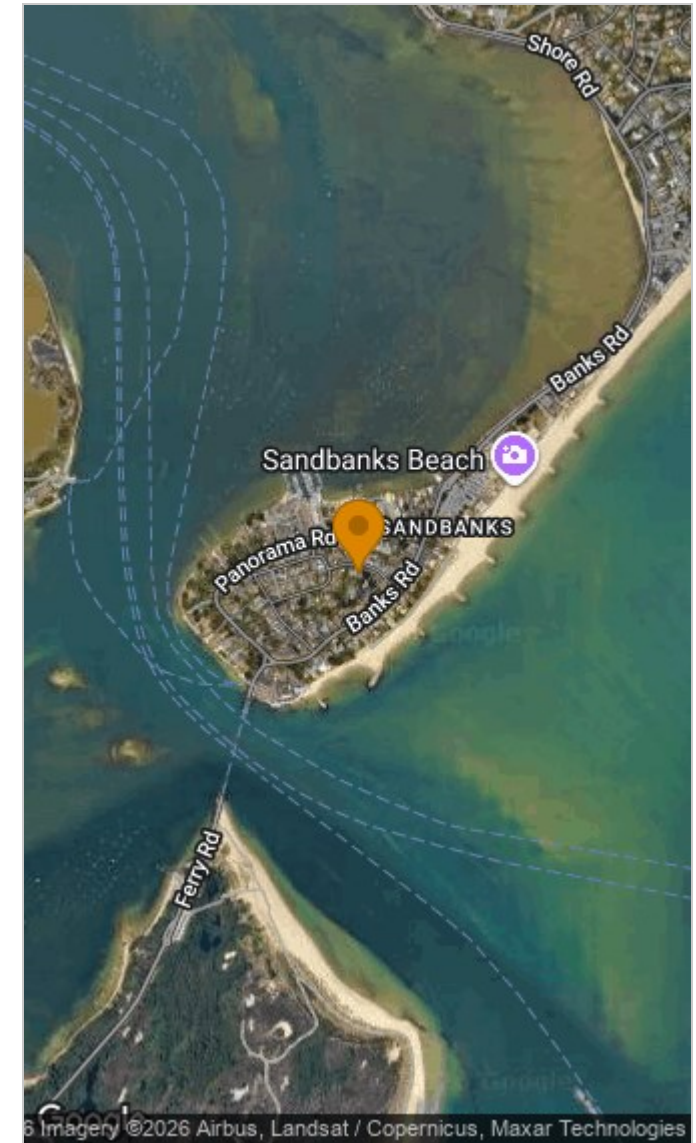

These particulars, whilst believed to be accurate are set out as a general outline only for guidance and do not constitute any part of an offer or contract. Intending purchasers should not rely on them as statements of representation of fact, but must satisfy themselves by inspection or otherwise as to their accuracy. No person in this firm's employment has the authority to make or give any representation or warranty in respect of the property.