

Whilst every attempt has been made to ensure the accuracy of the floorplan contained here, measurements of doors, windows, rooms and other items are approximate and no responsibility is taken for any error. The floorplan is for illustrative purposes only and should be used as such by any prospective purchaser. The services, fixtures and appliances shown have not been measured and no guarantee as to their operation or efficiency can be given. Made with Metropix ©2025

England & Wales	
EU Directive 2002/91/EC	
Very energy efficient - lower running costs	(92 plus) A
	(81-91) B
	(69-80) C
	(55-68) D
	(39-54) E
	(21-38) F
Not energy efficient - higher running costs	(1-20) G
Current	67
Potential	80

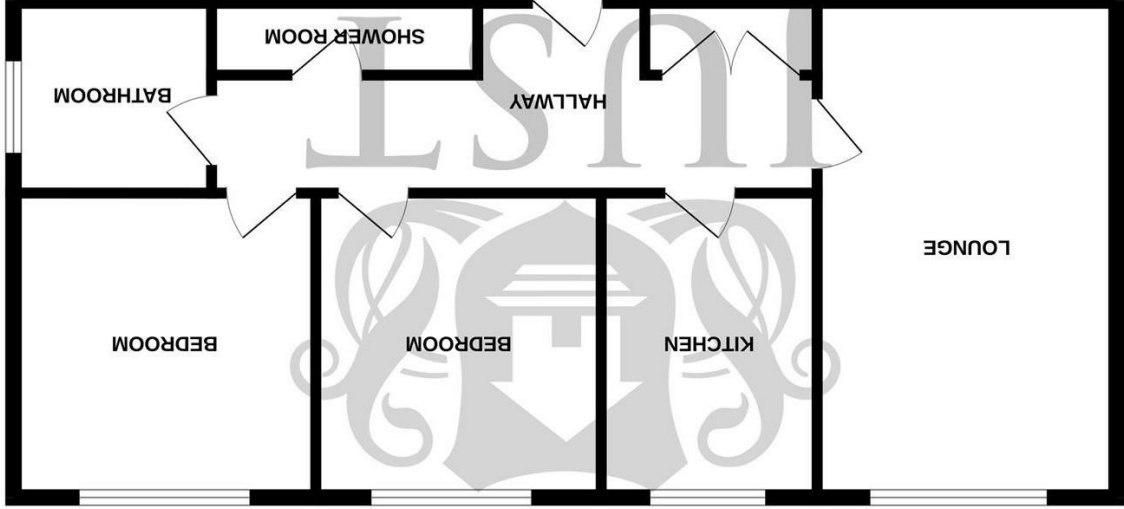

SECOND FLOOR



Flat 18 Dorset House 6 Hastings Road, Bexhill-On-Sea, TN40 2FR

FLOORPLANS

www.justproperty.net

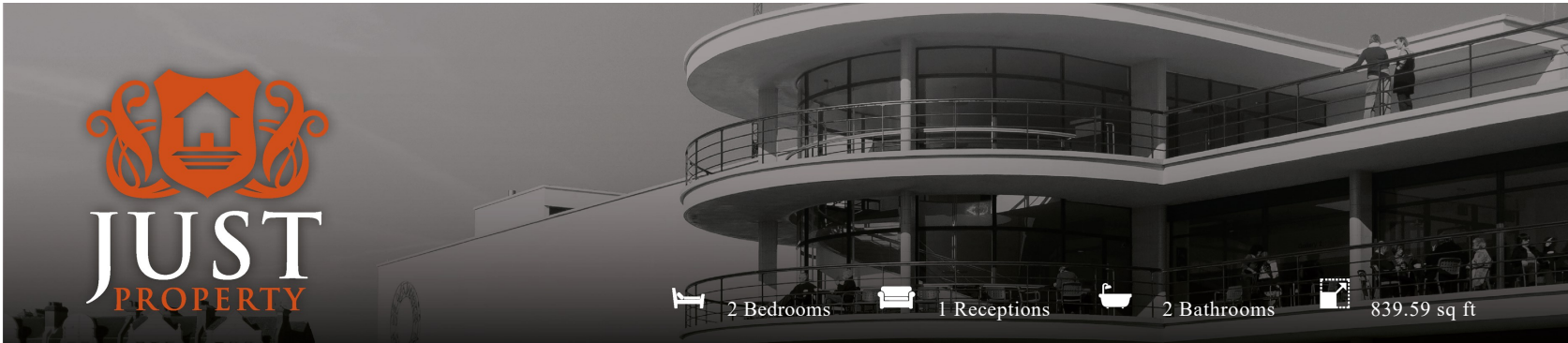

2 Bedrooms 1 Receptions 2 Bathrooms 839.59 sq ft

Leasehold - Share of Freehold

£260,000

Flat 18 Dorset House 6 Hastings Road, Bexhill-On-Sea, TN40 2FR





Leasehold - Share of Freehold

£260,000

2 Bedrooms 1 Receptions 2 Bathrooms 839.59 sq ft

PROPERTY DETAILS

Located on Hastings Road in the charming town of Bexhill-on-Sea, this immaculately presented purpose-built flat offers a delightful living experience. Spanning an impressive 840 square feet, the property boasts two well-appointed bedrooms, making it an ideal choice for couples or small families seeking comfort and style.

Upon entering, you will be greeted by a warm and inviting atmosphere, enhanced by the thoughtful design and modern finishes throughout. The property features two contemporary shower rooms, ensuring convenience for residents and guests alike.

One of the standout features of this property is the lift access, providing easy access to all levels and making it suitable for individuals of all ages. The attractive communal gardens surrounding the building offer a serene outdoor space, perfect for relaxation or socialising with neighbours.

This property not only provides a comfortable home but also a wonderful community feel, set in a desirable location close to the amenities of Bexhill-on-Sea. With its blend of modern living and charming surroundings, this flat is a must-see for anyone looking to enjoy the best of coastal living.



ROOM DIMENSIONS

Stairs / Lift up to Second Floor

Property Front Door

Entrance Hallway

Kitchen / Diner
12'8" x 7'11" (3.879 x 2.415)

Lounge
20'11" x 11'10" (6.380 x 3.622)

Bedroom
12'8" x 10'4" (3.879 x 3.163)

Bathroom / W.C
7'11" x 6'3" (2.415 x 1.907)

Shower Room / W.C

Abundance Of Storage

Communal Gardens To The Rear

FEATURES

- Two Bedroom Immaculately Presented Flat
- Second Floor With Both Staircase And Lift Access
- Highly Desirable Location Within Bexhill
- Close To Transport Links
- The Benefit Of Two Shower Rooms / W.C
- Attractive Communal Gardens To The Rear
- Viewing Considered Essential Via Just Property
- Call Just Property on 01424 444 100
- Council Tax Band - C

