

The Estate Agent People Recommend



25 St Swithins Court Polehampton Close,
Twyford
RG10 9RP

Price guide £249,500



Welcome to this superbly improved ground floor flat located in the charming village of Twyford. Situated in the desirable Polehampton Close, this modern apartment, built in 1987, offers a perfect blend of comfort and convenience.

As you enter into the hall you will be greeted by a spacious double aspect reception room that provides a warm and inviting atmosphere, ideal for relaxation or entertaining guests. The flat features a well-appointed bedroom, ensuring a peaceful retreat at the end of the day. The newly renovated bathroom is a standout feature, complete with a full-size bath and a high-pressure shower, perfect for unwinding after a long day.

The kitchen is equipped with modern appliances, making it a delightful space for culinary enthusiasts. Throughout the flat, you will find stylish Woodpecker flooring that adds a touch of elegance and is easy to maintain. The new Dimplex electric radiators ensure that the flat remains cosy and warm during the colder months.

Situated in the heart of the village, this property benefits from residents' parking, providing convenience for both you and your guests. The location offers easy access to local amenities, shops, and station on the Elizabeth line making it an ideal choice for those seeking a vibrant community atmosphere.

This ground floor flat is perfect for first-time buyers, professionals, or those looking to downsize. With its modern features and prime location, it presents an excellent opportunity to enjoy comfortable living in Twyford. Do not miss the chance to make this delightful property your new home. NO ONWARD CHAIN.

EPC rating D
Council tax band C
Leasehold with 960 years remaining.

GROUND FLOOR
437 sq.ft. (40.6 sq.m.) approx.

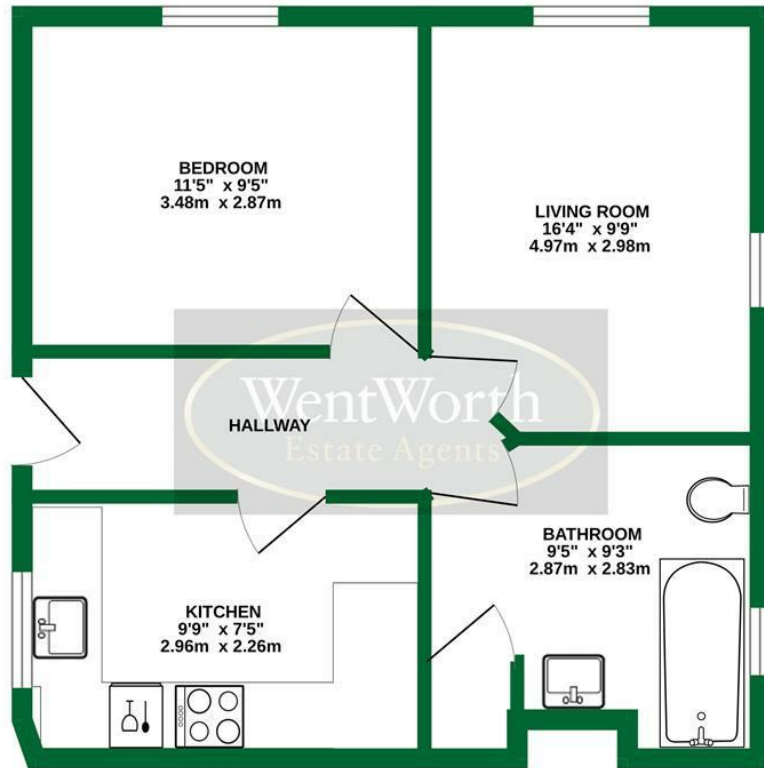

TOTAL FLOOR AREA : 437 sq.ft. (40.6 sq.m.) approx.

Whilst every attempt has been made to ensure the accuracy of the floorplan contained here, measurements of doors, windows, rooms and any other items are approximate and no responsibility is taken for any error, omission or mis-statement. This plan is for illustrative purposes only and should be used as such by any prospective purchaser. The services, systems and appliances shown have not been tested and no guarantee as to their operability or efficiency can be given.
Made with Memopak ©2025

ACCOMMODATION

- SUPERB IMPROVED GROUND FLOOR FLAT
- NEW BATHROOM WITH FULL SIZE BATH AND HIGH PRESSURE SHOWER
- WREN KITCHEN WITH INTERGRATED APPLIANCES
- CENTRAL LOCATION WITH RESIDENTS PARKING
- EASY ACCESS TO RAILWAY STATION
- LEASEHOLD WITH 960 YEARS REMAINING
- ANNUAL SERVICE CHARGE £1380.00
- ANNUAL GROUND RENT CHARGE £188.36
- NO ONWARD CHAIN

