

Bermuda Way, E1

£3,150 Per calendar month

A three double bedroom apartment located on the second floor of Hierro Court. With a large open plan living, kitchen area and private balcony. Ideal for professional sharers wanting to be close to the City.

Bermuda Way is within walking distance to the shops, bars and restaurants of Limehouse Docklands Light Rail.

Features

- Three Double Bedrooms
- Furnished
- Balcony
- One Bathroom
- Great Location
- Communal Gardens

Bermuda Way, London, E1

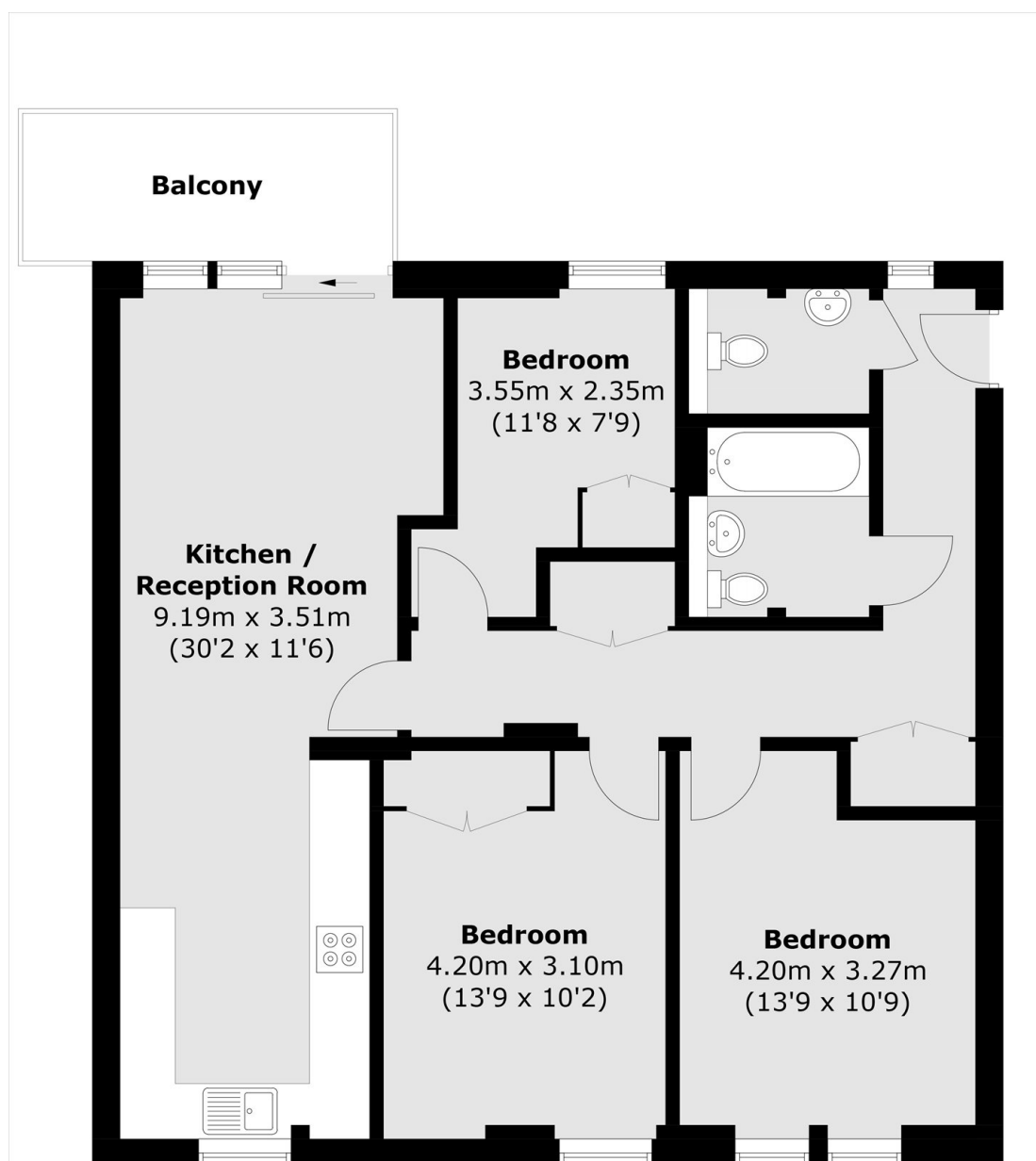

Total area (approx.): 85.4 sq. m (919.2 sq. ft)
Balcony: 6.4 sq. m (68.9 sq. ft)