



Ivy Road, NW2 £3,100 Per Month

A beautifully presented three-bedroom ground floor apartment with high ceilings, generous living space and a contemporary finish. Featuring a private entrance, bright reception room with bi-fold doors opening onto a private garden, modern kitchen and bathroom, and three spacious double bedrooms. Ideally located close to Gladstone Park, Cricklewood Station and excellent local amenities.

- Stylish three-bedroom ground floor apartment.
- Light-filled reception with bi-fold doors.
- Contemporary interiors with high ceilings.
- Private garden with seamless indoor-outdoor living.
- Moments from Gladstone Park and Cricklewood Station.
- Deposit: £3,576.00
- Council tax: D



020 8450 9377 - 020 8459 1133
rentals@cameronsstiff.co.uk

Ivy Road, NW2

Approximate Area = 70.2 sq m / 755 sq ft

For Identification only - Not to Scale



EPC: C
Ref: 19791611

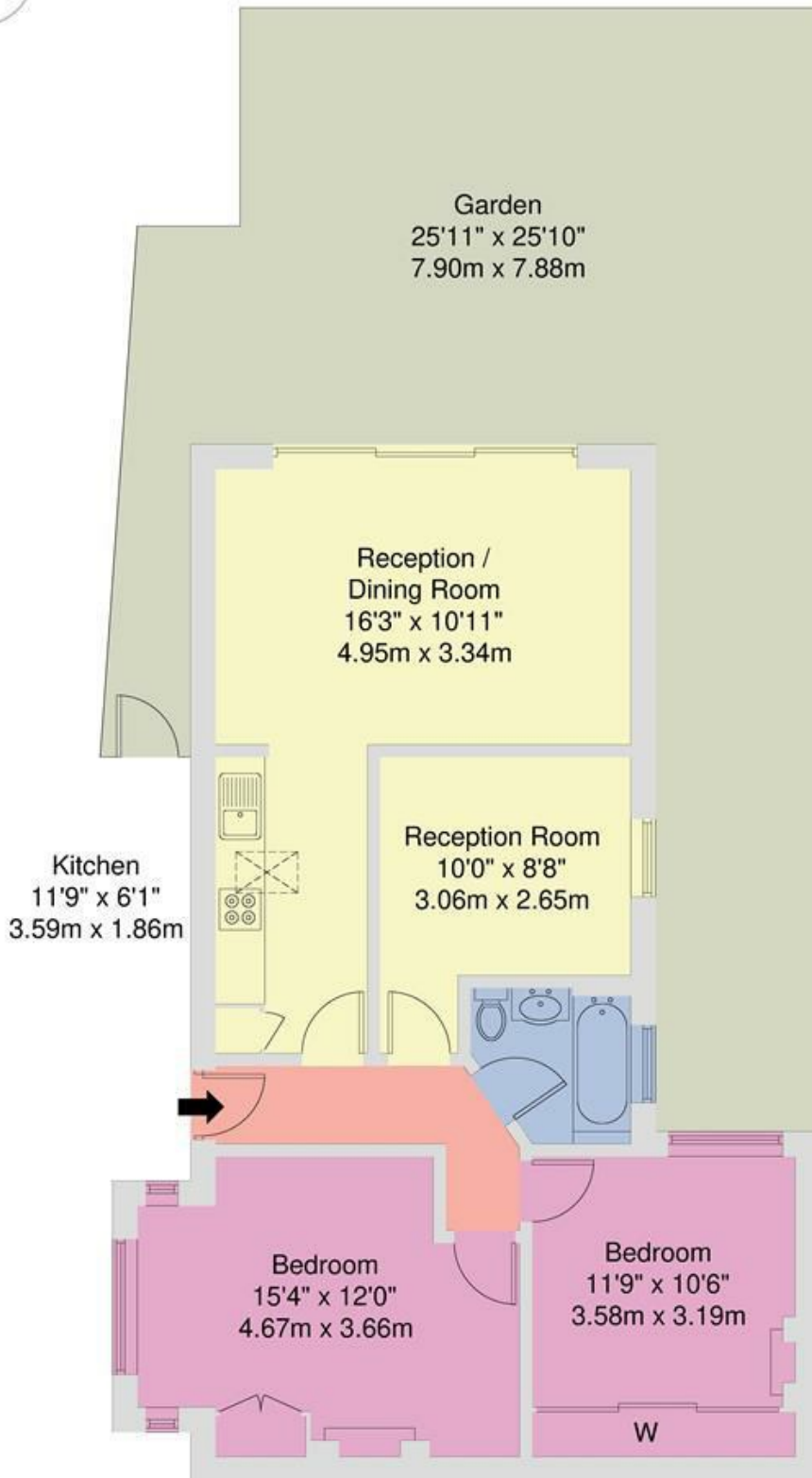

GROUND FLOOR

Disclaimer : Floorplan measurements are approximate and are for illustrative purposes only. While we do not doubt the floorplan accuracy and completeness, you or your advisors should conduct a careful, independent investigation of the property in respect of monetary valuation.

