



WIMBLEDON HILL ROAD, SW19

£395,000

A larger than average one double bedroom, purpose built apartment in the heart of Wimbledon. The property offers a separate kitchen and living room and is being sold chain free.

Purpose built development
One double bedroom
Separate kitchen

Good location
Chain free
Energy rating: d

STEP INSIDE

WIMBLEDON HILL ROAD

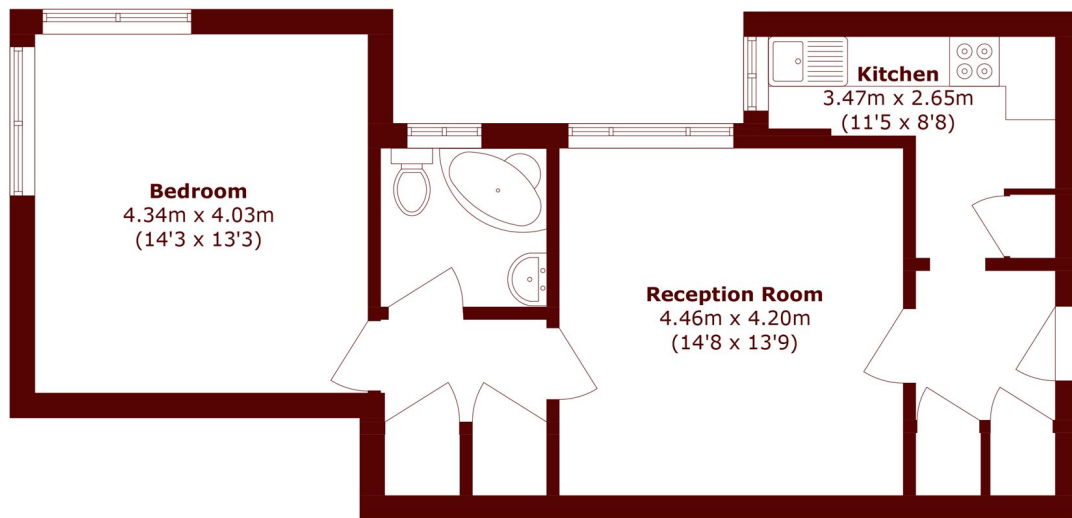

Total area (approx.): 56.8 sq. m (611.4 sq. ft)

Wimbledon
020 8879 6660

Energy Rating: D We aim to make our particulars both accurate and reliable. However, they are not guaranteed; nor do they form part of an offer or contract. If you require clarification on any points then please contact us, especially if you're traveling some distance to view. Please note that appliances and heating systems have not been tested and therefore no warranties can be given as to their good working order

MARSH &
PARSONS