



Shelford Close

Northampton,

oriordanbond
SALES & LETTINGS



GROUND FLOOR



1ST FLOOR

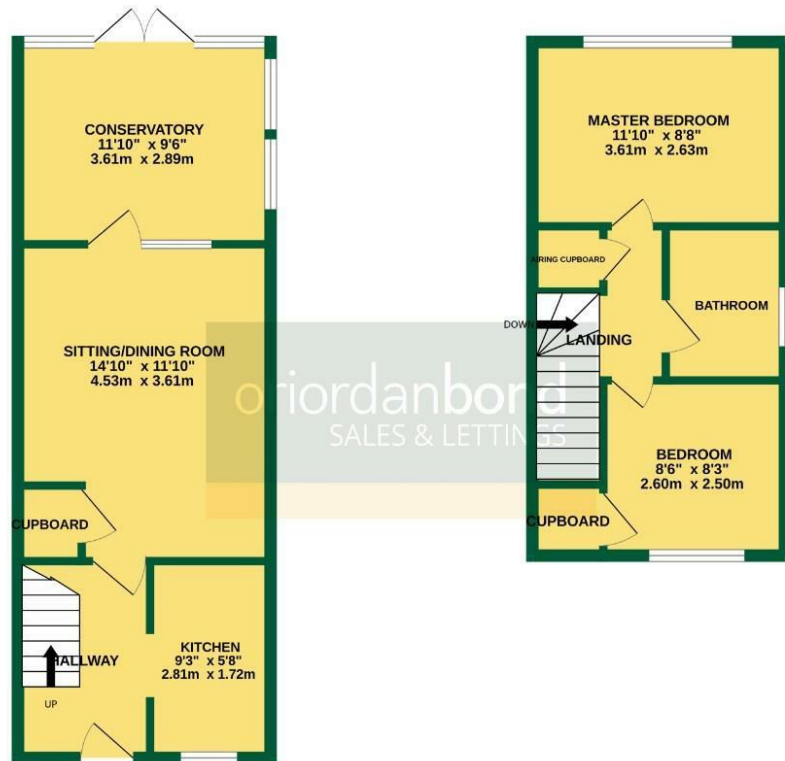

TOTAL FLOOR AREA: 721 sq. ft. (67.0 sq. m.) approx.
 Whilst every attempt has been made to ensure the accuracy of the floorplan contained here, measurements of doors, windows, rooms and any other items are approximate and no responsibility is taken for any error, omission or misstatement. This plan is for illustrative purposes only and should be used as such by any prospective purchaser. The services, systems and appliances shown have not been tested and no guarantee as to their operability or efficiency can be given.
 Made with Metropex CC002.

Shelford Close

Northampton
 NN3 8UF

PRICE £219,995

Offered for sale is this well presented two bedroom semi detached property located within walking distance to Northampton Academy, local primary school and Weston Favell Shopping Centre. Further benefits include gas radiator heating and newly installed uPVC double glazing

The accommodation comprises entrance hall, fitted kitchen, sitting/dining room and conservatory. The first floor offers two bedrooms and a newly refitted family bathroom. Outside is an enclosed garden to the rear with private off road parking. Further benefits include uPVC double glazed windows and gas radiator heating

Additional information

- Council Tax Band: B
- Energy Efficiency Rating: C

Viewing

Viewing strictly by appointment – details below

Disclaimer

O'Riordan Bond Estate Agents Limited has not tested apparatus, equipment, fittings or services and so cannot verify they are in working order. The buyer is advised to obtain verification from their solicitor or surveyor.

O'Riordan Bond Weston Favell Sales
 01604 784007

westonfavell@oriordanbond.co.uk

