





**£225,000**

Situated in Far Bletchley is this two bedroom terraced home. The property offers a lounge, kitchen/diner, two bedrooms, bathroom and a rear garden. Further benefits include off-road parking. The property is being offered to the market with no upper chain.

# Property Description

## **ENTRANCE**

Double glazed door to:

## **ENTRANCE HALL**

Door to:

## **LOUNGE**

Double glazed window to front aspect. Stairs rising to first floor, radiator, gas feature fireplace, door to kitchen/diner.

## **KITCHEN/DINER**

Double glazed window and door to rear. Fitted with a range of wall-mounted and base units with rolled edge work surface over, space for cooker, washing machine, fridge freezer, and tumble dryer; stainless steel sink with mixer tap, part tiled walls, wall-mounted boiler, radiator, extractor hood.

## **LANDING**

Doors to bedrooms and bathroom, loft access.

## **BEDROOM ONE**

Double glazed bay window to front aspect. Radiator, storage cupboard.

## **BEDROOM TWO**

Double glazed window to rear aspect. Radiator.

## **BATHROOM**

Double glazed frosted window to rear aspect. Low level WC, wash hand basin with mixer tap, radiator, panelled bath with shower attachment over, tiled walls.

## **OUTSIDE**

### **PARKING**

Off-road parking.

### **FRONT GARDEN**

Laid to lawn with path to front door, shrub borders.

### **REAR GARDEN**

Laid to lawn with patio area, rear gated access.

GROUND FLOOR  
284 sq.ft. (26.4 sq.m.) approx.

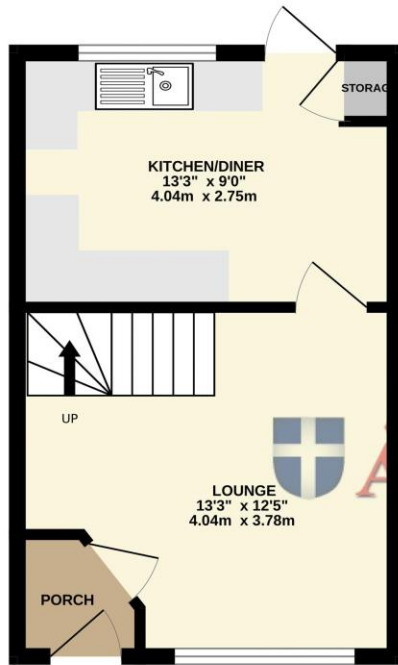

1ST FLOOR  
293 sq.ft. (27.2 sq.m.) approx.

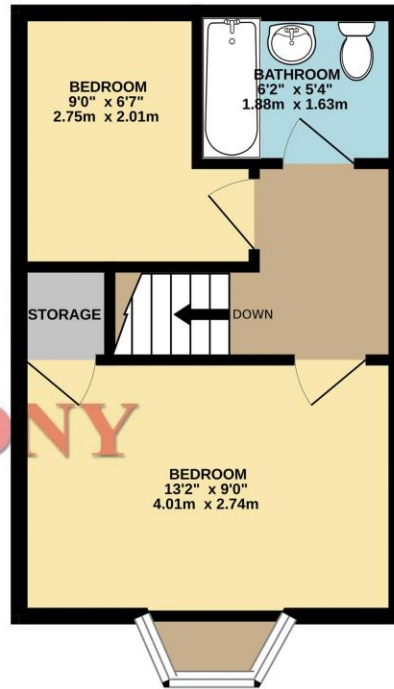

Michael  
ANTHONY

TOTAL FLOOR AREA: 577 sq.ft. (53.6 sq.m.) approx.

Whilst every attempt has been made to ensure the accuracy of the floorplan contained here, measurements of doors, windows, rooms and any other items are approximate and no responsibility is taken for any error, omission or mis-statement. This plan is for illustrative purposes only and should be used as such by any prospective purchaser. The services, systems and appliances shown have not been tested and no guarantee as to their operability or efficiency can be given.  
Made with Metropix ©2026

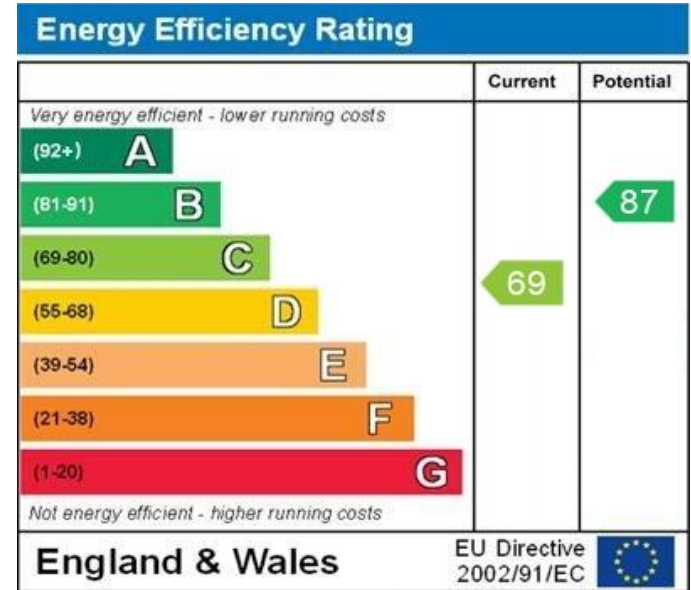

WWW.EPC4U.COM

MONEY LAUNDERING REGULATIONS 2017 intending purchasers will be asked to produce identification and proof of financial status when an offer is received. We would ask for your co-operation in order that there will be no delay in agreeing the sale.

THE CONSUMER PROTECTION REGULATIONS 2008 The Agent has not tested any apparatus, equipment, fixtures and fittings or services and so cannot verify that they are in working order or fit for the purpose. A Buyer is advised to obtain verification from their Solicitor or Surveyor. References to the Tenure of a Property are based on information supplied by the Seller. The Agent has not had sight of the title documents. A Buyer is advised to obtain verification from their Solicitor. You are advised to check the availability of this property before travelling any distance to view. We have taken every precaution to ensure that these details are accurate and not misleading. If there is any point which is of particular importance to you, please contact us and we will provide any information you require. This is advisable, particularly if you intend to travel some distance to view the property. The mention of any appliances and services within these details does not imply that they are in full and efficient working order. These particulars are in draft form awaiting Vendors confirmation of their accuracy. These details must therefore be taken as a guide only and approved details should be requested from the agents

190 Queensway Bletchley Milton Keynes MK2 2ST  
01908 648 666 | bletchley@maea.co.uk