



Greenfields



75 Chelston Road, Ruislip

Ruislip

Guide Price £499,950

75 Chelston Road

Ruislip, Ruislip

Two bedroom semi-detached house on Eastcote and Ruislip Manor borders. In need of modernisation. Scope to extend. Private garden, off-street parking, own drive, and car port.
Council Tax band: D

Tenure: Freehold

EPC Energy Efficiency Rating: D

EPC Environmental Impact Rating:

- Two bedroom Semi-detached house
- In need of modernisation
- Reception room
- Kitchen
- Drive to the side
- Side and rear extension potential (stp)
- Bathroom
- Off-street parking



Greenfields

GROUND FLOOR

APPROX. 30.6 SQ. METRES (329.2 SQ. FEET)

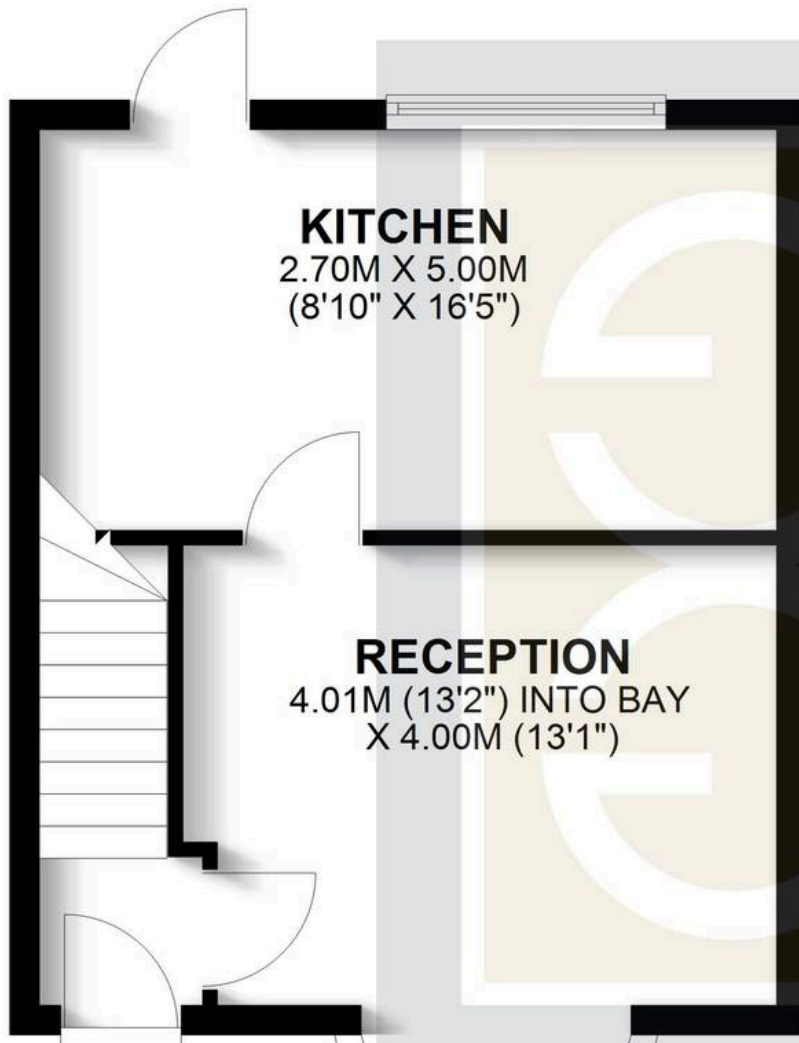

KITCHEN
2.70M X 5.00M
(8'10" X 16'5")

RECEPTION
4.01M (13'2") INTO BAY
X 4.00M (13'1")

FIRST FLOOR

APPROX. 30.4 SQ. METRES (327.3 SQ. FEET)

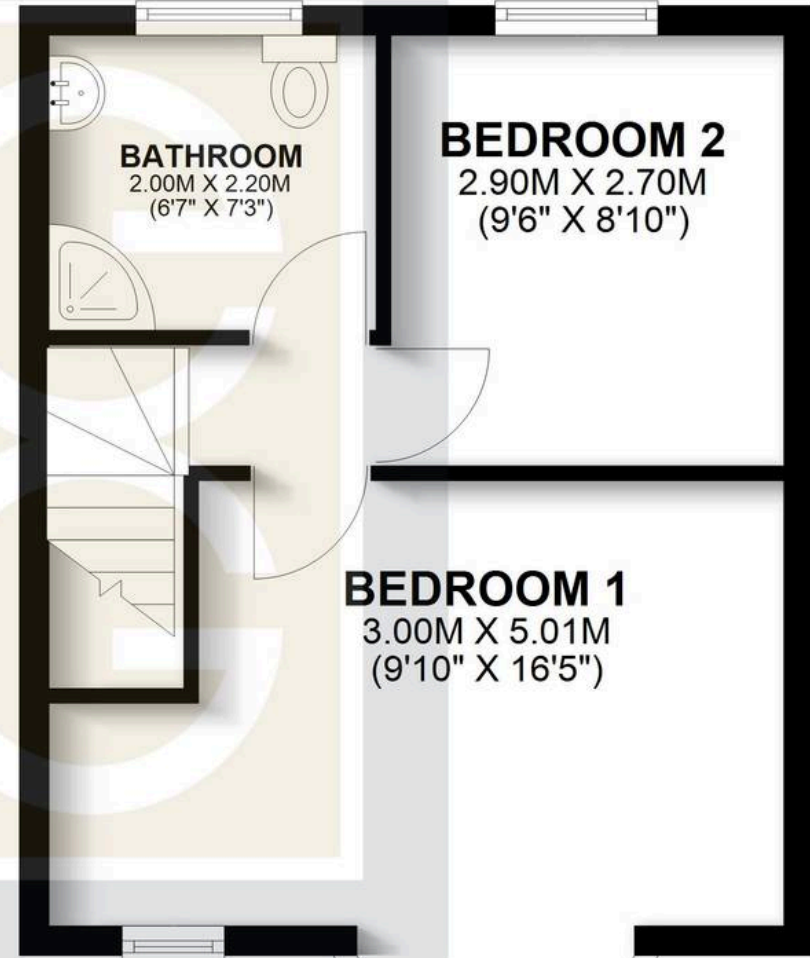

BATHROOM
2.00M X 2.20M
(6'7" X 7'3")

BEDROOM 2
2.90M X 2.70M
(9'6" X 8'10")

BEDROOM 1
3.00M X 5.01M
(9'10" X 16'5")



Greenfields

TOTAL AREA: APPROX. 61.0 SQ. METRES (656.5 SQ. FEET)



Greenfields

115 Victoria Road, Ruislip - HA4 9BN

01895 628560 • info@greenfieldsproperty.co.uk • www.greenfieldsproperty.co.uk

These particulars, whilst believed to be accurate are set out as a general outline only for guidance and do not constitute any part of an offer or contract. Intending purchasers should not rely on them as statements of representation of fact, but must satisfy themselves by inspection or otherwise as to their accuracy.